

# Customer Information Sheet

DRAWING No.: M30-610XX46 SHEET 3 OF 3

IF IN DOUBT - ASK

(C)

NOT TO SCALE

THIRD ANGLE PROJECTION

ALL DIMENSIONS !N mm

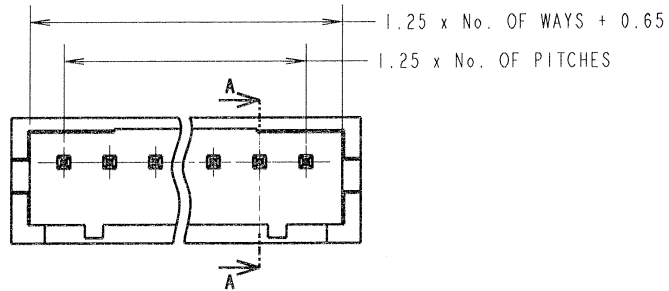
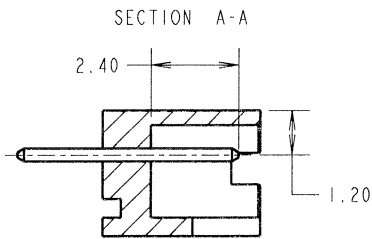

ORDER CODE: **M30-610XX46**  
 No. OF CONTACTS PER ROW: 02 TO 15  
 FINISH: 46 = 100X TIN

**SPECIFICATION:**  
 MATERIAL:  
 MOULDING = POLYAMIDE 46 OR 6T, UL94V-0, NATURAL  
 CONTACTS = BRASS  
 FINISH:  
 CONTACTS = 100X TIN  
 ELECTRICAL:  
 CURRENT RATING = 1A AC/DC  
 VOLTAGE RATING = 150V AC/DC  
 DIELECTRIC STRENGTH = 500V AC  
 INSULATION RESISTANCE = 1,000 MEGOHMS MIN  
 DIELECTRIC WITHSTANDING VOLTAGE = 500V AC  
 ENVIRONMENTAL:  
 TEMPERATURE RANGE = -55°C TO +85°C  
 PACKING:  
 TUBE  
 FOR COMPLETE SPECIFICATIONS, SEE COMPONENT SPECIFICATION C025XX (LATEST ISSUE)

1.25 x No. OF WAYS + 1.65

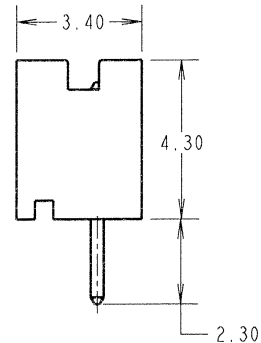
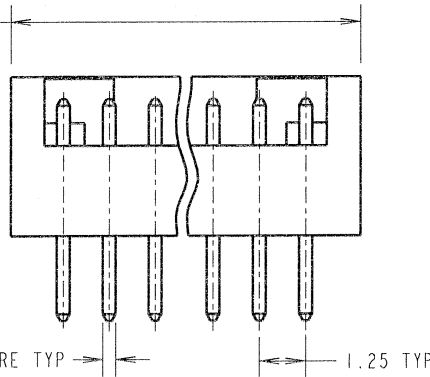

- NOTES:**
- ALL TOLERANCES ARE  $\pm 0.30\text{mm}$  UNLESS OTHERWISE STATED.
  - MATES WITH M30-1000046 CRIMP CONTACTS AND M30-110XX00 CRIMP MOULDING.
  - RECOMMENDED MOUNTING HOLE SIZE =  $\varnothing 0.60 \pm 0.03\text{mm}$ .

JMB	6	23.01.06	8988
NAME	ISS.	DATE	C/NOTE
APPROVED: <i>[Signature]</i>			
CHECKED: <i>[Signature]</i>			
DRAWN: W. BOURNE			
CUSTOMER REF.:			
ASSEMBLY DRG:			

**HARWIN**

THIS DRAWING AND ANY INFORMATION OR DESCRIPTIVE MATTER SET OUT HEREON ARE CONFIDENTIAL AND COPYRIGHT PROPERTY OF THE HARWIN GROUP AND MUST NOT BE DISCLOSED, LOANED, COPIED OR USED FOR MANUFACTURING, TENDERING OR FOR ANY OTHER PURPOSE WITHOUT THEIR WRITTEN PERMISSION.

**TOLERANCES**  
~~X =  $\pm 1\text{mm}$~~   
~~X.X =  $\pm 0.25\text{mm}$~~   
~~X.XX =  $\pm 0.10\text{mm}$~~   
~~X.XXX =  $\pm 0.01\text{mm}$~~   
 ANGLES =  $\pm 5^\circ$   
 UNLESS STATED

**MATERIAL:** SEE ABOVE  
**FINISH:** SEE ABOVE  
**S/AREA:** mm<sup>2</sup>

**TITLE:** 1.25mm PITCH SIL PC TAIL BOARD MOUNT CONNECTOR  
**DRAWING NUMBER:** M30-610XX46  
 SHT 3 OF 3

HARWIN INC U.S.A. TEL: (812) 542 2540 FAX: (812) 542 2541	HARWIN PLC U.K. TEL: 023 9231 4545 FAX: 023 9231 4590	HARWIN PTE SINGAPORE TEL: 65 6779 4909 FAX: 65 6779 3868
--	--	---