

P/N	CONTACT AREA PLATING	PACKAGE METHOD	REMARK
67490-9220	GOLD FLASH	WITHOUT MYLAR	TIN LEAD
67490-9221	0.76 MICRONS GOLD PLATED	TRAY PACKAGE	
67490-9225	0.38 MICRONS GOLD PLATED	PK-67490-001	
67490-9230	GOLD FLASH	WITH MYLAR	
67490-9231	0.76 MICRONS GOLD PLATED	TAPE REEL	
67490-9235	0.38 MICRONS GOLD PLATED	PK-67490-000	
67490-9240	GOLD FLASH	WITH MYLAR	PURE TIN
67490-9241	0.76 MICRONS GOLD PLATED	TUBE PACKAGE	
67490-9245	0.38 MICRONS GOLD PLATED	PK-67490-002	
67490-1220	GOLD FLASH	WITHOUT MYLAR	
67490-1221	0.76 MICRONS GOLD PLATED	TRAY PACKAGE	
67490-1225	0.38 MICRONS GOLD PLATED	PK-67490-001	
67490-1230	GOLD FLASH	WITH MYLAR	PURE TIN
67490-1231	0.76 MICRONS GOLD PLATED	TAPE REEL	
67490-1235	0.38 MICRONS GOLD PLATED	PK-67490-000	
67490-1240	GOLD FLASH	WITH MYLAR	
67490-1241	0.76 MICRONS GOLD PLATED	TUBE PACKAGE	
67490-1245	0.38 MICRONS GOLD PLATED	PK-67490-002	

- NOTES:
- MATERIAL:
HOUSING: HIGH TEMPERATURE THERMAL PLASTIC, GLASS FILLED, UL94V-0, COLOR : BLACK
TERMINAL/FORKLOCK: COPPER ALLOY
MYLAR: ADHESIVE MYLAR 4,5MMX15,5MM
 - TERMINAL PLATING:
CONTACT AREA: GOLD PLATED
SOLDERING TAIL: 1.27 MICRONS MINIMUM TIN-LEAD OR TIN PLATED UNDER PLATE; NICKEL 1.27 MICRONS MINIMUM NICKEL PLATED
 - FORKLOCK PLATING :
1.27 MICRONS MINIMUM TIN-LEAD OR TIN PLATED OVERALL 1.27 MICRONS MINIMUM NICKEL UNDER-PLATED
 - PACKAGING SPECIFICATION REFER TO THAT IN TABLE
 - PRODUCT SPECIFICATION REFER TO PS-67490-001
 - MATING PART: 67538, 67489

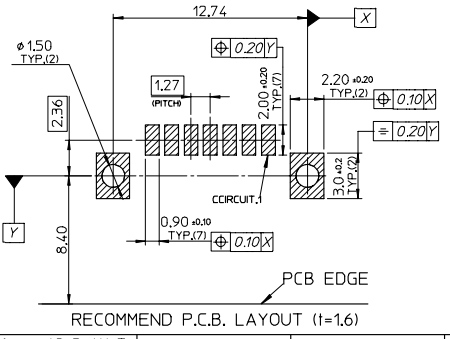
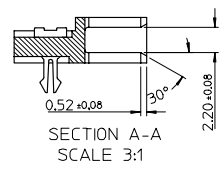
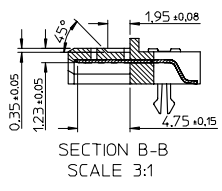
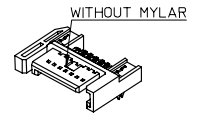
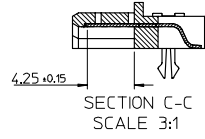
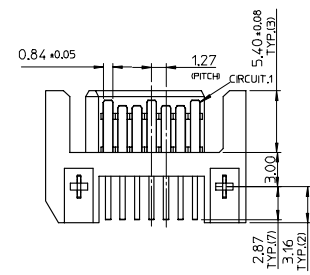
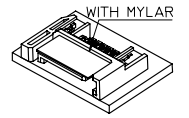
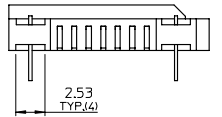
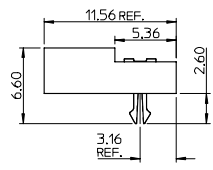
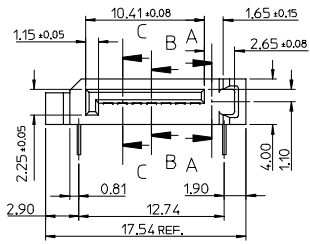
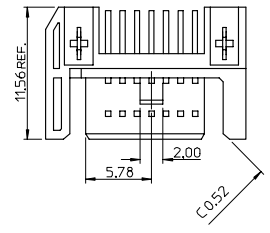

EC NO: SH2005-0091 DRWN: GRMA 2004/10/13 CHKD: 2004/10/14 APPR: YTYAP 2004/10/14	QUALITY SYMBOLS 0 0	GENERAL TOLERANCES (UNLESS SPECIFIED) mm INCH 4 PLACES ± --- ± --- 3 PLACES ± --- ± --- 2 PLACES ± 0.15 ± --- 1 PLACE ± 0.25 ± --- ANGULAR ± 3 °	SCALE 4:1 DESIGN UNITS METRIC DIMENSION STYLE MM ONLY	THIRD ANGLE PROJECTION REVISE ON CAD ONLY	TITLE SATA SYSTEM PLUG R/A STANDARD TYPE	MATERIAL NO. SEE TABLE DOCUMENT NO. SD-67490-002 SHEET NO. 1 OF 1
DESCRIPTION		DRAFT WHERE APPLICABLE MUST REMAIN WITHIN DIMENSIONS		MATERIAL NO. SEE TABLE DOCUMENT NO. SD-67490-002 SHEET NO. 1 OF 1		
THIS DRAWING CONTAINS INFORMATION THAT IS PROPRIETARY TO MOLEX INCORPORATED AND SHOULD NOT BE USED WITHOUT WRITTEN PERMISSION						

hb_frame_A3_P_AM.T
rev. B1 2000/08/01

A3