

REV	DATE	DESCRIPTION	BY	CHK	APP
AD	00				
E4		REVISED PER ECO-11-004587			

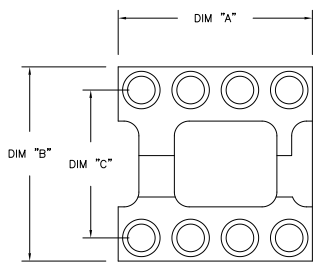

FIG. 1

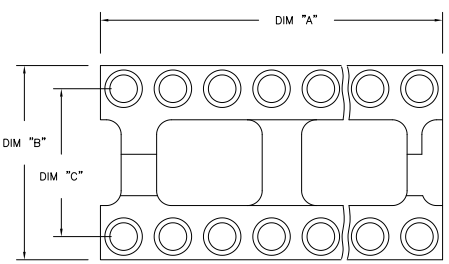

FIG. 2

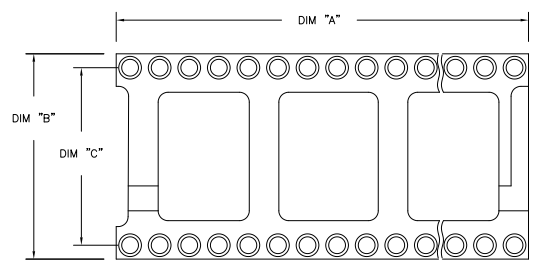
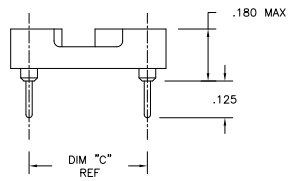
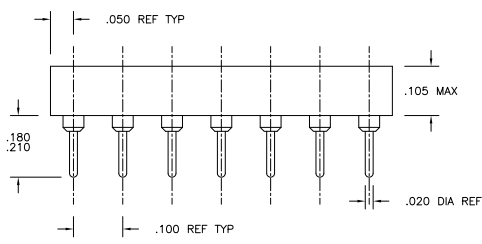
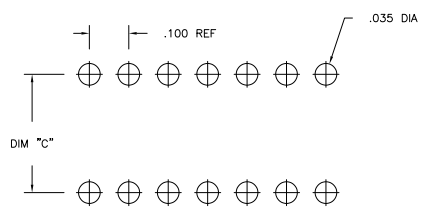

FIG. 3



- 1. INSULATOR MATERIAL - THERMOPLASTIC POLYESTER, PCT, BLACK, UL94 V-0
- △ STAMPED CONTACT - BECU, PLATED WITH 80-200.1" TIN (LEAD FREE) OVER 75-100.1" COPPER.
- △ SLEEVE - COPPER, PLATED WITH 180-340.1" THK TIN (LEAD FREE) OVER 75-125μ" MIN NICKEL.
- △ STAMPED CONTACT-BECU, PLATED WITH GOLD FLASH OVER 50-100.1" NICKEL
- △ STAMPED CONTACT-BECU, PLATED WITH 20μ" MIN GOLD OVER 30-100.1" NICKEL.
- △ ELECTRICAL:
 - CONTACT RESISTANCE: 10 MILLIOHMS MAX
 - CONTACT RATING: 3 AMPS
 - CAPACITANCE: 1.0 pF PER MIL-STD-202, METHOD 305
 - INSULATION RESISTANCE: 5000 OHMS MIN @ 500 VDC PER MIL-STD-1344, METHOD 3003.1
 - DIELECTRIC WITHSTANDING VOLTAGE: 1000 VOLTS (RMS) PER MIL-STD-1344, METHOD 3001.1
- △ MECHANICAL:
 - INSERTION FORCE: 179 GRAMS AVG
 - WITHDRAWAL FORCE: 63 GRAMS AVG
 - *ACCEPTS IC PIN - .009"x.015" THROUGH .011"x.020", OR .016" TO .021" DIAMETER, .150/.105 LONG"
- △ ENVIRONMENTAL:
 - OPERATING TEMPERATURE: -55°C TO +105°C
- △ OBSOLETE PARTS: OBSOLETE CIS STREAMLINING PER D.RENAUD/D.SINISI



P.C.B. HOLE LAYOUT
 TOLERANCE ±.003

THIS DRAWING IS A CONTROLLED DOCUMENT.		REV	DATE	STATUS	TE Connectivity	
DESCRIPTION	APPROVED LABELS	REV	DATE	STATUS	TE Connectivity	
WORKS		REV	DATE	STATUS	TE Connectivity	
DESIGN		REV	DATE	STATUS	TE Connectivity	
TESTING		REV	DATE	STATUS	TE Connectivity	
SEE NOTES		REV	DATE	STATUS	TE Connectivity	

THIS DRAWING IS UNAPPROVED FOR FABRICATION ALL DIMENSIONS ARE IN MILLIMETERS

REV	DATE	DESCRIPTION	BY	CHK	APP
AD	00	SEE SHEET 1	-	-	-

REV	DATE	DESCRIPTION	BY	CHK	APP					
△△△	△	OBsolete	GOLD	TIN	.400±.005	.500	1.200	2	24	5-1571552-7
△△△	△		GOLD	TIN	.300±.005	.400	1.200	2	24	5-1571552-6
△△△	△		GOLD	TIN	.900±.005	1.000	3.200	3	64	5-1571552-5
△△△	△		GOLD	TIN	.600±.005	.700	2.400	3	48	5-1571552-4
△△△	△		GOLD	TIN	.600±.005	.700	2.100	3	42	5-1571552-3
△△△	△		GOLD	TIN	.600±.005	.700	2.000	3	40	5-1571552-2
△△△	△		GOLD	TIN	.600±.005	.700	1.800	3	36	5-1571552-1
△△△	△		GOLD	TIN	.600±.005	.700	1.600	3	32	5-1571552-0
△△△	△		GOLD	TIN	.600±.005	.700	1.400	2	28	4-1571552-9
△△△	△		GOLD	TIN	.600±.005	.700	1.200	2	24	4-1571552-8
△△△	△		GOLD	TIN	.400±.005	.500	1.100	2	22	4-1571552-7
△△△	△		GOLD	TIN	.300±.005	.400	1.000	2	20	4-1571552-6
△△△	△		GOLD	TIN	.300±.005	.400	.900	2	18	4-1571552-5
△△△	△		GOLD	TIN	.300±.005	.400	.800	2	16	4-1571552-4
△△△	△		GOLD	TIN	.300±.005	.400	.700	2	14	4-1571552-3
△△△	△		GOLD	TIN	.300±.005	.400	.600	1	8	4-1571552-2
△△△	△		GOLD	TIN	.300±.005	.400	.500	2	14	4-1571552-2
△△△	△	OBsolete	G F	TIN	.400±.005	.500	1.200	2	24	3-1571552-7
△△△	△		G F	TIN	.300±.005	.400	1.200	2	24	3-1571552-6
△△△	△		G F	TIN	.900±.005	1.000	3.200	3	64	3-1571552-5
△△△	△		G F	TIN	.600±.005	.700	2.400	3	48	3-1571552-4
△△△	△		G F	TIN	.600±.005	.700	2.100	3	42	3-1571552-3
△△△	△		G F	TIN	.600±.005	.700	2.000	3	40	3-1571552-2
△△△	△		G F	TIN	.600±.005	.700	1.800	3	36	3-1571552-1
△△△	△		G F	TIN	.600±.005	.700	1.600	3	32	3-1571552-0
△△△	△		G F	TIN	.600±.005	.700	1.400	2	28	2-1571552-9
△△△	△		G F	TIN	.600±.005	.700	1.200	2	24	2-1571552-8
△△△	△		G F	TIN	.400±.005	.500	1.100	2	22	2-1571552-7
△△△	△		G F	TIN	.300±.005	.400	1.000	2	20	2-1571552-6
△△△	△		G F	TIN	.300±.005	.400	.900	2	18	2-1571552-5
△△△	△		G F	TIN	.300±.005	.400	.800	2	16	2-1571552-4
△△△	△		G F	TIN	.300±.005	.400	.700	2	14	2-1571552-3
△△△	△		G F	TIN	.300±.005	.400	.600	1	8	2-1571552-2
△△△	△		TIN	TIN	.400±.005	.500	1.200	2	24	1-1571552-7
△△△	△		TIN	TIN	.300±.005	.400	1.200	2	24	1-1571552-6
△△△	△	OBsolete	TIN	TIN	.900±.005	1.000	3.200	3	64	1-1571552-5
△△△	△	OBsolete	TIN	TIN	.600±.005	.700	2.400	3	48	1-1571552-4
△△△	△	OBsolete	TIN	TIN	.600±.005	.700	2.100	3	42	1-1571552-3
△△△	△	OBsolete	TIN	TIN	.600±.005	.700	2.000	3	40	1-1571552-2
△△△	△	OBsolete	TIN	TIN	.600±.005	.700	1.800	3	36	1-1571552-1
△△△	△		TIN	TIN	.600±.005	.700	1.600	3	32	1-1571552-0
△△△	△		TIN	TIN	.600±.005	.700	1.400	2	28	1571552-9
△△△	△		TIN	TIN	.600±.005	.700	1.200	2	24	1571552-8
△△△	△	OBsolete	TIN	TIN	.400±.005	.500	1.100	2	22	1571552-7
△△△	△		TIN	TIN	.300±.005	.400	1.000	2	20	1571552-6
△△△	△		TIN	TIN	.300±.005	.400	.900	2	18	1571552-5
△△△	△		TIN	TIN	.300±.005	.400	.800	2	16	1571552-4
△△△	△		TIN	TIN	.300±.005	.400	.700	2	14	1571552-3
△△△	△		TIN	TIN	.300±.005	.400	.600	1	8	1571552-2

FINISH CONTACT/SLEEVE	"C" MAX	"B" MAX	"A" MAX	FIG	NO. OF POSN	PART NO.

THIS DRAWING IS A CONTROLLED DOCUMENT. THE REV. IS MARKED BY THE DATE.

TE Connectivity
 OPEN FRAME DIP ECONOMY (STAMPED CONTACT) (REF AUGAT 800 SERIES)

DATE: 000779G-1571552
 REV: 1.1
 SHEET: 2 OF 2