

PRODUCT NUMBER SEE TABLE	SIZE	DIM H	DIM J	DIM K	DIM L
	2X5	.275/6.99	.200/5.08	.372/9.45	.320/8.13
	2X10	.525/13.34	.450/11.43	.622/15.80	.570/14.48
	2X15	.775/19.68	.700/17.78	.872/22.15	.820/20.83
	2X20	1.025/26.03	.950/24.13	1.122/28.50	1.070/27.18
	2X25	1.275/32.38	1.200/30.48	1.372/34.85	1.320/33.53
	2X30	1.525/38.74	1.450/36.83	1.622/41.20	1.570/39.88
	2X35	1.775/45.08	1.700/43.18	1.872/47.55	1.820/46.23
	2X40	2.025/51.43	1.950/49.53	2.122/53.90	2.070/52.58
	2X45	2.275/57.78	2.200/55.88	2.372/60.25	2.320/58.93
	2X50	2.525/64.14	2.450/62.23	2.622/66.60	2.570/65.28

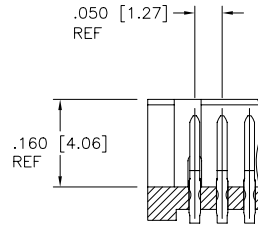
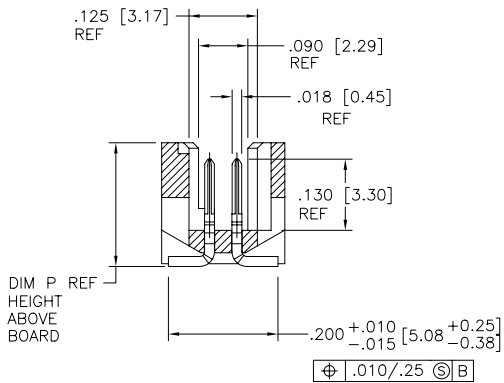

SECTION Y-Y

SECTION X-X
ROTATED 90° CW

mat'l. code		surface	tolerance	projection	product family
SEE NOTES		ISO 1302	ISO 406 ISO 1101		RIB CAGE
lfr	ecm no	dr	date	title	
AD				RIB CAGE III SMT VERT. HEADER ASS'Y	
angles		linear	tolerances unless otherwise specified	INCH/MM	scale
			XX ±.01/XX±0.3	1:1	
			XXX±.05/XX±0.13		
			XXXX±.000/XX±0.051		
dr	M. CORNMAN	6/07/95		dwg no	sheet 2 of 6 size
enr	D. WHITING	6/07/95		95781	A3
chr	D. WHITING	6/07/95		type	Product Customer Drawing
appd	D. WHITING	6/07/95			
sheet index	revision sheet				

PDM: Rev:AD

STATUS:Released

Printed: Jun 29, 2010 6

PRODUCT NUMBER
SEE TABLE

LOCATOR/HOLDDOWN VARIATIONS

STYLE 1



STYLE 5

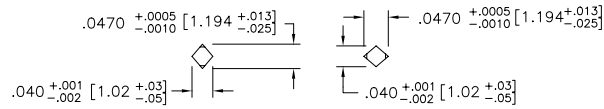
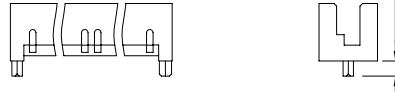

STYLE 2

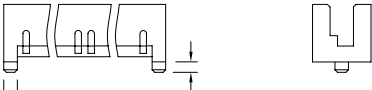

STYLE 6
SEE NOTE 9

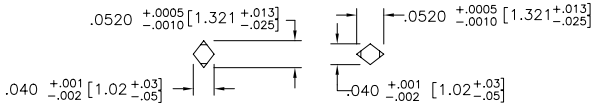
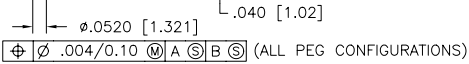
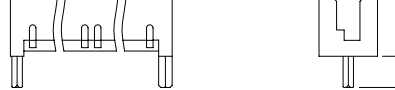

STYLE 3

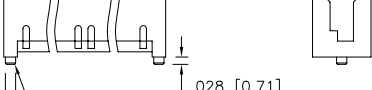

STYLE 7

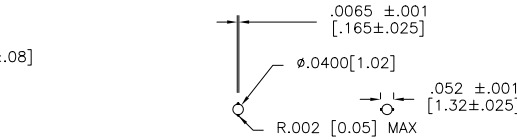
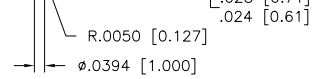
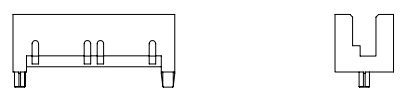

STYLE 4

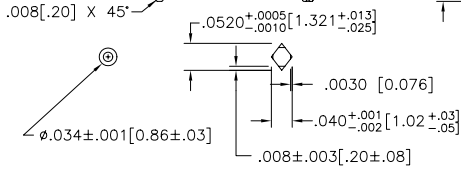
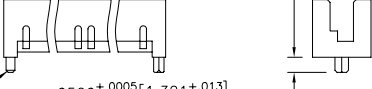

mal'l. code SEE NOTES				surface ISO 1302	tolerance ISO 406 ISO 1101	projection 	product family RIB CAGE
lfr	ecm no	dr	date	tolerances unless otherwise specified		INCH/MM	title RIB CAGE III SMT VERT. HEADER ASS'Y
AD				angles	linear	scale 1:1	dwg no 95781
				dr	M. CORNMANN	6/07/95	sheet 3 of 6
				enr	D. WHITING	6/07/95	size A3
				chr	D. WHITING	6/07/95	
				appd	D. WHITING	6/07/95	
sheet index	revision sheet						type Product Customer Drawing

PDM: Rev:AD

STATUS: Released

Printed: Jun 29, 2010

Copyright FCJ
FCJconnect.com

PRODUCT NUMBER
SEE TABLE

RECOMMENDED PCB MOUNTING PAD PATTERN

STYLE 1

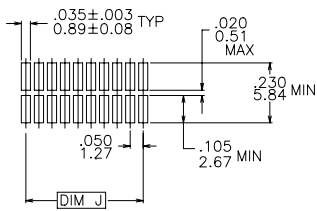

STYLE 5

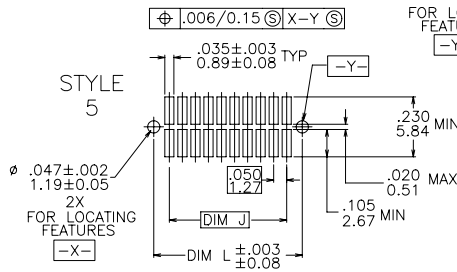

STYLE 4

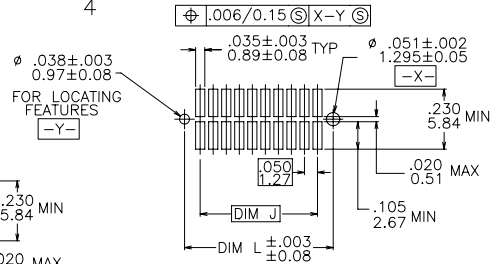

STYLE 2

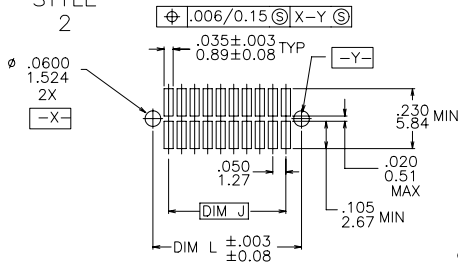

STYLE 7

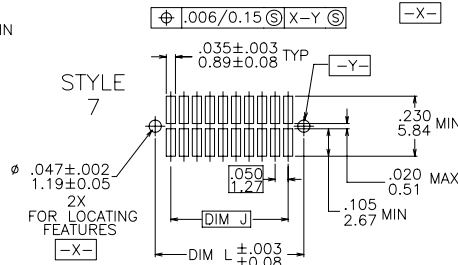

STYLE 6

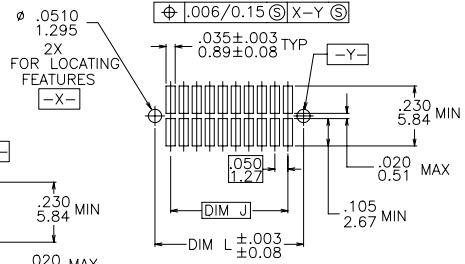

STYLE 3

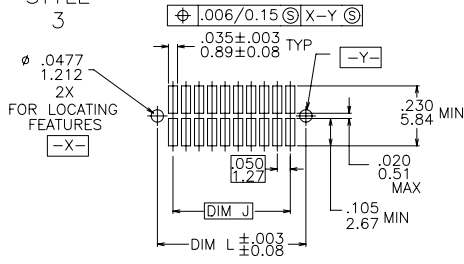

mal't. code		surface	tolerance	projection	product family
SEE NOTES		ISO 1302	ISO 406 ISO 1101		RIB CAGE
lfr	ecn no	dr	date	title	
AD				RIB CAGE III SMT VERT. HEADER ASS'Y	
angles		linear	XX ± 0.1/XX ± 0.3	INCH/MM	
σ±z			XXX ± 0.05/XXX ± 0.15	scale 1:1	
dr	M. CORNMANN	6/07/95		dwg no	
enrg	D. WHITING	6/07/95		95781	
chr	D. WHITING	6/07/95		sheet 4 of 6 size	
appd	D. WHITING	6/07/95		A3	
sheet index		revision sheet		type Product Customer Drawing	

PDM: Rev:AD

STATUS: Released

Printed: Jun 29, 2010

PRODUCT NUMBER NOTE 1,4A & 4B	DIM P HEIGHT ABOVE BOARD (REF.)	HOLDDOWN STYLE
72428-1XX	.244/6.20	1
73546-1XX	.364/9.25	1
73547-1XX	.364/9.25	2
73548-1XX	.364/9.25	4
84700-1XX	.226/5.74	7
84701-1XX	.298/7.57	7
84734-1XX	.364/9.25	7
87401-1XX	.226/5.74	6
87409-1XX	.226/5.74	2
87849-1XX	.226/5.74	1
88566-1XX	.260/6.60	2
90098-1XX	.298/7.57	2
90863-1XX	.226/5.74	1
91036-1XX	.364/9.25	5
91423-1XX	.226/5.74	2
91855-1XX	.226/5.74	5
92099-1XX	.226/5.74	4
92412-1XX	.298/7.57	4
93206-1XX	.226/5.74	3
93221-1XX	.298/7.57	1
93289-1XX	.298/7.57	5

TABLE A

* CUSTOMER SPECIAL

SEE NOTE 10

*

NOTES:

- ① XXXXX-XXXLF
LEAD FREE OPTION (NOTE 11& 13)
NUMBER OF POSITIONS (NOTE 2)
- ② NUMBER OF POSITIONS = 05 THRU 50 IN 5 POS INCREMENTS.
(EXAMPLE : 105=10 POS., 110=20 POS. ETC.)
- ③ REQUIRED ON -X40,-X45 & -X50 POSITION PARTS ONLY.
4. PACKAGING :
A. ANTISTATIC TUBES. SEE TABLE A
B. ADD "CT" TO END OF DASH NUMBER FOR CONNECTOR
WITH VACUUM CAP IN ANTISTATIC TUBES.
EX. : XXXXX-1XXCT
C. PRESSURE SEALED TAPE AND REEL. SEE TABLE C
FOR AVAILABLE PART NUMBERS.
- ⑤ HOUSING MATERIAL :
GLASS FILLED THERMOPLASTIC FLAME RETARDANT PER UL 94V-0.
COLOR : NATURAL
- ⑥ TERMINAL PLATING :
30u"/.76u HARD Au OVER 50u"/1.27u NI ON CONTACT ZONES.
100u"/2.54u PURE TIN OVER 50u"/1.27u Ni IN SOLDERING ZONES.
- ⑦ MOLDING FLOW RESTRICTOR QUANTITY AND LOCATION IS
MANUFACTURING OPTION.
- ⑧ VACUUM CAP SLOT REQUIRED ON ALL SIZES, SLOT MAY
BE LOCATED ON OPPOSITE SIDE FOR 2 X 5.
- ⑨ STYLE 6 IS NOT AVAILABLE IN TAPE AND REEL.
- ⑩ 90863-1XX IS PACKAGED ONLY IN TAPE AND REEL.
- ⑪ ADD LF SUFFIX AT THE END OF PART NUMBER FOR LEAD FREE OPTION.
12. THE HOUSING WILL WITHSTAND EXPOSURE TO 260°C PEAK TEMPERATURE
FOR 20 SECONDS IN A CONVECTION, INFRA-RED OR VAPOR PHASE REFLOW
OVEN. SEE APPLICATION NOTE/PROCEDURES IF THEY ARE AVAILABLE.
- ⑬ THIS PRODUCT MEETS EUROPEAN UNION DIRECTIVES AND OTHER
COUNTRY REGULATION AS DESCRIBED IN GS-22-008.

mat'l. code		surface	tolerance	projection	product family
SEE NOTES		ISO 1302	ISO 406 ISO 1101		RIB CAGE
lfr	ecn no	dr	date	title	
AD				RIB CAGE III SMT VERT. HEADER ASS'Y	
angles		linear	XX ±.01/XX±0.3	INCH/MM	
oz±			XXX±.005/XXX±0.13	scale 1:1	
dr	M. CORNMAN	6/07/95		dwg no	
enqr	D. WHITING	6/07/95		95781	
chr	D. WHITING	6/07/95		sheet 5 of 6	
appd	D. WHITING	6/07/95		A3	
sheet index		revision	sheet	type	
				Product Customer Drawing	

PDM: Rev:AD

STATUS:Released

Printed: Jun 29, 2010

PRODUCT NUMBER NOTE 11,4C	QTY. REEL	TAPE WIDTH PITCH MM	CONNECTOR ORIENTATION IN TAPE POCKET
72428-120TR	500	44/12	VIEW 1
73547-110TR		24/12	
84700-105TR		24/12	
84700-135TR		56/12	
87409-115TR		44/12	
87409-120TR		44/12	
87409-125TR		56/12	
87409-130TR		56/12	
87409-140TR		72/12	
87849-110TR		24/12	
87849-115TR		44/12	
87849-120TR		44/12	
87849-125TR		56/12	
87849-130TR	500	56/12	
88566-110TR	500	24/12	
88566-115TR	500	44/12	
88566-130TR	500	56/12	
90863-110		24/12	
90863-115		44/12	VIEW 1
90863-115REV		44/12	VIEW 2 *
90863-120		44/12	VIEW 1
90863-125		56/12	
90863-130		56/12	
91036-110P		24/16	
93206-115TR	500	44/12	
93221-105TR	400	24/12	
93221-110TR	400	32/12	
93221-125TR	400	56/12	VIEW 1

TABLE C

* CUSTOMER SPECIAL
NO VACUUM CAP

REFERENCE ONLY :

TAPE WIDTH 32mm AND ABOVE HAS BOTH FEED TRACKS,
BELOW 32mm HAS TOP FEED TRACK ONLY.

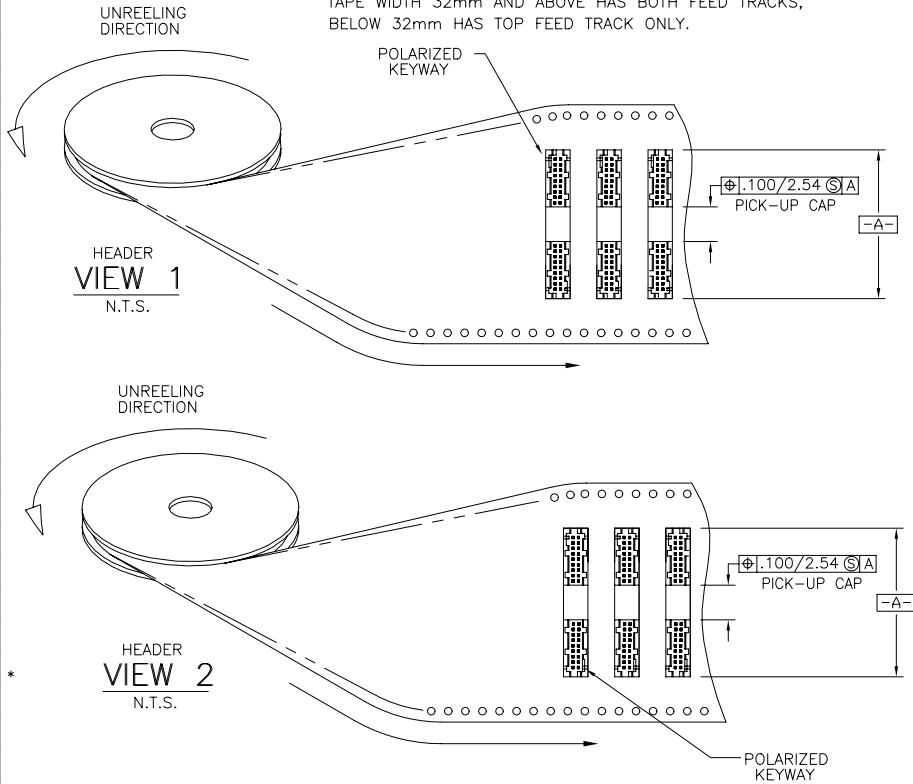

mat'l. code	surface	tolerance	projection	product family
SEE NOTES	ISO 1302	ISO 406 ISO 1101		RIB CAGE
ltr	ecn no	dr	date	title
AD				RIB CAGE III SMT VERT. HEADER ASS'Y
	angles	linear	scale	dwg no
		XX ±.01/XX±0.3 XXX±.005/XX±0.13	1:1	95781
	dr	M. CORNMAN	6/07/95	sheet 6 of 6
	enr	D. WHITING	6/07/95	size A3
	chr	D. WHITING	6/07/95	
	appd	D. WHITING	6/07/95	type Product Customer Drawing
sheet index	revision sheet			

PDM: Rev:AD

STATUS: Released

Printed: Jun 29, 2010