

## FEATURES AND SPECIFICATIONS

### Features and Benefits

- Sizes 1 to 28 circuits
- Standard with locking ramp
- Suitable for high vibration requirements

### Reference Information

Product Specification: PS-7879  
 Packaging: Bag  
 UL File No.: E29179  
 CSA File No.: LR19980  
 Mates With: Molex KK 2.54mm (.100") pitch headers  
 Use With: 7879 terminals  
 Designed In: Inches

### Electrical\*

Voltage: 250V  
 Current: 2.5A  
 Contact Resistance: 20mΩ max.  
 Dielectric Withstanding Voltage: 1500V AC  
 Insulation Resistance: 500K MΩ min.

### Mechanical\*

Contact Insertion Force: 1.5 lb max.  
 Contact Retention to Housing: 8 lb min.  
 Mating Force: 475g max.  
 Unmating Force: 100g min.  
 Normal Force: 430g min.

### Physical

Housing: White nylon, UL 94V-0  
 Operating Temperature: -0 to +75°C



# 2.54mm (.100") Pitch KK® Crimp Terminal Housing

## 7880 High Pressure

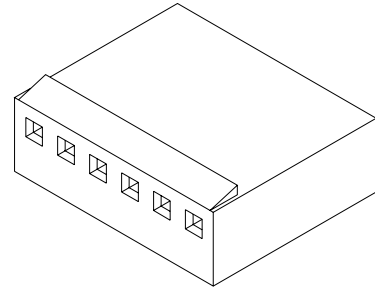

C  
 2.54mm (.100") Pitch

## CATALOG DRAWING (FOR REFERENCE ONLY)

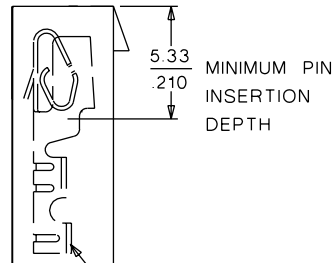
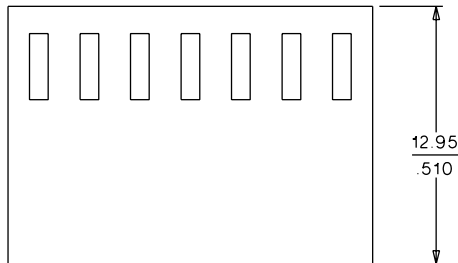
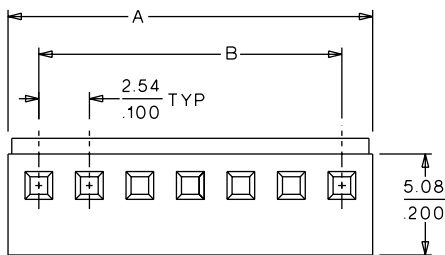

TERMINAL SHOWN FOR REFERENCE ONLY

## ORDERING INFORMATION AND DIMENSIONS

Circuits	Order No.	Dimension	
		A	B
1	• 10-11-2013	3.10 (.122)	
2	• 10-11-2023	5.64 (.222)	2.54 (.100)
3	• 10-11-2033	8.18 (.322)	5.08 (.200)
4	• 10-11-2043	10.72 (.422)	7.62 (.300)
5	• 10-11-2053	13.26 (.522)	10.16 (.400)
6	• 10-11-2063	15.80 (.622)	12.70 (.500)
7	• 10-11-2073	18.34 (.722)	15.24 (.600)
8	• 10-11-2083	20.88 (.822)	17.78 (.700)
9	• 10-11-2093	23.42 (.922)	20.32 (.800)
10	• 10-11-2103	25.96 (1.022)	22.86 (.900)
11	• 10-11-2113	28.50 (1.122)	25.40 (1.000)
12	• 10-11-2123	31.04 (1.222)	27.94 (1.100)
13	• 10-11-2133	33.58 (1.322)	30.48 (1.200)
14	• 10-11-2143	36.12 (1.422)	33.02 (1.300)

Circuits	Order No.	Dimension	
		A	B
15	• 10-11-2153	38.66 (1.522)	35.56 (1.400)
16	• 10-11-2163	41.20 (1.622)	38.10 (1.500)
17	• 10-11-2173	43.74 (1.722)	40.64 (1.600)
18	• 10-11-2183	46.28 (1.822)	43.18 (1.700)
19	• 10-11-2193	48.82 (1.922)	45.72 (1.800)
20	• 10-11-2203	51.36 (2.022)	48.26 (1.900)
21	• 10-11-2213	53.90 (2.122)	50.80 (2.000)
22	• 10-11-2223	56.44 (2.222)	53.34 (2.100)
23	• 10-11-2233	59.98 (2.322)	55.88 (2.200)
24	• 10-11-2243	61.52 (2.422)	58.42 (2.300)
25	• 10-11-2253	64.06 (2.522)	60.96 (2.400)
26	• 10-11-2263	66.60 (2.622)	63.50 (2.500)
27	• 10-11-2273	69.14 (2.722)	66.04 (2.600)
28	• 10-11-2283	71.68 (2.822)	68.58 (2.700)

• US Standard Product, available through Molex franchised distributors

\* When mated with Molex product only

Note: In the Far East this housing has a different Engineering Series No. and different Order No.