

NOTES:

- HOUSING MATL: LCP, UL94V-0, COLOR BLACK
TERMINAL MATL: COPPER ALLOY
- FINISH: SELECT GOLD: 30 M.I. MIN IN CONTACT AREA
SELECT TIN: 150 M.I. MIN IN SOLDER AREA
OVERALL NICKEL UNDERPLATE.
- PRODUCT SPECIFICATION: PS-45719-001.
- PACKAGING SPECIFICATION: PK-45714-001.
- PCB THICKNESS: 2.36 MIN
- EDGE CARD THICKNESS: 1.57±0.15
- DIMENSIONS GIVEN ACROSS CENTERLINES ARE SYMMETRICAL ABOUT THOSE CENTERLINES WITHIN HALF TOTAL TOLERANCE.
- PCB HOLE SPECIFICATION: SEE PS-45719-001
- VOIDED SEGMENTS DO NOT HAVE TERMINALS IN THE TOP OR BOTTOM ROW

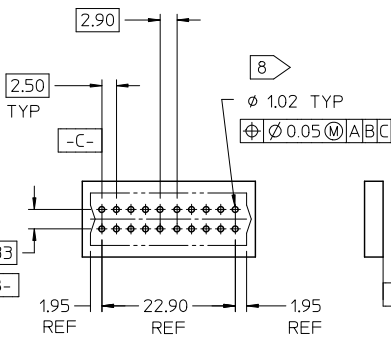
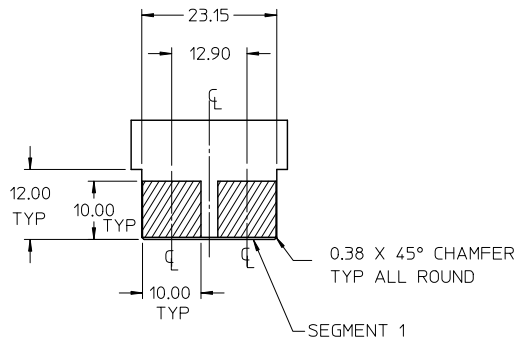
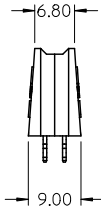
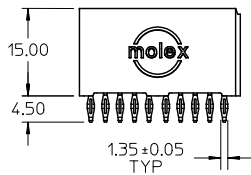

PCB LAYOUT: COMPONENT SIDE

RECOMMENDED EDGE CARD LAYOUT
TOLERANCE: ±0.05

MATERIAL NUMBER	VOIDED SEGMENT
45714-0001	NONE
45714-2001	1
45714-2002	2

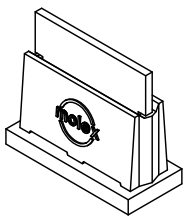

ADD: 1.35 DIM EC NO: UCP2010-3140 TD: DRWN: JSCHAFFER 2010/06/08 CHKD: MARGULIS 2003/11/11 APPR: APATEL 2010/06/14	DESCRIPTION GENERAL TOLERANCES (UNLESS SPECIFIED)	DIMENSION STYLE MM ONLY	SCALE 1:1	DESIGN UNITS METRIC	THIRD ANGLE PROJECTION
		DRAWN BY MARGULIS	DATE 2003/11/11	TITLE POWER EDGE ASSEMBLY POWER VERTICAL CPI (2 SEGMENT PARTS)	
		CHECKED BY MARGULIS	DATE 2003/11/11		
		APPROVED BY MARGULIS	DATE 2003/11/11	MOLEX INCORPORATED	
REV DRAFT WHERE APPLICABLE MUST REMAIN WITHIN DIMENSIONS	ANGULAR ±1/2°	SEE CHARTS	DOCUMENT NO. SD-45714-001	SHEET NO. 1 OF 4	
		THIS DRAWING CONTAINS INFORMATION THAT IS PROPRIETARY TO MOLEX INCORPORATED AND SHOULD NOT BE USED WITHOUT WRITTEN PERMISSION			

6 5 4 3 2 1

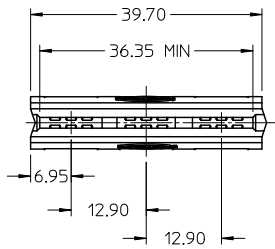

NOTES:
1. FOR ALL OTHER DIMENSIONS AND NOTES SEE SHEET 1.

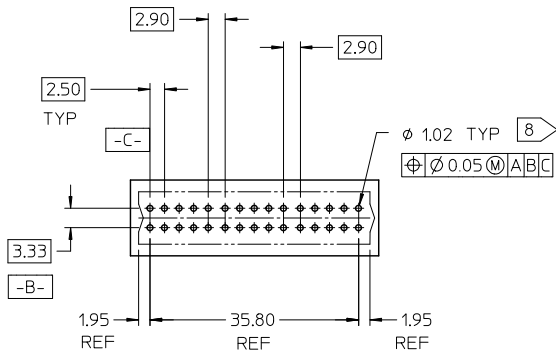
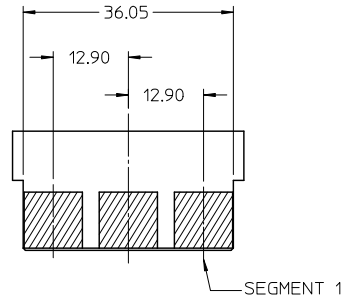
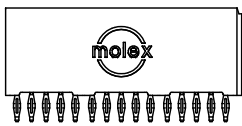

PCB LAYOUT: COMPONENT SIDE

RECOMMENDED EDGE CARD LAYOUT
EDGE CARD TOLERANCE: ±0.05

MATERIAL NUMBER	VOIDED SEGMENT
45714-0002	NONE
45714-3001	1
45714-3002	2
45714-3003	3
45714-3004	1,2
45714-3005	1,3
45714-3006	2,3

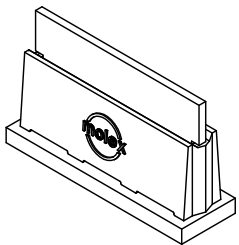

REV	DESCRIPTION
5	EC NO: UCP2010-3140 TD:RW:JSCHAFFER 2010/06/08 CHKD:MARGULIS 2003/11/11 APPR:APATEL 2010/06/14

GENERAL TOLERANCES (UNLESS SPECIFIED)	
	mm
4 PLACES	±---
3 PLACES	±---
2 PLACES	±0.25
1 PLACE	±0.25
ANGULAR ±1/2°	

DIMENSION STYLE	
MM ONLY	
DRAWN BY	MARGULIS
DATE	2003/11/11
CHECKED BY	MARGULIS
DATE	2003/11/11
APPROVED BY	MARGULIS
DATE	2003/11/11

SCALE	DESIGN UNITS	THIRD ANGLE PROJECTION
1:1	METRIC	☉
TITLE POWER EDGE ASSEMBLY POWER VERTICAL CPI (3 SEGMENT PARTS)		
MOLEX INCORPORATED		
DOCUMENT NO. SD-45714-001	SHEET NO. 2	

DRAFT WHERE APPLICABLE
MUST REMAIN
WITHIN DIMENSIONS

SIZE A THIS DRAWING CONTAINS INFORMATION THAT IS PROPRIETARY TO MOLEX INCORPORATED AND SHOULD NOT BE USED WITHOUT WRITTEN PERMISSION

fb_frame_A_P_AM_T
Rev. D 2004/06/28

5 4 3 2 1

6 5 4 3 2 1

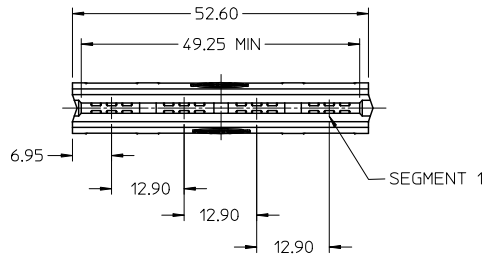

NOTES:
1. FOR ALL OTHER DIMENSIONS AND NOTES SEE SHEET 1.

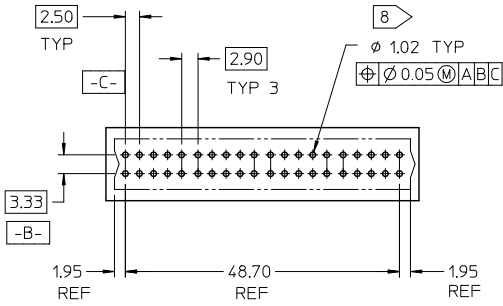
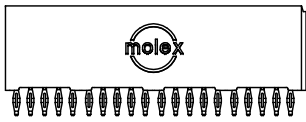

PCB LAYOUT: COMPONENT SIDE

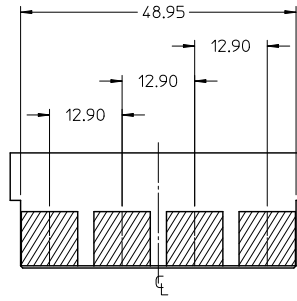

RECOMMENDED EDGE CARD LAYOUT
EDGE CARD TOLERANCE: ±0.05

MATERIAL NUMBER	VOIDED SEGMENT
45714-0003	NONE
45714-4001	1
45714-4002	2
45714-4003	3
45714-4004	4
45714-4005	1,2
45714-4006	1,3
45714-4007	1,4
45714-4008	2,3
45714-4009	2,4
45714-4010	3,4

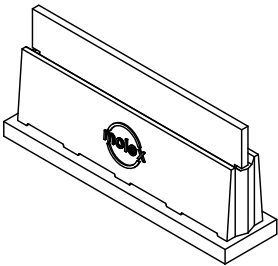

EC NO: UCP2010-3140 TDRWN: JSCHAFFER 2010/06/08 CHKD: MARGULIS 2003/11/11 APPR: APATEL 2010/06/14 REV DESCRIPTION	GENERAL TOLERANCES (UNLESS SPECIFIED)		DIMENSION STYLE MM ONLY		SCALE 1:1	DESIGN UNITS METRIC	THIRD ANGLE PROJECTION	
		mm	INCH	DRAWN BY	DATE	TITLE		
	4 PLACES	±---	±---	MARGULIS	2003/11/11	POWER EDGE ASSEMBLY POWER VERTICAL CPI (4 SEGMENT PARTS)		
	3 PLACES	±---	±---	CHECKED BY	DATE	MOLEX INCORPORATED		
2 PLACES	±0.25	±---	MARGULIS	2003/11/11	DOCUMENT NO.			
1 PLACE	±0.25	±---	APPROVED BY	DATE	SD-45714-001			
	ANGULAR ±1/2°		MARGULIS	2003/11/11	SHEET NO.			
DRAFT WHERE APPLICABLE MUST REMAIN WITHIN DIMENSIONS			SIZE	THIS DRAWING CONTAINS INFORMATION THAT IS PROPRIETARY TO MOLEX INCORPORATED AND SHOULD NOT BE USED WITHOUT WRITTEN PERMISSION				
	A							

tb_frame_A_P_AM_T
Rev. D 2004/06/28

5 4 3 2 1