

PCB LAYOUT: COMPONENT SIDE

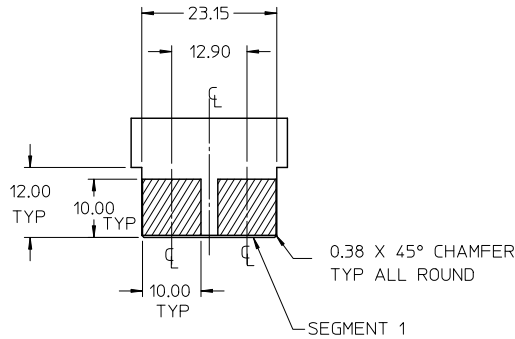

RECOMMENDED EDGE CARD LAYOUT
TOLERANCE: ±0.05

NOTES:

- HOUSING MATL: LCP, UL94V-0, COLOR BLACK
TERMINAL MATL: COPPER ALLOY
- FINISH: SELECT GOLD: 30 M.I. MIN IN CONTACT AREA
SELECT TIN: 150 M.I. MIN IN SOLDER AREA
OVERALL NICKEL UNDERPLATE.
- PRODUCT SPECIFICATION: PS-45719-001.
- PACKAGING SPECIFICATION: PK-45714-001.
- PCB THICKNESS: 2.36 MIN
- EDGE CARD THICKNESS: 1.57±0.15
- DIMENSIONS GIVEN ACROSS CENTERLINES ARE SYMMETRICAL ABOUT THOSE CENTERLINES WITHIN HALF TOTAL TOLERANCE.
- PCB HOLE SPECIFICATION: SEE PS-45719-001
- VOIDED SEGMENTS DO NOT HAVE TERMINALS IN THE TOP OR BOTTOM ROW

MATERIAL NUMBER	VOIDED SEGMENT
45714-0001	NONE
45714-2001	1
45714-2002	2

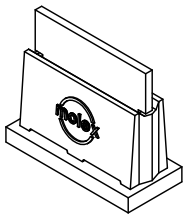

ADD: 1.35 DIM EC NO: UCP2010-3140 TD: DRWN: JSCHAFFER 2010/06/08 CHKD: MARGULIS 2003/11/11 APPR: APATEL 2010/06/14	DESCRIPTION REV	GENERAL TOLERANCES (UNLESS SPECIFIED)	DIMENSION STYLE MM ONLY	SCALE 1:1	DESIGN UNITS METRIC	THIRD ANGLE PROJECTION																	
		<table border="1"> <thead> <tr> <th></th> <th>mm</th> <th>INCH</th> </tr> </thead> <tbody> <tr> <td>4 PLACES</td> <td>±---</td> <td>±---</td> </tr> <tr> <td>3 PLACES</td> <td>±---</td> <td>±---</td> </tr> <tr> <td>2 PLACES</td> <td>±0.25</td> <td>±---</td> </tr> <tr> <td>1 PLACE</td> <td>±0.25</td> <td>±---</td> </tr> <tr> <td colspan="3">ANGULAR ±1/2°</td> </tr> </tbody> </table>		mm	INCH	4 PLACES	±---	±---	3 PLACES	±---	±---	2 PLACES	±0.25	±---	1 PLACE	±0.25	±---	ANGULAR ±1/2°			DRAWN BY MARGULIS	DATE 2003/11/11	TITLE POWER EDGE ASSEMBLY POWER VERTICAL CPI (2 SEGMENT PARTS)
			mm	INCH																			
		4 PLACES	±---	±---																			
3 PLACES	±---	±---																					
2 PLACES	±0.25	±---																					
1 PLACE	±0.25	±---																					
ANGULAR ±1/2°																							
DRAFT WHERE APPLICABLE MUST REMAIN WITHIN DIMENSIONS	CHECKED BY MARGULIS	DATE 2003/11/11	APPROVED BY MARGULIS	DATE 2003/11/11	MOLEX INCORPORATED	SHEET NO. 1 OF 4																	
		SEE CHARTS	DOCUMENT NO. SD-45714-001																				

THIS DRAWING CONTAINS INFORMATION THAT IS PROPRIETARY TO MOLEX INCORPORATED AND SHOULD NOT BE USED WITHOUT WRITTEN PERMISSION

6 5 4 3 2 1

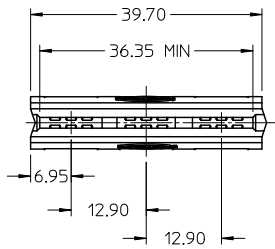

NOTES:
1. FOR ALL OTHER DIMENSIONS AND NOTES SEE SHEET 1.

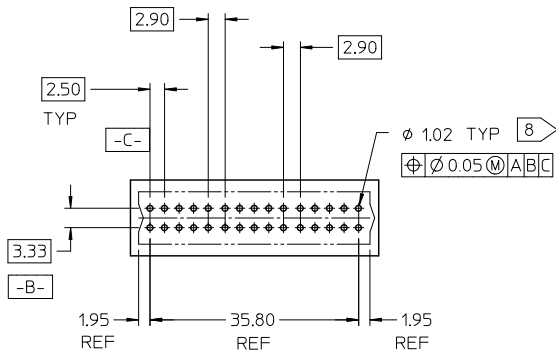
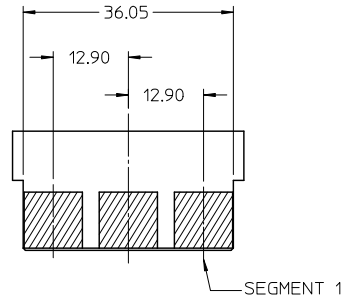
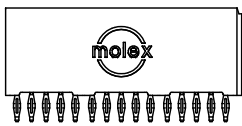

RECOMMENDED EDGE CARD LAYOUT
EDGE CARD TOLERANCE: ±0.05

MATERIAL NUMBER	VOIDED SEGMENT
45714-0002	NONE
45714-3001	1
45714-3002	2
45714-3003	3
45714-3004	1,2
45714-3005	1,3
45714-3006	2,3

PCB LAYOUT: COMPONENT SIDE

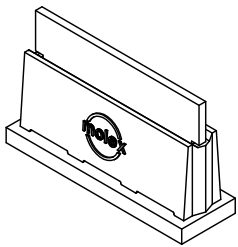

EC NO: UCP2010-3140 TD/RWN: JSCHAFFER 2010/06/08 CHKD: MARGULIS 2003/11/11 APPR: APATEL 2010/06/14	DESCRIPTION REV	GENERAL TOLERANCES (UNLESS SPECIFIED)		DIMENSION STYLE MM ONLY		SCALE 1:1	DESIGN UNITS METRIC	THIRD ANGLE PROJECTION
		4 PLACES ± --- ± ---	DRAWN BY MARGULIS	DATE 2003/11/11	TITLE POWER EDGE ASSEMBLY POWER VERTICAL CPI (3 SEGMENT PARTS)			
		3 PLACES ± --- ± ---	CHECKED BY MARGULIS	DATE 2003/11/11	MOLEX INCORPORATED			
		2 PLACES ± 0.25 ± ---	APPROVED BY MARGULIS	DATE 2003/11/11	DOCUMENT NO. SD-45714-001	SHEET NO. 2		
		1 PLACE ± 0.25 ± ---	ANGULAR ± 1/2°		THIS DRAWING CONTAINS INFORMATION THAT IS PROPRIETARY TO MOLEX INCORPORATED AND SHOULD NOT BE USED WITHOUT WRITTEN PERMISSION			
DRAFT WHERE APPLICABLE MUST REMAIN WITHIN DIMENSIONS		SIZE A						

fb_frame_A_P_AM_T
Rev. D 2004/06/28

5 4 3 2 1

6 5 4 3 2 1

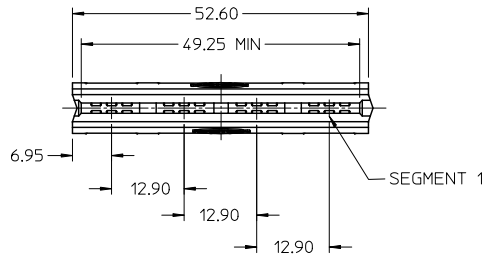

NOTES:
1. FOR ALL OTHER DIMENSIONS AND NOTES SEE SHEET 1.

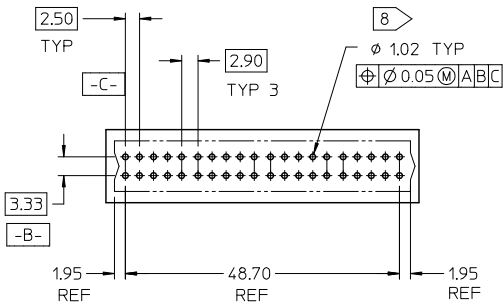

PCB LAYOUT: COMPONENT SIDE

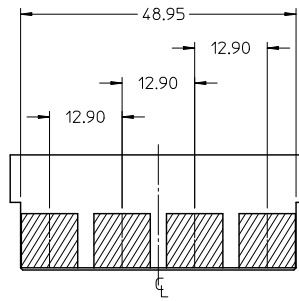

RECOMMENDED EDGE CARD LAYOUT
EDGE CARD TOLERANCE: ±0.05

MATERIAL NUMBER	VOIDED SEGMENT
45714-0003	NONE
45714-4001	1
45714-4002	2
45714-4003	3
45714-4004	4
45714-4005	1,2
45714-4006	1,3
45714-4007	1,4
45714-4008	2,3
45714-4009	2,4
45714-4010	3,4

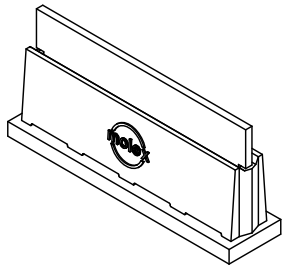

EC NO: UCP2010-3140 TDRWN: JSCHAFFER 2010/06/08 CHKD: MARGULIS 2003/11/11 APPR: APATEL 2010/06/14 REV DESCRIPTION	GENERAL TOLERANCES (UNLESS SPECIFIED)		DIMENSION STYLE MM ONLY		SCALE 1:1	DESIGN UNITS METRIC	THIRD ANGLE PROJECTION		
		mm	INCH	DRAWN BY	DATE	TITLE			
	4 PLACES	±---	±---	MARGULIS	2003/11/11	POWER EDGE ASSEMBLY POWER VERTICAL CPI (4 SEGMENT PARTS)			
	3 PLACES	±---	±---	CHECKED BY	DATE				
2 PLACES	±0.25	±---	MARGULIS	2003/11/11	MOLEX INCORPORATED				
1 PLACE	±0.25	±---	APPROVED BY	DATE					
	ANGULAR ±1/2°		MARGULIS	2003/11/11	DOCUMENT NO.		SHEET NO.		
	DRAFT WHERE APPLICABLE MUST REMAIN WITHIN DIMENSIONS		SIZE A		SD-45714-001		3		
					THIS DRAWING CONTAINS INFORMATION THAT IS PROPRIETARY TO MOLEX INCORPORATED AND SHOULD NOT BE USED WITHOUT WRITTEN PERMISSION				

tb_frame_A_P_AM_T
Rev. D 2004/06/28

5 4 3 2 1