

DRAWING No.: M52-04000P0545

IF IN DOUBT - ASK

(C)

NOT TO SCALE

THIRD ANGLE PROJECTION

ALL DIMENSIONS IN mm

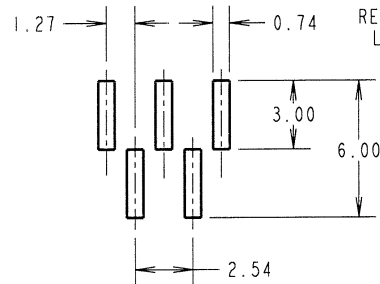
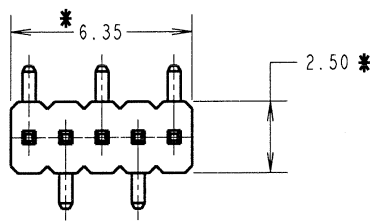
RECOMMENDED PAD  
LAYOUT  $\pm 0.05$ 

## SPECIFICATIONS:

MATERIAL:  
MOULDING = NYLON 6T, UL94V-0, BLACK  
CONTACT = BRASS

FINISH:  
CONTACT = GOLD

ELECTRICAL:  
CURRENT RATING = 1A  
CONTACT RESISTANCE = 20m $\Omega$  MAX  
INSULATION RESISTANCE = 5000M $\Omega$  MIN  
DIELECTRIC STRENGTH = 500V AC FOR 1 MINUTE

ENVIRONMENTAL:  
TEMPERATURE RANGE = -40°C TO +105°C

PACKING:  
BAG  
FOR COMPLETE SPECIFICATION SEE  
COMPONENT SPECIFICATION C029XX  
(LATEST ISSUE)

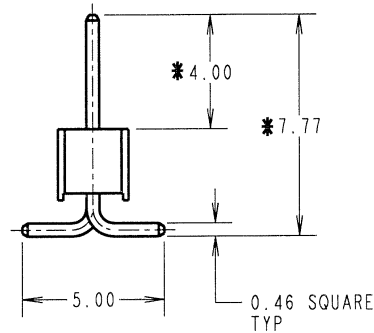
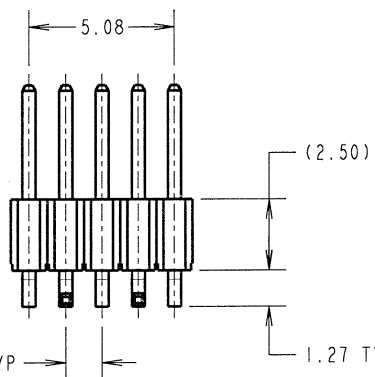

## NOTES:

1. ALL DIMENSIONS AND NOTES MARKED \* ARE CRITICAL AND MUST BE CHECKED IN ACCORDANCE WITH QUALITY INSTRUCTION Q1-02.
2. MAXIMUM PERMISSIBLE OUT OF SQUARE OF PIN TO MOULDING TO BE 0.15mm IN ANY DIRECTION.
3. CONTACT LEG VARIATION ON COMPLETE ASSEMBLY NOT TO EXCEED 0.20mm.
- \* 4. ALL TOLERANCES ARE  $\pm 0.20$  UNLESS OTHERWISE STATED.
5. ALL PRODUCT TO HAVE 'LEAD FREE' LABELLING ON ALL PACKAGING.

JMB	1	17.11.05	----
NAME	ISS.	DATE	C/NOTE
APPROVED: <i>RC</i>			
CHECKED: <i>M. Brooks</i>			
DRAWN: JM BROOKES			
CUSTOMER REF.:			
ASSEMBLY DRG:			

# HARWIN

HARWIN USA  
TEL: 603 893 5376  
FAX: 603 893 5396  
mis@harwin.com

HARWIN Europe (UK)  
TEL: 023 9231 4545  
FAX: 023 9231 4590  
mis@harwin.co.uk

HARWIN Asia  
TEL: +65 6 779 4909  
FAX: +65 6 779 3868  
mis@harwin.com.sg

THIS DRAWING AND ANY  
INFORMATION OR DESCRIPTIVE  
MATTER SET OUT HEREON ARE  
CONFIDENTIAL AND COPYRIGHT  
PROPERTY OF THE HARWIN  
GROUP AND MUST NOT BE  
DISCLOSED, LOANED, COPIED  
OR USED FOR MANUFACTURING,  
TENDERING OR FOR ANY  
OTHER PURPOSE WITHOUT  
THEIR WRITTEN PERMISSION.

~~TOLERANCES~~  
X =  $\pm 1$ mm  
X.X =  $\pm 0.25$ mm  
X.XX =  $\pm 0.10$ mm  
X.XXX =  $\pm 0.075$ mm  
ANGLES =  $\pm 5^\circ$   
UNLESS STATED

MATERIAL:  
SEE ABOVE  
FINISH: SEE ABOVE  
S/AREA: mm<sup>2</sup>

TITLE:  
1.27mm PITCH SIL SURFACE  
MOUNT PIN HEADER (5 WAY)

DRAWING NUMBER:  
**M52-04000P0545**

SHT  
1 OF 1