

RECOMMENDED PCB LAYOUT

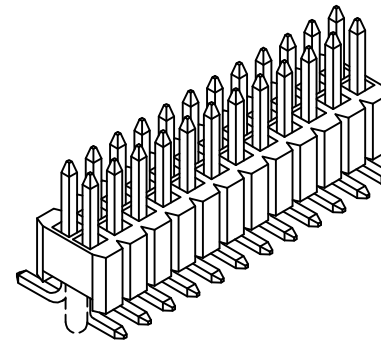
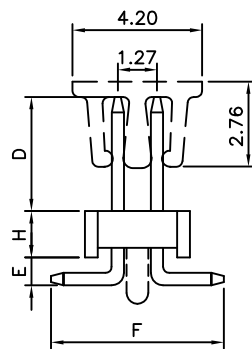
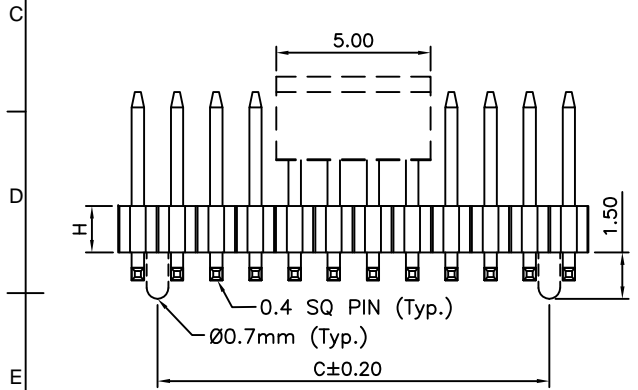

CONTACTS	DIMENSIONS		
	A	B	C
6	2.54	3.81	1.27
8	3.81	5.08	2.54
10	5.08	6.35	3.81
12	6.35	7.62	5.08
14	7.62	8.89	6.35
16	8.89	10.16	7.62
18	10.16	11.43	8.89
20	11.43	12.70	10.16
22	12.70	13.97	11.43
24	13.97	15.24	12.7
26	15.24	16.51	13.97
28	16.51	17.78	15.24
30	17.78	19.05	16.51
32	19.05	20.32	17.78
34	20.32	21.59	19.05
36	21.59	22.86	20.32
38	22.86	24.13	21.59
40	24.13	25.40	22.86
42	25.40	26.67	24.13
44	26.67	27.94	25.40
46	27.94	29.21	26.67
48	29.21	30.48	27.94
50	30.48	31.75	29.21
52	31.75	33.02	30.48
54	33.02	34.29	31.75
56	34.29	35.56	33.02
58	35.56	36.83	34.29
60	36.83	38.10	35.56
62	38.10	39.37	36.83
64	39.37	40.64	38.10
66	40.64	41.91	39.37

SPECIFICATIONS 规格:

CURRENT RATING 电流额定值: 1 AMP
 INSULATOR RESISTANCE 绝缘电阻值: 1000 MEGOHMS MIN.
 DIELECTRIC WITHSTANDING 耐电压: AC 300 V
 CONTACT RESISTANCE 接触电阻值: 20mΩ Max.
 OPERATING TEMPERATURE 工作温度: -40°C TO +105°C
 CONTACT MATERIAL 端子物料: COPPER ALLOY
 INSULATOR MATERIAL 绝缘体物料:

OPTIONS 可选物料: POLYESTER 聚酯,
 LCP, UL 94-V0 (INSULATOR HEIGHT/塑胶高度 H = A, B, L, F)
 OPTIONS 可选物料: POLYAMIDE 聚酰胺,
 NYLON 6T, UL 94-V0 (INSULATOR HEIGHT/塑胶高度 H = K)

SOLDERING PROCESS 可焊性:
 LCP (OPTION 可选物料) -
 IR REFLOW 回流焊: 260°C for 10 sec.
 WAVE 波峰焊: 250°C for 5-10 sec
 MANUAL SOLDER 人工焊接: 350°C for 3-5 sec

NYLON 6T (OPTION 可选物料) -
 IR REFLOW 回流焊: 260°C for 10 sec.
 WAVE 波峰焊: 230°C for 5-10 sec.
 MANUAL SOLDER 人工焊接: 350°C for 3-5sec

MATES WITH 配套之母座 (SUBJECT TO PIN LENGTH 在端子长度适合的条件下):
 BD050 BD055 BD060 BD064 BD065
 BD067 BD091

By	LYH	PN	CB	AE	AE	SA
DETAIL	DRAWING RELEASE	AMENDMENT TO SPEC & PACKING OPTIONS CHANGED	NO. OF CONTACTS AMENDED & PACKING OPTIONS CHANGED	SOLDER TEMP & MATES WITH INFO. UPDATED	INSULATOR MATERIAL UPDATED FOR SPECIFIC INSULATOR HEIGHTS	AMENDMENT TO STANDARD DIMENSIONS
REV DATE	A 28/12/07	B 27/04/09	C 20/05/09	D 27/07/09	E 07/08/09	F 08/12/09

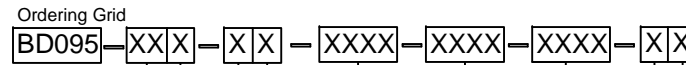

No. of Contacts
 06 to 66

Contact Plating
 A = Gold Flash All Over
 B = Selective Gold Flash Contact Area/
 Tin On Tail
 C = Tin All Over
 G = 10µ" Gold Contact Area/Tin On Tail
 I = 30µ" Gold Contact Area/Tin On Tail
Standard = Gold Flash All Over

Insulator Height "H"
 K = 1.00mm
 A = 1.50mm
 B = 2.00mm
 L = 2.50mm
 F = 3.00mm
Standard = 1.50mm

Dimension D (1/100mm)
 (Post Height)
Standard - 2.00mm = 0200
Standard - 3.50mm = 0350
 or specify Dimension D
 e.g. 2.50mm = 0250
 Tol +/- 0.2mm

Dimension E (1/100mm)
 (PCB to Insulator)
Standard - 0.70mm = 0070
 Minimum - 0.70mm = 0070
 or specify Dimension E
 e.g. 2.50mm = 0250
 Tol +/- 0.2mm

REQUEST SAMPLES AND QUOTATION

Packing Options
B = Tape and Reel with Cap (Standard)
 D = Tube
 E = Tube with Cap

Dimension F (1/100mm)
 (Width of Footprint)
Standard - 5.70mm = 0570
 or specify Dimension F
 e.g. 2.50mm = 0250
 Tol +/- 0.2mm



Tolerances (Except as noted)	Part Number:-	Date:-
Dimensions in mm	BD095	28 DEC 07
X. ± 0.30	Description:- 1.27mm PITCH PIN HEADER, DUAL ROW, SURFACE MOUNT, VERTICAL	THIS DRAWING IS CONFIDENTIAL AND MUST NOT BE COPIED OR DISCLOSED WITHOUT WRITTEN CONSENT
X.X ± 0.20		
X.XX ± 0.15		
X.XXX ± 0.10		
X.X ± 5°		
X.X ± 2°		
.XX ± 1°		
.XXX ± 0.5°		
Third Angle Projection		

GCT

www.globalconnectortechology.com

Scale	Revision	Material	Drawn by	Sheet No.
NTS	F	See Note	LYH	E & OE
			E & OE	1/1