

Global Connector Technology Ltd. - BC050: 1.00mm PITCH ELEVATED PIN HEADER, DUAL ROW, SURFACE MOUNT, VERTICAL

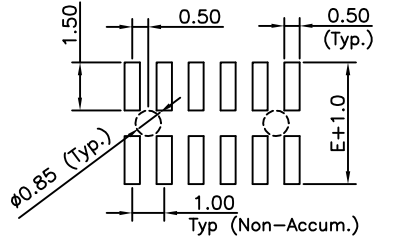

RECOMMENDED PCB LAYOUT

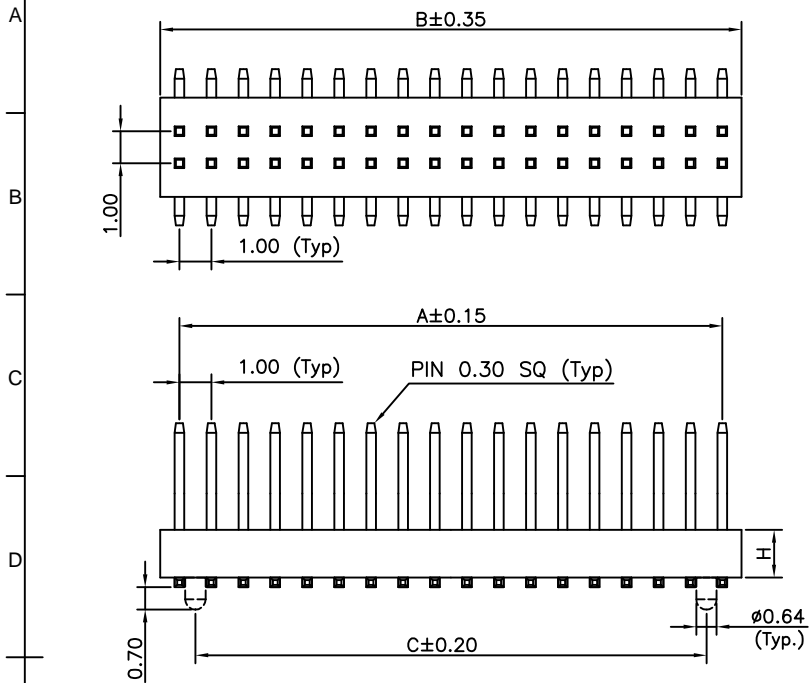
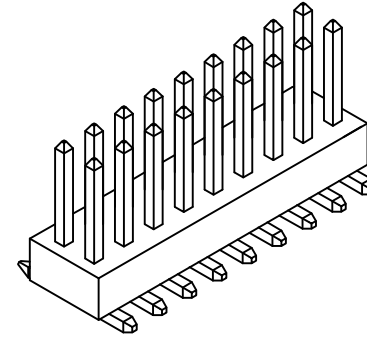
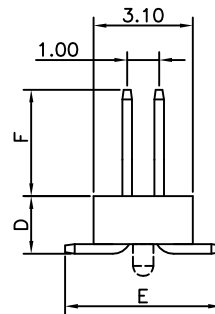

CONTACTS	DIMENSIONS		
	A	B	C
4	1.00	2.00	---
6	2.00	3.00	---
8	3.00	4.00	---
10	4.00	5.00	3.00
12	5.00	6.00	4.00
14	6.00	7.00	5.00
16	7.00	8.00	6.00
18	8.00	9.00	7.00
20	9.00	10.00	8.00
22	10.00	11.00	9.00
24	11.00	12.00	10.00
26	12.00	13.00	11.00
28	13.00	14.00	12.00
30	14.00	15.00	13.00
32	15.00	16.00	14.00
34	16.00	17.00	15.00
36	17.00	18.00	16.00
38	18.00	19.00	17.00
40	19.00	20.00	18.00
42	20.00	21.00	19.00
44	21.00	22.00	20.00
46	22.00	23.00	21.00
48	23.00	24.00	22.00
50	24.00	25.00	23.00
52	25.00	26.00	24.00
54	26.00	27.00	25.00
56	27.00	28.00	26.00
58	28.00	29.00	27.00
60	29.00	30.00	28.00
62	30.00	31.00	29.00
64	31.00	32.00	30.00
66	32.00	33.00	31.00
68	33.00	34.00	32.00
70	34.00	35.00	33.00
72	35.00	36.00	34.00
74	36.00	37.00	35.00
76	37.00	38.00	36.00
78	38.00	39.00	37.00
80	39.00	40.00	38.00

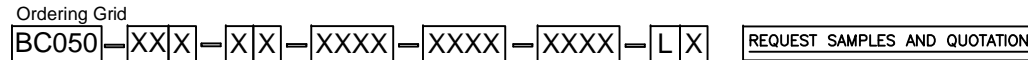

No. of Contacts
04 to 80

Contact Plating
A = Gold Flash All Over
C = Tin All Over
Standard = Gold Flash All Over

Locating Peg
0 = No Peg
1 = With Peg

Packing Options
B = Tape and Reel with Cap (Standard)

D = Tube
E = Tube with Cap

Insulator Material
L = LCP (Standard)

Dimension E (1/100mm)
(Footprint Width)
Standard - 4.80mm = 0480
or specify Dimension E
e.g. 2.50mm = 0250
Tol ± 0.2 mm

Dimension F (1/100mm)
(Post Height)
Standard - 2.00mm = 0200
Standard - 3.80mm = 0380
or specify Dimension C
e.g. 2.50mm = 0250
Tol ± 0.2 mm

Dimension D (1/100mm)
(Top of Insulator to Bottom of Pin)
Standard - 1.60mm = 0160
or specify Dimension D
e.g. 2.50mm = 0250
Tol ± 0.2 mm

SPECIFICATIONS 规格:

CURRENT RATING 电流额定值: 1 AMP
INSULATOR RESISTANCE 绝缘电阻值: 1000 MEGOHMS MIN.
DIELECTRIC WITHSTANDING 耐电压: AC 300 V
CONTACT RESISTANCE 接触电阻值: 20m Ω Max.
OPERATING TEMPERATURE 工作温度: -40°C TO +105°C
CONTACT MATERIAL 端子物料: COPPER ALLOY
INSULATOR MATERIAL 绝缘体物料:
STANDARD 标准物料: POLYESTER 聚酯, LCP, UL 94-V0
SOLDERING PROCESS 可焊性:
LCP (STANDARD 标准物料) -
IR REFLOW 回流焊: 260°C for 10 sec. Δ
WAVE 波峰焊: 250°C for 5-10 sec
MANUAL SOLDER 人工焊接: 350°C for 3-5 sec Δ

MATES WITH 配套之母座 (SUBJECT TO PIN LENGTH 在端子长度适合的条件下):
BC084 BC085

By	AE	GG	AE	SA	SA
DETAIL	DRAWING RELEASE	CHANGE TO SOLDER TEMP. INFORMATION	STANDARD HEIGHT 'H' AMMENDED	AMMENDMENT TO STANDARD DIMENSIONS	AMMENDMENT TO PLATING OPTIONS
REV DATE	A 20/05/08	B 23/07/09	C 30/09/09	D 08/12/09	E 21/12/09



Tolerances (Except as noted)	Part Number:-	Date:-
Dimensions in mm	BC050	20 MAY 08
X. ± 0.30	Description:- 1.0mm PITCH PIN HEADER, DUAL ROW, SURFACE MOUNT, VERTICAL	THIS DRAWING IS CONFIDENTIAL AND MUST NOT BE COPIED OR DISCLOSED WITHOUT WRITTEN CONSENT
X.X ± 0.25		
X.XX ± 0.15		
X.XXX ± 0.10		
X. $^{\circ} \pm 5^{\circ}$		
X.X $\pm 3^{\circ}$		
X.XX $\pm 2^{\circ}$		
X.XXX $\pm 1^{\circ}$		

GCT

www.globalconnectortechology.com

Scale	Revision	Material	Drawn by	Sheet No.
NTS	E	See Note	AE	E & OE 1/1