

A B C D E F

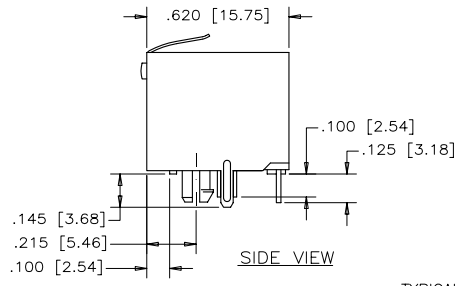

REVISIONS				
SYM	ZONE	ECN, ERN NO.	DATE	APPRD.
E		REVISED PROPOSAL	05/06/08	L.CHAN
F		PER ECN E08063	APR8/08	L.CHAN

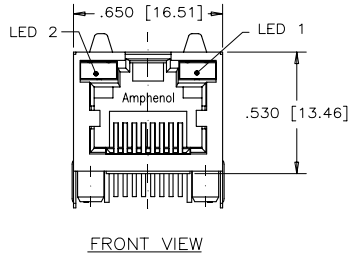
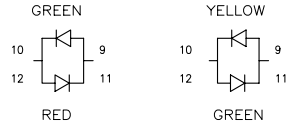

BI-COLOUR LED DETAIL  
(RED/YELLOW AND GREEN/ORANGE LED'S ARE ALSO AVAILABLE)

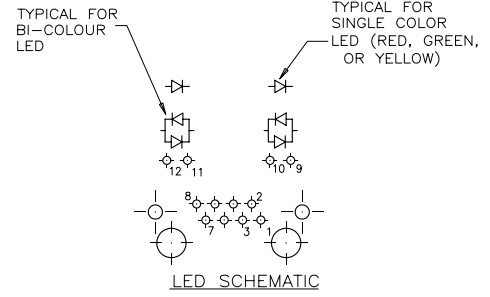
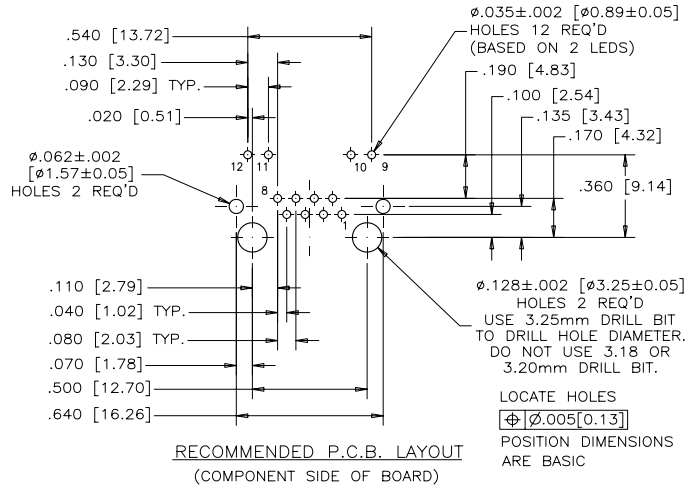

**MATERIALS:**  
 PLASTIC HOUSING: ENGINEERING THERMOPLASTIC  
 FLAMMABILITY RATING UL 94V-0  
 COLOR: BLACK  
**CONTACTS:**  
 PHOSPHOR BRONZE  
 PLATING: 50 µ" [1.27 MICRONS]  
 MIN. GOLD ON MATING SURFACES.  
 50 µ" [1.27 MICRONS]  
 MIN. NICKEL UNDERPLATE  
 100 µ" [2.54 MICRONS]  
 MIN. TIN/LEAD ON CONTACT TAILS.  
**SHIELD:**  
 COPPER ALLOY  
 PLATING: TIN-LEAD

**PART NUMBER:** RJHS-538X  
 REFER TO LED OPTIONS DRAWING FOR ORDERING CODES

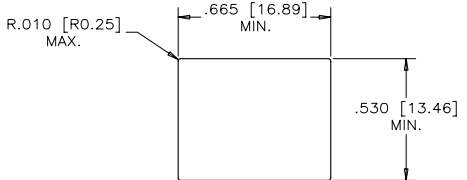

DRAWN A.KARIR	DATE 99/11/10	<b>Amphenol Canada Corp.</b> TITLE HIGH SPEED, RJ45, MODULAR JACK, 8 POSITION, 8 CONTACTS, SHIELDED, WITH LEDS
DESIGNED		
CHECKED R.PIKE	99/11/11	
I. E. APPRD.		
Q. A. APPRD.		DWG. DRAWING NO.
DWG. APPRD.		P-RJHS-538X
ENG. REL. NO. EAR 12778		SCALE
REF.		WT. -----
DIMENSIONS ARE IN INCHES [mm]	CODE ID. NO. 03554	SURF. -----
		SHEET 1 OF 1

THIS DOCUMENT CONTAINS PROPRIETARY INFORMATION AND SUCH INFORMATION MAY NOT BE DISCLOSED TO OTHERS FOR ANY PURPOSE OR USED FOR MANUFACTURING PURPOSES WITHOUT WRITTEN PERMISSION FROM AMPHENOL CANADA CORP.

A B C D E F