

REV.	ZONE	LTR	DESCRIPTION	DATE	REVISER	APPD
------	------	-----	-------------	------	---------	------

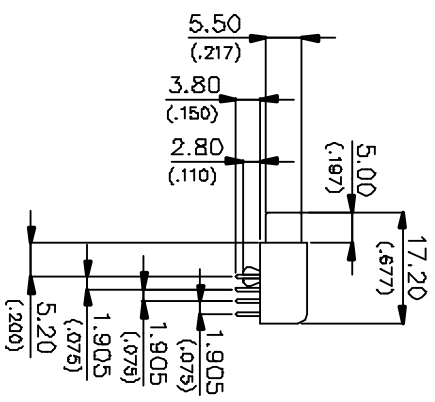
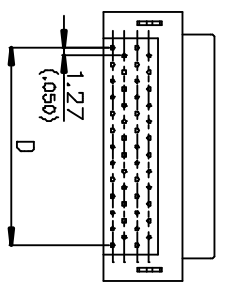
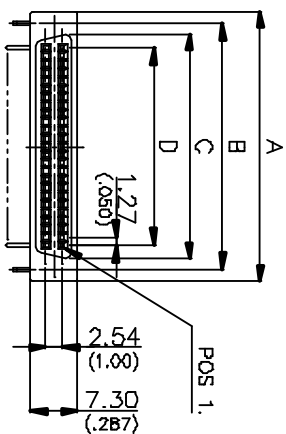
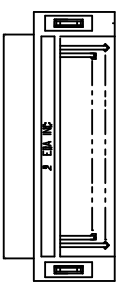

**SPECIFICATIONS :**

INSULATOR MATERIAL : P.B.T & GLASS-FIBER REINFORCED  
 UL 94V-0  
 CONTACT MATERIAL : PHOSPHOR BRONZE , GOLD OVER NICKEL  
 INSULATION RESISTANCE : 500 MΩ MIN  
 CONTACT RESISTANCE : 35 mΩ MAX.  
 DIELECTRIC WITHSTANDING VOLTAGE : AC 250V FOR 1 MINUTE.  
 OPERATING TEMPERATURE : -55°C ~ +105°C

8AL 050 S - 3 2 0 1 0 - 10  
 (1) (2) (3) (4) (5) (6) (7) (8) (9)

1. SERIES NUMBER :  
 8AL : HIGH DENSITY 1.27(.050") SPACING MINI CONNECTOR R/A P.C.B ALL PLASTIC TYPE
2. NO OF CONTACTS :  
 EX 050 : 50 POSITIONS
3. CONTACT TYPE :  
 P : PLUG S : SOCKET
4. COLOR (INSULATOR) :  
 3 : BLACK
5. CONTACT FINISH :  
 0 : SELECTED GOLD FLASH OVER 30μ" NICKEL  
 1 : 15μ" SELECTED GOLD OVER 50μ" NICKEL  
 2 : 30μ" SELECTED GOLD OVER 50μ" NICKEL
6. METAL SHELL FINISH :  
 0 : ALL PLASTIC (W/O METAL SHELL)  
 1 : TIN PLATED SHELL, WITH GROUNDING INDENTS  
 2 : TIN PLATED SHELL, W/O GROUNDING INDENTS  
 3 : NICKEL PLATED SHELL, W/O GROUNDING INDENTS  
 5 : NICKEL PLATED SHELL, WITH GROUNDING INDENTS

7. METAL SHELL FINISH :  
 MATING HOLES
- A : 4-40 UNC  
 B : 4-40 UNC  
 C : 4-40 UNC  
 D : 2-56 UNC  
 E : 2-56 UNC  
 F : 2-56 UNC  
 G : M2.6 \* 0.45  
 H : M2.6 \* 0.45  
 J : \_\_\_\_\_
- MOUNTING HOLES  
 4-40 UNC  
 2-56 UNC  
 HARPOON  
 2-56 UNC  
 4-40 UNC  
 HARPOON  
 M2.6 \* 0.45  
 HARPOON
8. BRACKET TYPE :  
 0 : W/O BRACKET  
 1 : WITHOUT RAILS, WITH LATCH BLOCKS  
 2 : WITH RAILS & LATCH BLOCK  
 3 : WITHOUT RAILS & LATCH BLOCKS
9. SUFFIX NUMBER :  
 10 : EDA LOGO

MATERIAL	D	C	B	A	POS	PART NO.
	41.91 (1.650)	48.13 (1.813)	48.31 (1.941)	53.13 (2.095)	68	8AL068S-320J0-10
	30.48 (1.200)	10.96 (1.386)	37.88 (1.491)	41.70 (1.642)	50	8AL050S-320J0-10

TOLERANCE UNSPECIFIED		± 0.25	
∠	∠	∠	∠
∠	∠	∠	∠
∠	∠	∠	∠
∠	∠	∠	∠
∠	∠	∠	∠

FINISH	
DESIGNER	高橋 淳 88.06.17
CHECKED	
APPROVED	
NAME	EDA INC.
SCALE	1.25:1
UNIT	mm(Inch)
SHEET	8AL SERIES 1.27(.050) R/A P.C.B
REV.	ALL PLASTIC TYPE(Rec)
DRAWING NO	R-S18AL-3

A3 RSTBAR31