



ALL RIGHTS RESERVED. NO PORTION OF THIS PUBLICATION, WHETHER IN WHOLE OR IN PART CAN BE REPRODUCED WITHOUT THE EXPRESS WRITTEN CONSENT OF SPC TECHNOLOGY.

SPC-F005.DWG

REVISIONS

DOC. NO. SPC-F005 * Effective: 7/8/02 * DCP No: 1398

DCP #	REV	DESCRIPTION	DRAWN	DATE	CHECKD	DATE	APPRVD	DATE
162	A	Released	JWM	1/29/98	JC	2/4/98	BB	2/5/98
1780	B	RoHS Added	DCM	10/16/06	JWM	10/17/06	JWM	10/17/06

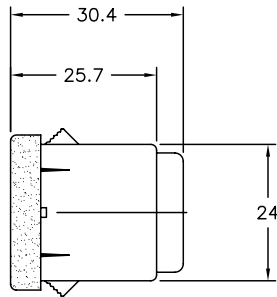
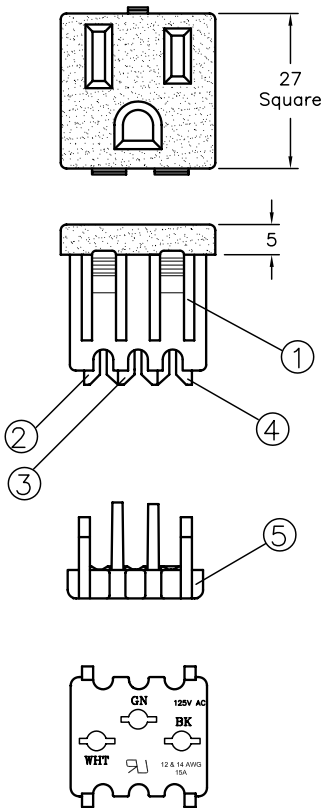

ASSEMBLY

Rated:15A @ 125V AC

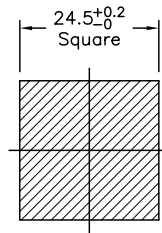

RECOMMENDED PANEL CUTOUT
Panel Thickness: 0.8 ~ 1.8mm
RECOMMENDED TO USE 12 & 14 AWG

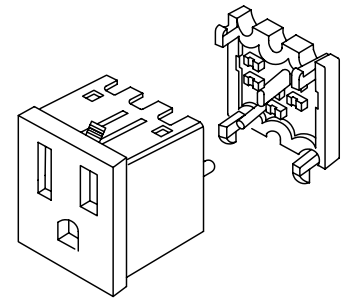

NOTE: PRODUCT SHIPPED UNASSEMBLED

5	Cover back of the Body, Nylon, Black Color.	1
4	Contact PIN Bronze Strip t=0.7mm Cu	1
3	Contact PIN Bronze Strip t=0.7mm Cu	1
2	Contact PIN Bronze Strip t=0.7mm Ni-Plated	1
1	Body Insulator NYLON Black Color	1

DISCLAIMER:
ALL STATEMENTS AND TECHNICAL INFORMATION CONTAINED HEREIN ARE BASED UPON INFORMATION AND/OR TESTS WE BELIEVE TO BE ACCURATE AND RELIABLE. SINCE CONDITIONS OF USE ARE BEYOND OUR CONTROL, THE USER SHALL DETERMINE THE SUITABILITY OF THE PRODUCT FOR THE INTENDED USE AND ASSUME ALL RISK AND LIABILITY WHATSOEVER IN CONNECTION THEREWITH.

TOLERANCES:

UNLESS OTHERWISE
SPECIFIED: ± 0.50

DRAWN BY:	DATE:
Jeff McVicker	1/29/98
CHECKED BY:	DATE:
John Cole	2/4/98
APPROVED BY:	DATE:
Brett Braatz	2/5/98

DRAWING TITLE:

NEMA 5-15R Power Outlet, IDC Terminals, Snap-In Mount

SIZE	DWG. NO.	ELECTRONIC FILE	REV
A	2143	92N4146.dwg	B
SCALE:	NTS	U.O.M.: Millimeters	SHEET: 1 OF 1