

This document is the property of Amphenol Corporation and is delivered on the express condition that it is not to be disclosed, reproduced or used in whole or in part, for manufacture or sale, by anyone other than Amphenol Corporation without its prior consent, & that no right is granted in drawing or to use any information in this document.

REVISIONS				
SYM	ECN	DESCRIPTION	DATE	APPROVED
1	HK5456	New Release	11/13/08	IP

Customer Drawing

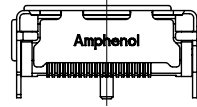
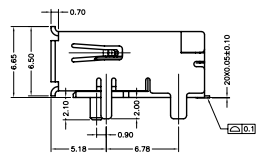
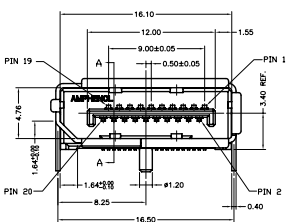
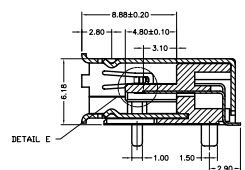
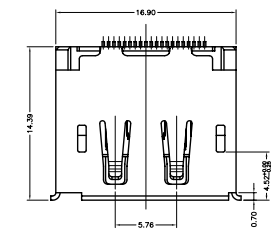

- NOTES:**
- MATERIAL:**
HOUSING: HIGH TEMPERATURE PLASTIC UL94V-0, BLACK.
CONTACT: PHOSPHOR BRONZE, THICKNESS=0.20mm
SHIELD: BRASS OR SPCC, THICKNESS=0.4mm
 - FINISH:**
CONTACT: REFER TO P/N SYSTEM ON MATING AREA
1.27~2.54um NICKEL UNDERPLATE OVERALL
2.54~5.08um PURE TIN ON SOLDER TAIL
SHIELD: REFER TO P/N SYSTEM
 - ELECTRICAL SPECIFICATION:**
CURRENT RATING: 0.5A
CONTACT RESISTANCE: 30mΩ MAX
INSULATOR RESISTANCE: 100MΩ MIN(UNMATED) 10MΩ MIN(MATED)
DIELECTRIC WITHSTANDING VOLTAGE: 500 V AC(UNMATED) 300 V AC(MATED)
 - ORDER P/N SYSTEM: DP-F201-001-X-X-XX**
- MATING AREA PLATING:**
1- 0.76um MIN Au.
2- 0.38um MIN Au.
A- Gold FLASH
- PACKING METHOD:**
N/A- PACKING IN TRAY.
TR- PACKING IN TAPE AND REEL.
- SHELL PLATING:**
1- GOLD FLASH PLATED.
2- SOLDERABLE NICKEL PLATED.
3- TIN PLATED.
4- SOLDERABLE BLACK NICKEL PLATED.

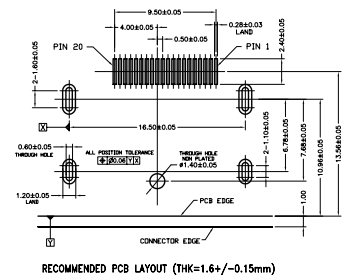
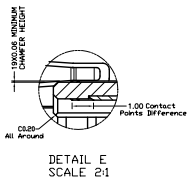
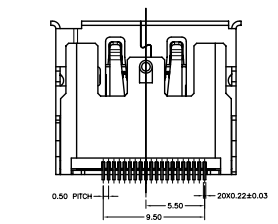

ITEM	PART NO.	REQ'D	DESCRIPTION
PARTS LIST			
UNLESS OTHERWISE SPECIFIED TOLERANCES		APPROVAL DATE	
U.S. METRIC		DRAWN Draft 11/13/08	
.X +/-		CHECKED Tony 11/13/08	
.XX +/-		CHECKED	
.XXX +/-		DRAWING FILE : Drawing/DP/DPF201001/001.DWG	
FRACTIONS +/-		ANGLE OF PROJECTION	
ANGLES +/-		REMOVE SHARP EDGES	
DIMENSIONS		SIZE DRAWING NO.	
U.S. INCHES		A3 C DP-F201-001-X-X-XX 1	
(METRIC) (MM)		SCALE NONE SHEET 1 OF 1	

Amphenol

TITLE
DISPLAYPORT R/A SMT RECEPTACLE (SHELL DIP)