

## TECHNICAL SPECIFICATIONS

- Material:** Zinc, Nickel plated
- Operating Temperature:** -30°C to 90°C
- Cable Entry:** Side
- Thumbscrews:** UNC 4-40 (standard)  
M2,5/M2,6 or M3,0 on request
- Cable Diameter:** Up to 13,0 mm
- Screening Test:** SP Swedish National Testing and Research Institute
- Accessories:** See page 40-43

### Features:

- Available in sizes 9-15-25-37
- Excellent EMI Shielding
- Cable sizes from 4,3 mm up to 13,0 mm
- Re-openable
- Strain relief inserts ensure a secure termination

Screening Effectiveness - MHD45ZK-Series

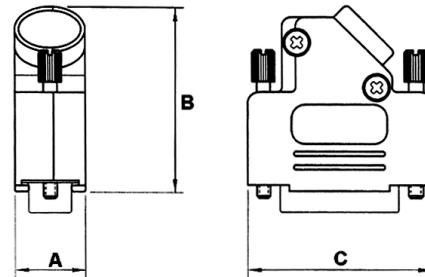
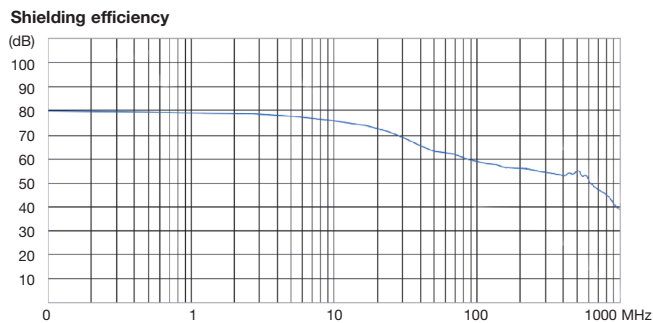

Size MHD45ZK	Dim A	Dim B	Dim C
9-way	14,5	36,3	31,0
15-way	14,5	40,3	39,5
25-way	14,5	40,3	53,2
37-way	14,5	40,3	69,7

## Order Code

**MHD45ZK - RAHI - XX - B - K**

- Series:** \_\_\_\_\_
- Style:** \_\_\_\_\_  
OMIT = Rapid Assembly  
RAHI = Metalized Rapid Assembly
- Size (xx):** 9,15,25, 37 \_\_\_\_\_
- Plating Select:** \_\_\_\_\_  
Omit = Nickel, **B** = Black Chromate
- Packing Style:** \_\_\_\_\_  
**K** = Individual Kit, Omit = Bulk

Fig. 1

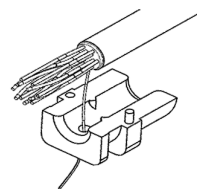

Fig. 2

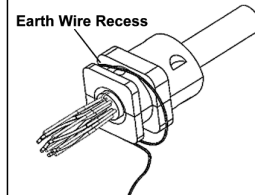
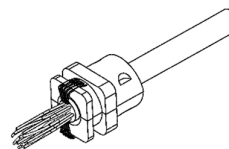
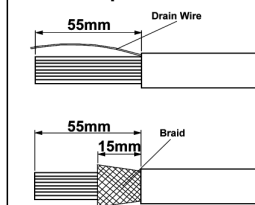

Fig. 3



Cable Preparations:



1. Prepare the cable as shown in Fig. 4 and assemble the connector
2. Choose the strain relief halves that closest match the cable O.D. and place it as shown in Fig. 1. Pull Drain wire through the hole and wrap it around as shown in Fig. 2
3. For Heavy Braided cable, pigtail the braid and pull it back over the assembled strain relief, as shown in Fig. 3
4. Place the assembly in the appropriate recess. Ensure that the cable is pressed into the strain relief piece.
5. Screw the two hood halves together.