

THE INFORMATION CONTAINED IN THIS DRAWING IS THE SOLE PROPERTY OF L-COM, INC. ANY REPRODUCTIONS IN PART OR WHOLE WITHOUT THE WRITTEN PERMISSION OF L-COM, INC. IS PROHIBITED.

REVISIONS			
REV	DESCRIPTION	DATE	APPROVED
D	ICON #1432 - CHG'D COMPONENT SPECIFICATION TABLE	11/09/05	B.MASSE/DA
E	REVISED HARDWARE DETAIL FROM #1389	11/08/05	MCCORMICK
F	REVISED ELECTRICAL SPEC	09/21/03	MCCORMICK
G	ICF#E 2008 REVISED SHEET TOLERANCE	01/17/07	MCCORMICK

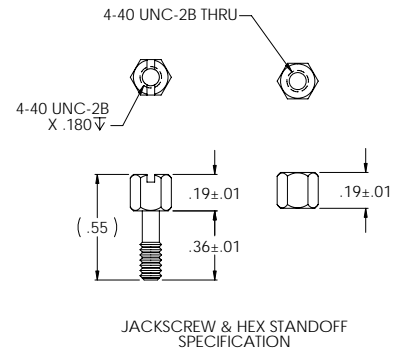
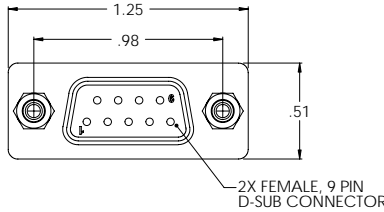
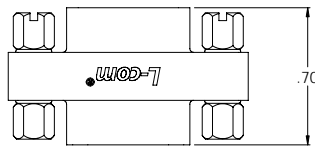
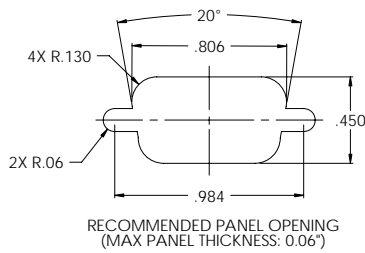

APPLICATION NOTES:
ALL PINS WIRED STRAIGHT THROUGH

LABELING:
PANTONE 2945 BLUE, "L-COM" FONT MyriaMM ITALIC,
"GENDER CHANGER" FONT ARIAL BOLD, TEXT HEIGHTS: .085"
TEXT COLOR: WHITE.

Component Specifications	
Material	
Shell	Steel
Contacts/Terminals	Copper Alloy
Hardware	Brass
Insulator	PBT Fiber Reinforced (UL 94V-0 Rated)
Finish	
Shell	Tin/Nickel Plated
Contacts/Terminals	Gold Flash Plated: 1 - 1.5µ inches
Hardware	Nickel Plated
Electrical	
Current Rating	3 AMP
Insulation Resistance	1000 MO Min @ 500 VDC
Dielectric Withstanding Voltage	1000 VAC (for One minute)
Environmental	
Operational Temperature Range	55°C to +105°C

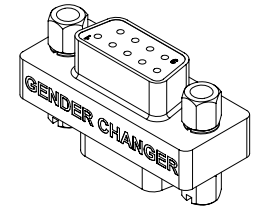
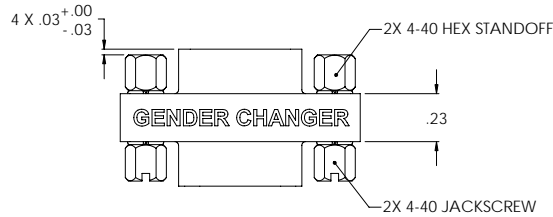

OUTLINE DRAWING

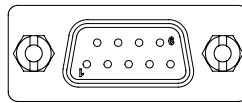

DIMENSIONS ARE IN INCHES (MM)
UNLESS OTHERWISE SPECIFIED,
TOLERANCES TO BE:
X .125 (3.175) ANGLES ±1°
X .125 (3.175) ANGLES ±1°
X .125 (3.175) ANGLES ±1°
X .125 (3.175) ANGLES ±1°
OVERALL CABLE LENGTH TOL:
#10115241 ±1.75 (44.28) / -0
#40115241 ±.25 (6.35) / -0

APPROVALS DATE
DRAWN BY D.PARRHAM 11/12/2005
CHECKED BY J.CLARK 11/12/2005
APPROVED BY J.CARRICK 11/13/2005

L-com 45 BEECHWOOD DRIVE NORTH ANDOVER, MA 01845	
CATEGORY	D-SUBMINIATURE
PRODUCT DESCRIPTION	GENDER CHANGER, DB9 FEMALE/FEMALE
REV	DWG. NO.
B	43321
SCALE: 2:1	CAD FILE: DGB9F-OD1.SLDRW
SHEET 1 OF 1	REV G

CONFIGURATION DETAILS OF UNDIMENSIONED FEATURES MAY VARY