

nominal voltage: 1,2V
max. charge voltage: 1,5V

capacity
 nominal : 800mAh
 >700mAh
 minimal: 750mAh

max. continuous discharge current: 1600mA

charge
 standard charge: 80mA
 quick charge: 400mA
 fast charge: 800mA

recommended charge
 termination control
 parameters: -dV: 5...10mV
 dT/dt: 0,8...1°C per min
 TCO: 40...50°C

trickle charge current: 8...40mA (recommended)

continuous overcharge: ≤40mA (less than 1 year) no conspicuous deformation, no leakage

internal resistance: ≤45mOhms at 1000Hz, battery fully charged

life expectancy: >500 cycles IEC standard

self discharge
 charge retention: >75% after 12months storage at 20°C

ambient temperature range: 0...45°C standard charge
 0...40°C fast charge
 -20...65°C discharge
 -20...50°C storage less than 30 days
 -20...40°C storage less than 3 months
 -20...35°C storage less than 1 year

conditions

at standard charge (0,1C / 20°C)

discharge at 0,2C
 discharge at 1C
 discharge at 0,2C
 1,0V end discharge voltage
 ambient temperature 20°C

ambient temperature 20...50°C

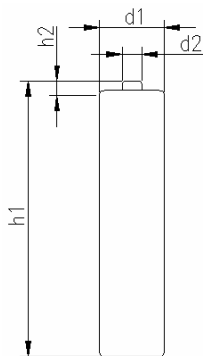
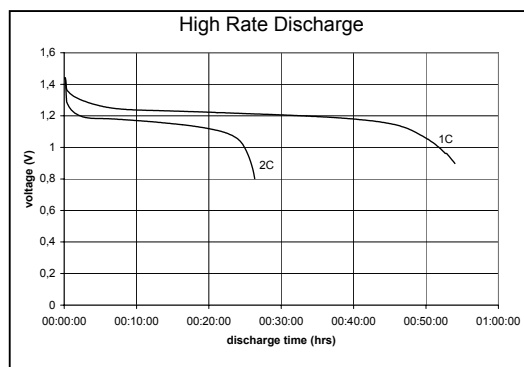
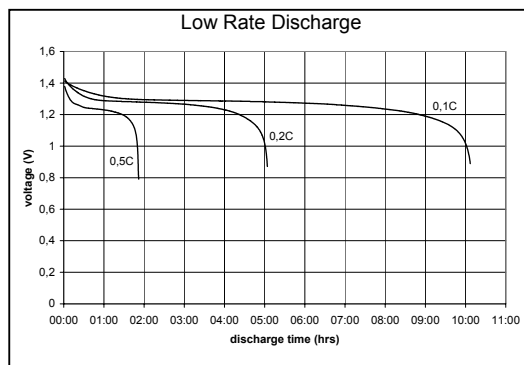
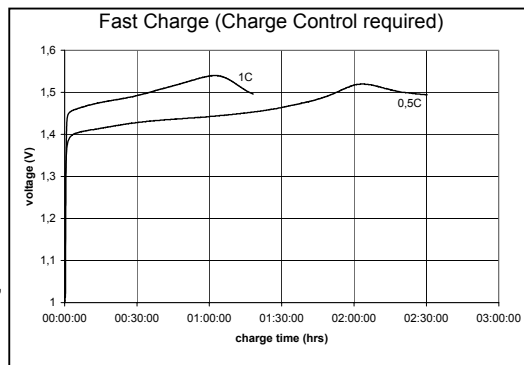
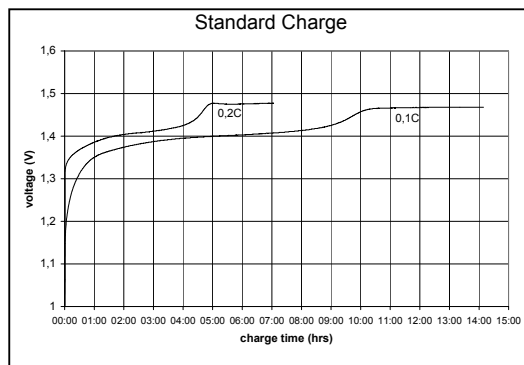

mechanical specifications

cell dimensions (with sleeve)
 diameter d1: 10,5 – 0,7mm
 diameter d2: max. 3,8mm
 height h1: 44,5 – 1,5mm
 height h2: min. 0,8mm
 weight: approx. 13g

	specifications for model/type:	AAA – NiMH 800mAh Max e (2pcs)
		low self discharge cell
	Ansmann drawing number / part number:	5030982
	drawn by / date:	Gramlich / 13.09.2006