

**nominal voltage:** 1,2V  
**max. charge voltage:** 1,5V

**capacity**  
 nominal : 5000mAh  
 minimum: 5000mAh  
 4600mAh

**max. continuous discharge current:** 2500mA

**charge**  
 standard charge: 500mA  
 rapid charge: 2500mA

**recommended charge**  
 termination control parameters:  
 -dV: 0...5mV  
 dT/dt: 0,8...1°C per min  
 TCO: 45...50°C

**trickle charge current:** 50...250mA (recommended)

**continuous overcharge:** ≤500mA (less than 1 year)

**internal resistance:** ≤25mOhms

**life expectancy:** >500 cycles

**ambient temperature range:** 0...45°C  
 10...40°C  
 -20...60°C  
 -20...35°C

conditions  
 at standard charge (0,1C / 20°C)  
 discharge at 0,2C  
 discharge at 0,2C  
 discharge at 0,5C  
 1,0V end discharge voltage  
 ambient temperature 20°C  
 ambient temperature -20...60°C  
 charge current charge time  
 500mA 16hrs  
 2500mA 2,2hrs  
 at 1000Hz, battery fully charged  
 IEC standard  
 standard charge  
 rapid charge  
 discharge  
 storage less than 6 months

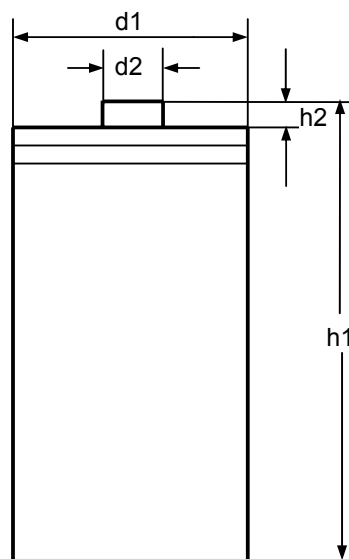
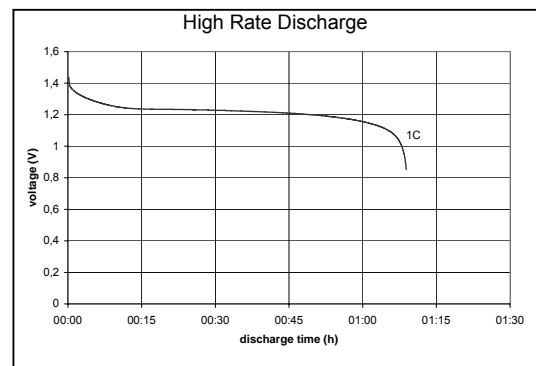
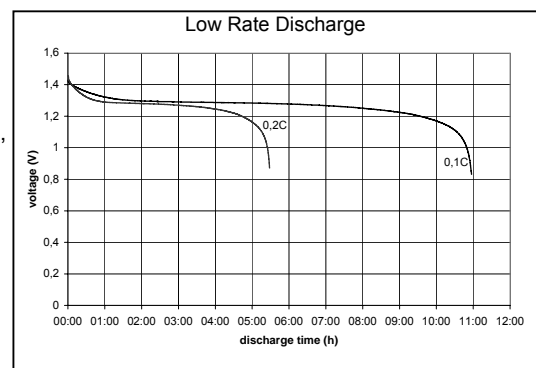
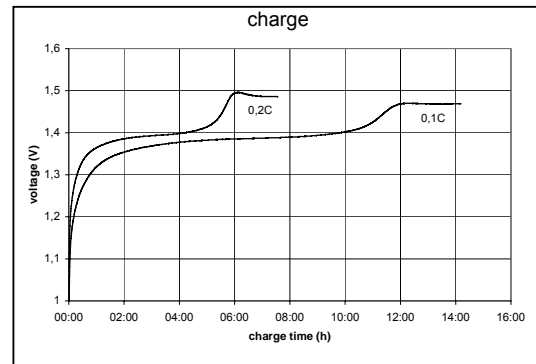

**mechanical specifications**  
 cell dimensions (with sleeve)  
 diameter d1: 33,0 -1,0mm  
 diameter d2: 9,5 -2,5mm  
 height h1: 61,5 -2,0mm  
 height h2: min. 1,5mm  
 weight: approx. 108g

	specifications for model/type:	D – NiMH 5000mAh
	Ansmann drawing number / part number:	5030921
	drawn by / date:	Brandt / 10.04.2006