

nominal voltage: 1,2V
max. charge voltage: 1,5V

capacity
 nominal : 4500mAh
 minimum: 3700mAh
 4200mAh

max. continuous discharge current: 4500mA

charge
 standard charge: 450mA
 rapid charge: 1000mA
 fast charge: 2250mA

recommended charge termination control parameters:
 -dV: 0....5mV
 dT/dt: 0,8....1°C per min
 TCO: 45....50°C

trickle charge current: 45....225mA (recommended)

continuous overcharge: ≤450mA (less than 1 year)

internal resistance: <18mOhms

life expectancy: >500 cycles

ambient temperature range: 0....45°C
 10....40°C
 -20....60°C
 -20....35°C
 -20....45°C

conditions
 at standard charge (0,1C / 20°C)
 discharge at 0,2C
 discharge at 1C
 discharge at 0,2C
 1,0V end discharge voltage
 ambient temperature 20°C

ambient temperature 20....50°C

charge current charge time
 450mA 16hrs at 20°C
 1000mA 5hrs
 2250mA 2,2hrs

at 1000Hz,
 battery fully charged

IEC standard

standard charge
 fast charge
 discharge
 storage less than 6 months
 storage less than 1 month

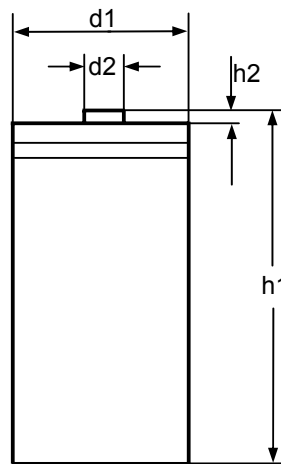
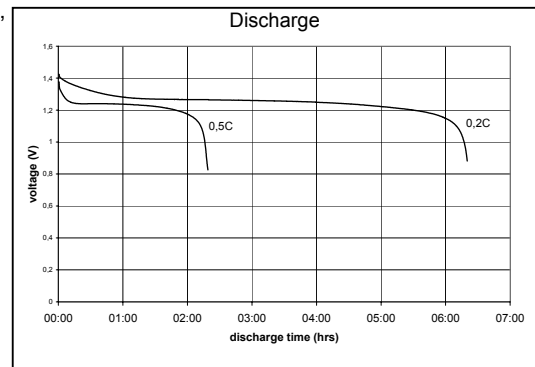
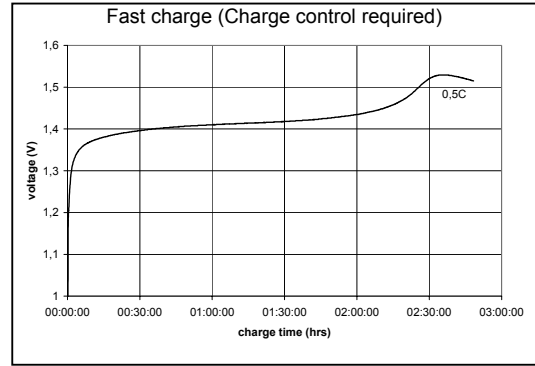
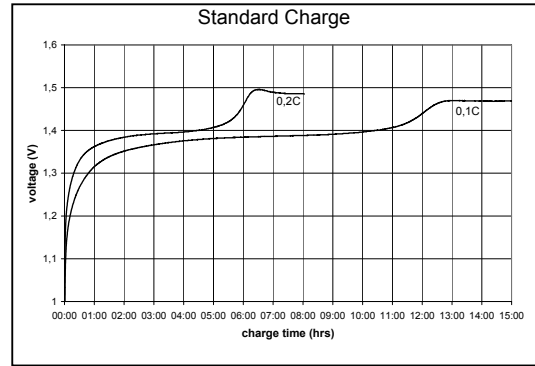

mechanical specifications
 cell dimensions (with sleeve)
 diameter d1: 26,0 – 1,0mm
 diameter d2: 7,5 - 2,5mm
 height h1: 50,0 -1,5mm
 height h2: min. 1,5mm
 weight: approx. 80g

	specifications for model/type:	C – NiMH 4500mAh
	Ansmann drawing number / part number:	5030621
	drawn by / date:	Gramlich / 27.12.2005