

nominal voltage: 1,2V
max. charge voltage: 1,5V

capacity
 nominal : 2400mAh
 >2020mAh
 minimum: 2150mAh

max. continuous discharge current: 4600mA

charge
 standard charge: 240mA
 quick charge: 850mA
 fast charge: 2400mA

recommended charge termination control parameters:
 -dV: 5...10mV
 dT/dt: 0,8...1°C per min
 TCO: 40...50°C

trickle charge current: 20...100mA (recommended)

continuous overcharge: ≤100mA (less than 1 year)

internal resistance: approx. 25mOhms

life expectancy: >500 cycles

ambient temperature range: 0...45°C
 0...40°C
 0...50°C
 -20...50°C
 -20...40°C
 -20...30°C

conditions
 at standard charge (0,1C / 20°C)
 discharge at 0,2C
 discharge at 1C
 discharge at 0,2C
 1,0V end discharge voltage
 ambient temperature 20°C

ambient temperature 20...50°C

charge current charge time
 standard charge: 240mA 16hrs at 20°C
 quick charge: 850mA 3,25hrs
 fast charge: 2400mA 1,1hrs

at 1000Hz, battery fully charged

IEC standard

standard charge
 fast charge
 discharge
 storage less than 30 days
 storage less than 3 months
 storage less than 1 year

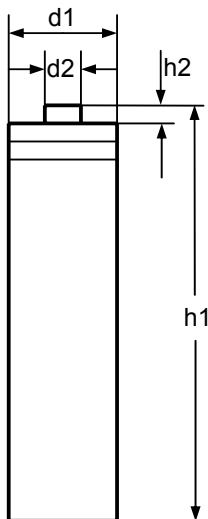
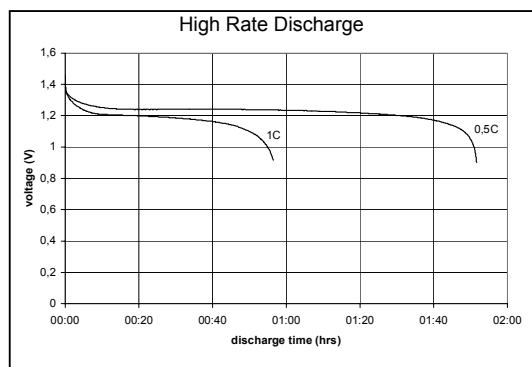
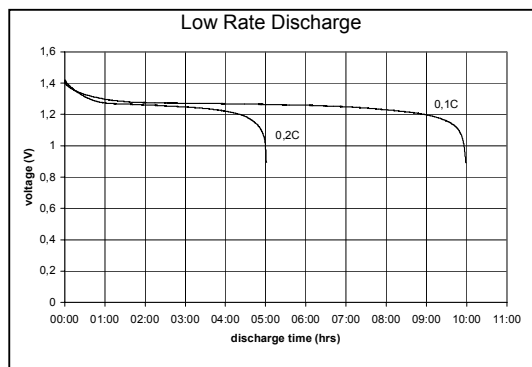
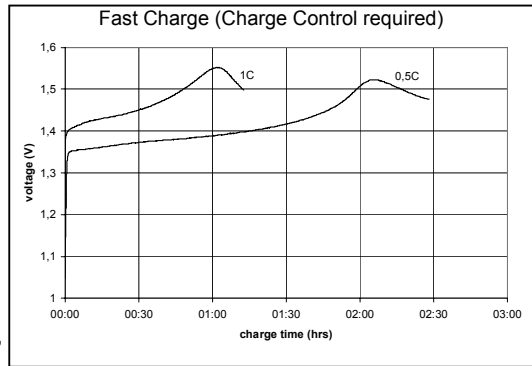
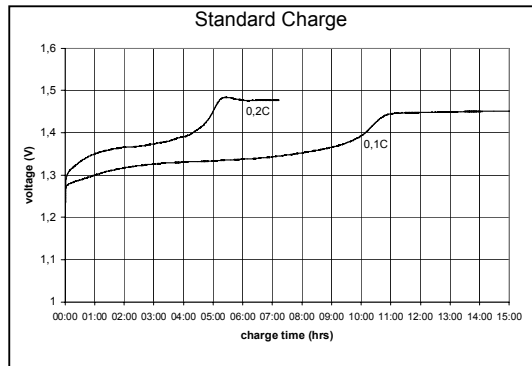

mechanical specifications
 cell dimensions (with sleeve)
 diameter d1: 14,35-0,4mm
 diameter d2: 5,5-0,5mm
 height h1: 50,4-0,5mm
 height h2: 1,8+/-0,3mm
 weight: approx. 30g

16

	specifications for model/type:	AA – NiMH 2400mAh
	Ansmann drawing number / part number:	5030531
	drawn by / date:	Gramlich / 21.10.2004

Manufacturer reserves the right to alter or amend the design, model and specification without prior notice