

DATA SHEET

DANTONA

DATA SHEET

Model No.: 1/2AAH-300

Specification

Nominal Voltage		1.2V	
Capacity (mAh)	Rate	0.2C	0.5C
	Nominal	300	270
	Typical	325	300
Approx Weight		10g	
Internal Resistance(at 1KHz)		≤ 45mΩ	
Charge	Standard	0.1C × 15hrs	
	Trickle	0.03C - 0.0625C	
Discharge cut-off voltage		1.0V	
Operation temp.	Standard charge	0 °C - 70 °C	
	Trickle charge	0 °C - 70 °C	
	Discharge	-20 °C - 70 °C	
Storage temp.	Within 6 month	-20 °C - 30 °C	
	Within a month	-20 °C - 40 °C	
	Within a week	-20 °C - 50 °C	
Relative humidity		65 ± 20%	

Dimension

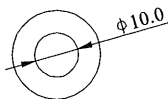
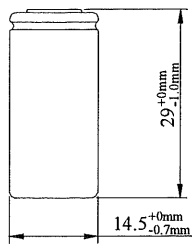

(with tube)

NOTE:

- Nominal capacity rated at 0.2C
- Other capacity are for reference
- Weight and internal resistance are for reference

Typical characteristics

Standard charge characteristics

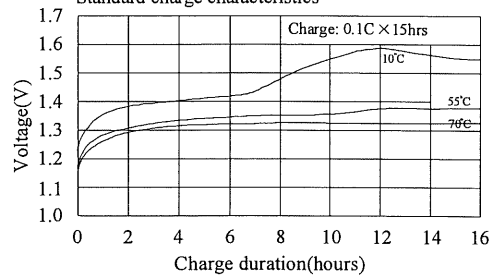

Discharge characteristics

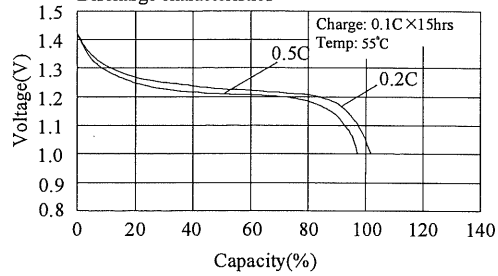

Charge efficiency after different charge rate

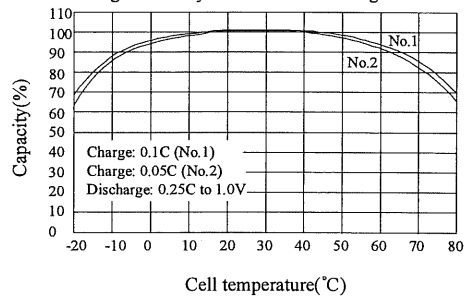

Capacity change in permanent charge

