



Eveready Battery Company, Inc.

533 Maryville University Drive  
 St. Louis, MO 63141  
 Telephone 1-800-383-7323  
 Internet: www.energizer.com

## Engineering Data

**Zinc Chloride 1.5V**  
**Super Heavy Duty**  
 No Added Mercury or Cadmium

### EVEREADY NO. 1250

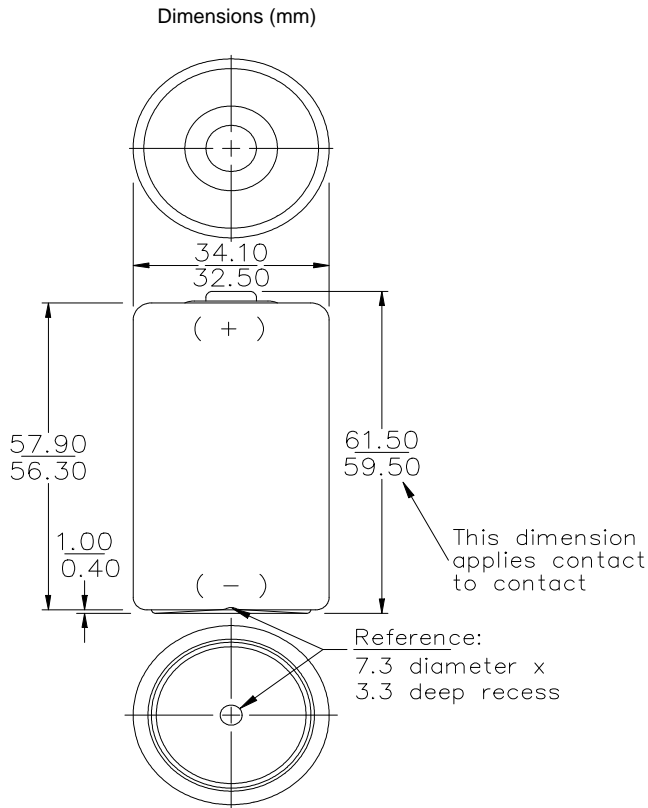

**Chemical System:** Zinc-Manganese Dioxide (Zn/MnO<sub>2</sub>)

**Designation:** ANSI-13D, IEC-R20

**Battery Voltage:** 1.5 Volts

**Average Weight:** 89 grams (3.1 oz.)

**Volume:** 53 cubic centimeters (3.2 cubic inch)

**Average Service capacity (to 0.8 Volts):** 5900 mAh  
 (Rated Capacity at 25 mA continuous drain)

**Cell:** One No. 50 (size "D")

**Jacket:** Metal

Millimeters	Inches
0.40	0.016
1.00	0.039
3.30	0.130
7.30	0.287
32.50	1.280
34.10	1.343
56.30	2.217
57.90	2.280
59.50	2.343
61.50	2.421

**CONSTANT RESISTANCE PERFORMANCE**  
Typical Service

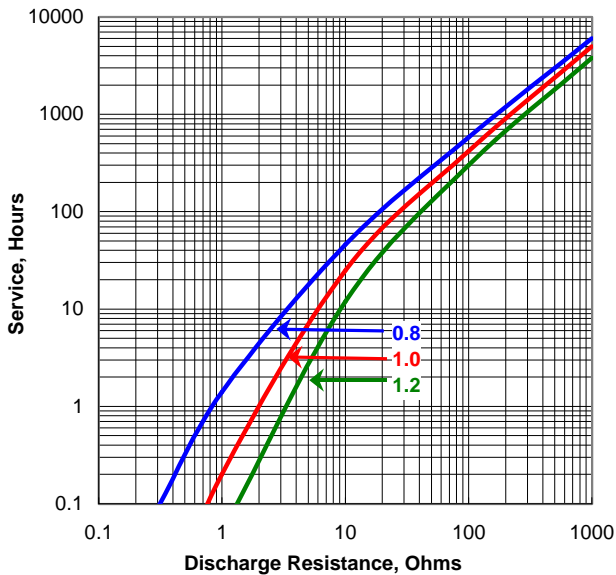

**CONSTANT CURRENT DISCHARGE**  
Typical Service

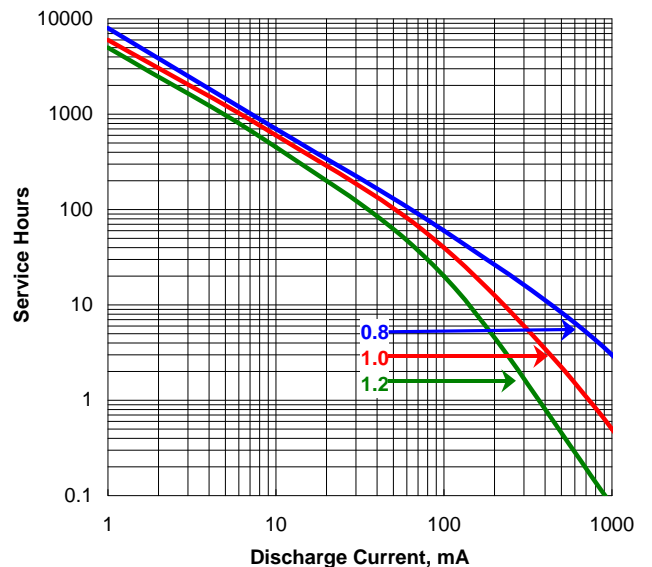

## Typical Applications

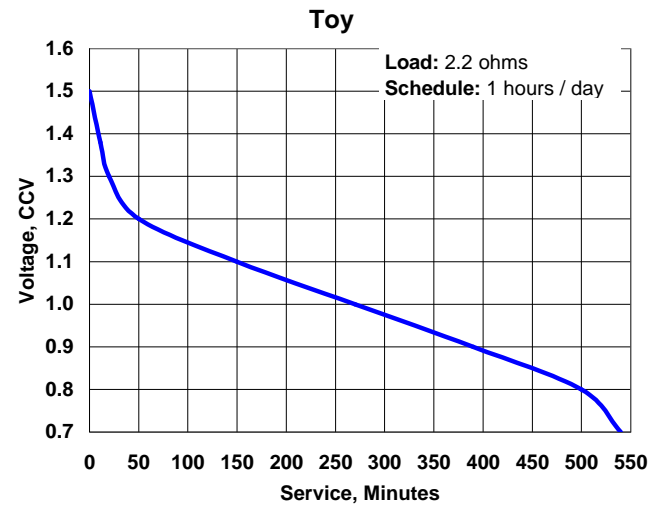
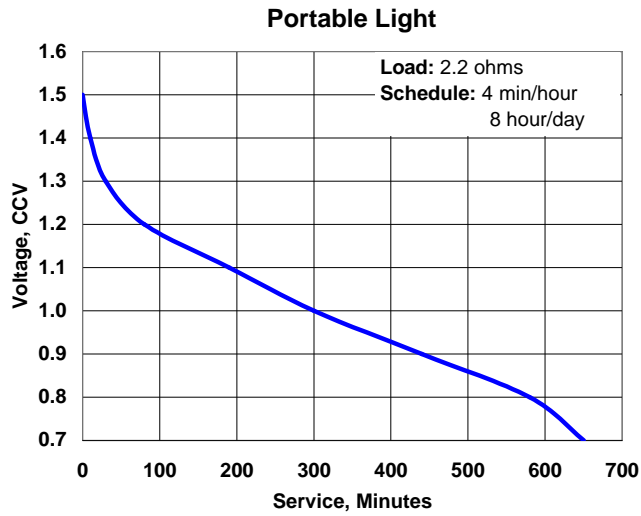
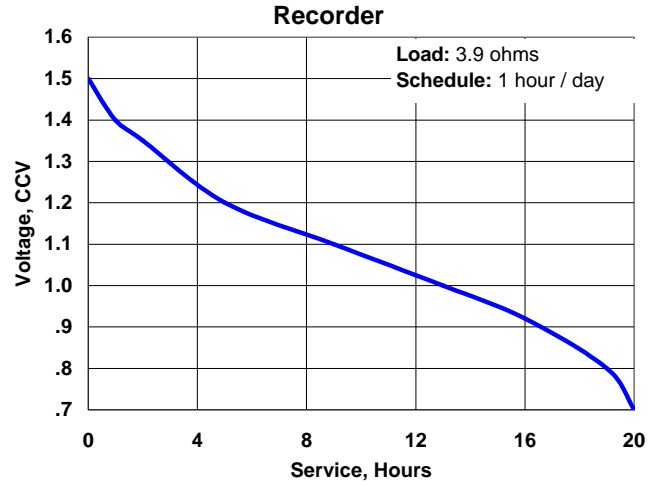
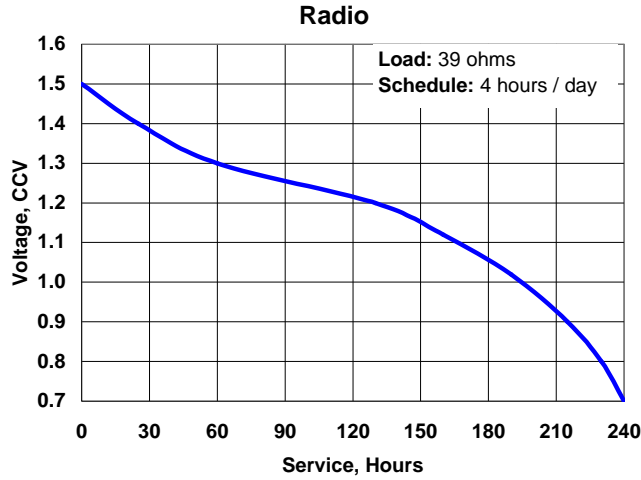

### Important Notice

This data sheet contains information specific to batteries manufactured at time of its publication. Please contact your Energizer representative for most current information. Contents herein do not constitute a warranty.