



SPC  
TECHNOLOGY

ALL RIGHTS RESERVED. NO PORTION OF THIS PUBLICATION, WHETHER IN WHOLE OR IN PART CAN BE REPRODUCED WITHOUT THE EXPRESS WRITTEN CONSENT OF SPC TECHNOLOGY.

SPC-F005.DWG

REVISIONS		DOC. NO.	SPC-F005	Effective:	7/8/02	DCP No:	1398	
DCP #	REV	DESCRIPTION	DRAWN	DATE	CHECKD	DATE	APPRVD	DATE
	VEE		12-08-10	JAG	18-08-10	XXX	26-08-10	



**Electrical Characteristics:**

**Primary:**

Pri #1 115V ±15% FREQ: (50,60)Hz  
Pri #2 115V ±15% FREQ: (50,60)Hz

**Secondary:**

Series 20.0VCT at 600mA/RMS  
Parallel 10V at 1.20A/RMS  
Regulation: 14.5% Approx

**Transformer Isolation:**

Pri/Pri 500V Pri/Sec 2500V  
Sec/Sec 500V Wind/Core 2500V

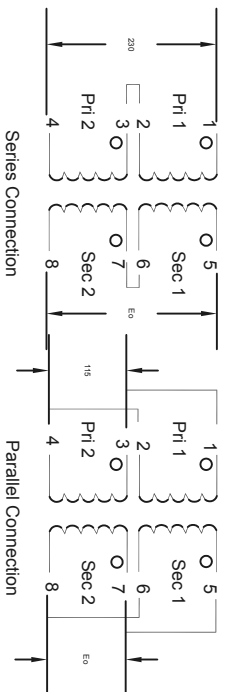
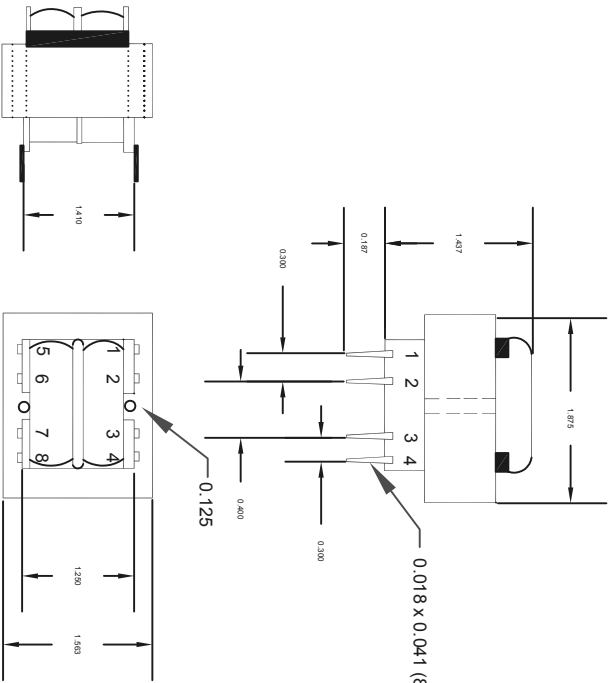

Dimensions : Inches

**Part Number Table**

Description	Part Number
PC Board Transformer	SPC20965

**TOLERANCES:**

UNLESS OTHERWISE SPECIFIED, DIMENSIONS ARE FOR REFERENCE PURPOSES ONLY.

DRAWN BY: VEE DATE: 12-08-10

CHECKED BY: JAG DATE: 18-08-10

APPROVED BY: XXX DATE: 26-08-10

DRAWING TITLE: **PC Board Transformer**

SIZE: XXX

DWG. NO.: XXX

ELECTRONIC FILE: 44N3631

SCALE: NTS

U.O.M.: INCHES [mm]

SHEET: 1 OF 1

DISCLAIMER:  
ALL STATEMENTS AND TECHNICAL INFORMATION CONTAINED HEREIN ARE BASED UPON INFORMATION AND/OR TESTS WE BELIEVE TO BE ACCURATE AND RELIABLE. SINCE CONDITIONS OF USE ARE BEYOND OUR CONTROL, THE USER SHALL DETERMINE THE SUITABILITY OF THE PRODUCT FOR THE INTENDED USE AND ASSUME ALL RISK AND LIABILITY WHATSOEVER IN CONNECTION THEREWITH.