

# FLYBACK TRANSFORMERS

## 35 to 45 W

## ETD 29



- Ambient Temperature  $\leq 50^{\circ}\text{C}$
- Primary Reflected Voltage = 90 to 120V
- Dielectric Strength  $\geq 3750\text{Vac}$
- Creepage Distances  $\geq 8\text{mm}$
- Construction conforms to CEI950, CEI335, CEI61558 for reinforced insulation
- Secondaries may be series or parallel connected
- Output power can be delivered with any combination of secondaries within the max current limits.

MYRRA Part N°	Control IC	Mains Voltage Range Vac	Total output Power (max) Watts	Outputs S1 or S3		Outputs S2 or S4		Frequency kHz	Primary Inductance $\mu\text{H}$	Pinout	Remarks
				Voltage Range Vdc	Max Current Adc	Voltage Range Vdc	Max Current Adc				
74040	VIPer50	85 - 265	35	4,5 - 6	3	11 - 14	1,5	100	500	Fig.1	
	VIPer50	185 - 265	45	4,5 - 6	4	11 - 14	1,5	100			
	TOP225Y	85 - 265	35	3,3 - 7	3	8 - 16,5	1,5	100			
	TOP225Y	185 - 265	45	3,3 - 7	4	8 - 16,5	1,5	100			
	MC33372	85 - 265	35	4 - 7	3	10 - 16,5	1,5	100			
	MC33372	185 - 265	45	4 - 7	4	10 - 16,5	1,5	100			
	TDA16834	92 - 265	35	5 - 6	3	12 - 14,5	1,5	100			
	TDA16834	185 - 265	45	5 - 6	4	12 - 14,5	1,5	100			

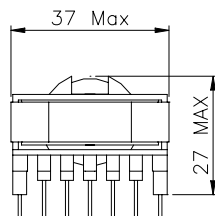
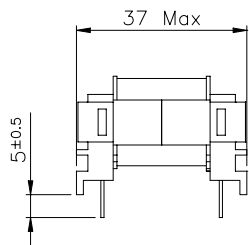
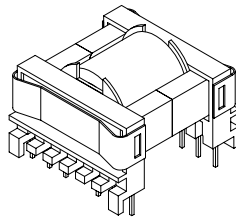
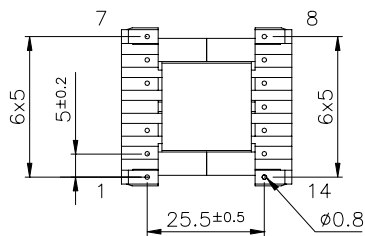
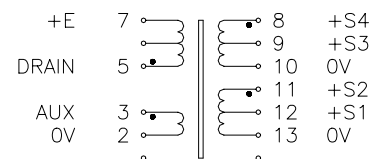

FIG.1

VIEW FROM PIN SIDE  
PIN 4 REMOVED



PCB DRILLING DIAMETER 1.3mm