



**Strangkühlkörper für
Leiterplattenmontage**
**Extruded heatsinks
for PCB mounting**
**Dissipateurs extrudés
pour montage PCB**

Art. Nr. Art. No. Art. n°		 [mm]	Wärmewiderstand Thermal resistance Résistances thermiques
SK 95 15 STS SOT 32 S	SOT 32	15	38,5 K/W
SK 95 25 STS TO 220	TO 220	25	36 K/W
SK 95 25 STS SOT 32	SOT 32	25	36 K/W

SK 95 15 STS SOT 32 S

SK 95 25 STS TO 220

SK 95 25 STS SOT 32

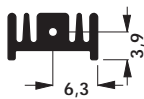

L = lötlarer Stift

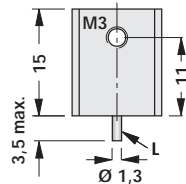

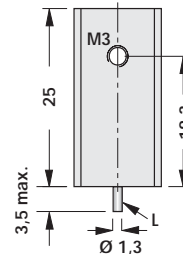

L = solderable pin

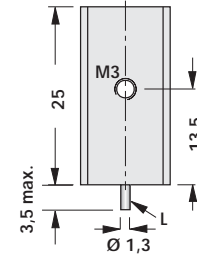

L = picot soudables



Art. Nr. Art. No. Art. n°		 [mm]	Wärmewiderstand Thermal resistance Résistances thermiques
SK 95 15	-	15	38,5 K/W
SK 95 15 SOT 32 S	SOT 32	15	38,5 K/W
SK 95 25	-	25	36 K/W
SK 95 25 TO 220	TO 220	25	36 K/W
SK 95 25 SOT 32	SOT 32	25	36 K/W
SK 95 25 2 x M 3	2 x M 3 (TO 220)	25	36 K/W
SK 95 1000	-	1000	-

SK 95 25 2 x M3

SK 95 15 SOT 32 S

SK 95 25 TO 220

SK 95 25 SOT 32

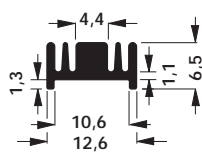
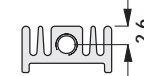

Oberfläche schwarz eloxiert
Gewinde eloxalfrei

Sonderlängen und Sondertransistor-
lochungen auf Anfrage.

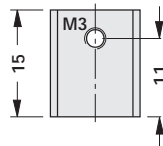

Surface black anodised
threads not anodised

Special lengths and transistor drillings on
request.

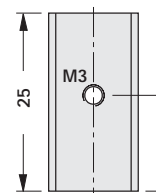
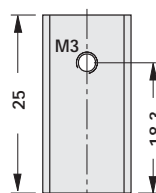

Surface anodisée noire
taradages non anodisée

Longueurs et perçages de boîtier spéciales
sur demand.

