



# Model : CMBA022929 Series

## BGA Heat Sink Specification

For 29x29 Chip set



1. Material : Al 6063
2. Dimension :  
Foot print : 29x29mm  
Height : 12,15,18,21,23,28,33 mm  
Base (thickness) : 2.6mm

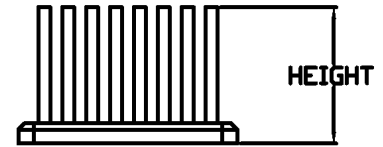
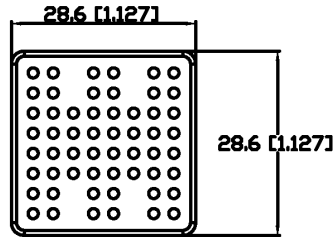

3. Finish: Black Anodize
4. Chip set package thickness and clip color  
3.3+/-0.25mm - Yellow clip  
1.7+/-0.25mm - Blue clip  
0.8+/-0.25mm - Orange clip
5. Accessory :  
Clip : Plastic (UL94-V0)  
Thermal pad : T710 or others



## Performance

Heat Source (LxW)	15x15
-------------------	-------

