



# 5915PC(150x $\phi$ 172x38<sup>L</sup>)

Metal Blades / Standard

EMINEBEA.COM



## General Specifications

- Motor Protection:** Impedance Protection
- Motor Structure:** Capacitor-Run Induction Motor
- Insulation Resistance:** 100M  $\Omega$  or over with a DC500V Megger
- Dielectric Withstand Voltage:** AC 1800V 3s
- Allowable Ambient Temperature Range:**
  - 10°C ~ +70°C (Operating)
  - 40°C ~ +70°C (Storage)
  - (non-condensing environment)

## Expected Life

**Failure Rate: 10%**  
25°C 50,000 Hours

## Outline

Units:  $\frac{\text{inch}}{\text{mm}}$

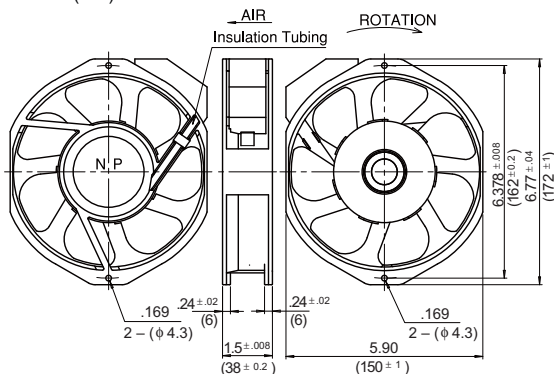

## Characteristic Curves

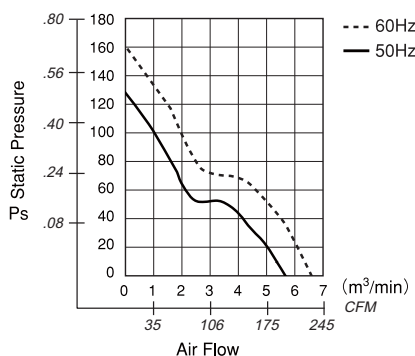

## Panel Cut-outs

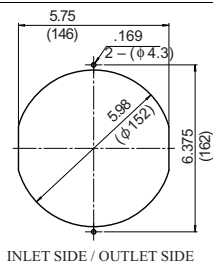

## Material

- Casing : Aluminum
- Impeller : Steel
- Bearing : Ball Bearings
- Terminal: Faston #110 or Equiv

## Specifications

MODEL	Rated Voltage	Frequency	Starting Voltage	Current	Input Power	Speed	Max. Air Flow		Max. Static Pressure		Noise	Mass
	(V)	(Hz)	(V)	(A) <sup>*1</sup>	(W)+10/-20%	(min <sup>-1</sup> )*3	(CFM) <sup>*3</sup>	(m <sup>3</sup> /min) <sup>*3</sup>	(in H <sub>2</sub> O) <sup>*2</sup>	(Pa) <sup>*2</sup>	(dB) <sup>*2</sup>	(g)
5915PC-10T-B30-S00	100	50	65	0.53	42.0	2650	187.10	5.30	.510	127.5	48.0	900
		60		0.45	40.0	3150	222.39	6.30	.655	163.8	53.0	
5915PC-12T-B30-S00	115	50	75	0.45	40.0	2650	187.10	5.30	.510	127.5	48.0	
		60		0.40	38.0	3150	222.39	6.30	.655	163.8	53.0	
5915PC-20T-B30-S00	200	50	130	0.25	42.0	2650	187.10	5.30	.510	127.5	48.0	
		60		0.23	40.0	3150	222.39	6.30	.655	163.8	53.0	
5915PC-22T-B30-S00	220	50	145	0.25	42.0	2650	187.10	5.30	.510	127.5	48.0	
		60		0.23	40.0	3150	222.39	6.30	.655	163.8	53.0	
5915PC-23T-B30-S00	230	50	150	0.22	42.0	2650	187.10	5.30	.510	127.5	48.0	
		60		0.20	40.0	3150	222.39	6.30	.655	163.8	53.0	
5915PC-24T-B30-S00	240	50	155	0.20	39.0	2650	187.10	5.30	.510	127.5	48.0	
		60		0.20	39.0	3150	222.39	6.30	.655	163.8	53.0	

Rotation: Counterclockwise as seen from the label side.  
Airflow Outlet: Label side

\*1: Maximum Values in Free Air \*2: Average Values in Free Air \*3: Minimum Values in Free Air