

# Dimensions

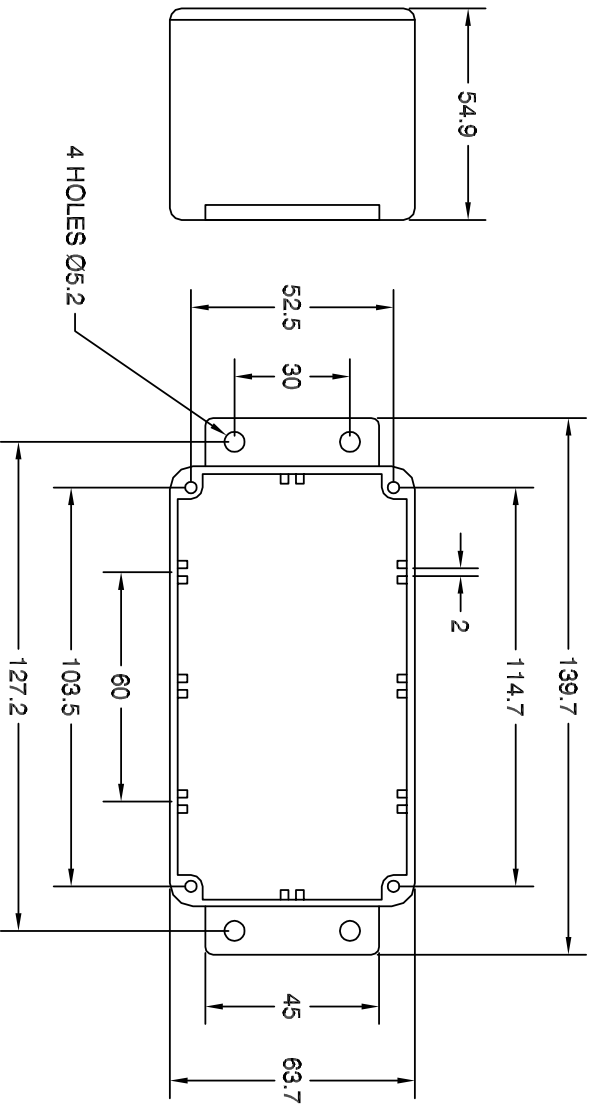

## Description

A range of diecast boxes in various sizes, manufactured in a robust aluminium alloy. These lightweight enclosures provide excellent screening against EMI/RFI and are therefore ideal housing for electronic components and circuits.

The close fitting lid is secured using four countersunk screws. The box also incorporates integral PCB guides, and comes in a plain finish.

## Features

MATERIAL BOX & LID	:Aluminium Alloy LM24
SCREWS	:Mild Steel M3.5x9
WALL THICKNESS	:2.0mm

CONVERTED FROM COREL. PS0227 ISS3

DrgNo 455-0040-GS

TAPER 1.5° PER SIDE  
BASE TO LID ALL DIMENSIONS IN MM / ANGLES IN DECIMAL DEGREES

TITLE FLANGED DIECAST BOX 'D' SIZE



4

GENERAL SPECIFICATION FOR 455-0040

CUSTOMER FILTER REF

Sheet 1 of 1 Aprvd Date 17/04/02 Aprvd By MC Drwn by BS SCALE NTS CNN--- Location N: \LONDON\GS\LG500054

©DELTRON EMCON LTD, ROXBURGH HOUSE, FOXHILLS INDUSTRIAL PARK, SCUNTHORPE, NORTH LINCOLNSHIRE, DN15 8QJ TEL +44 1724 281770 F +44 1724 270230