

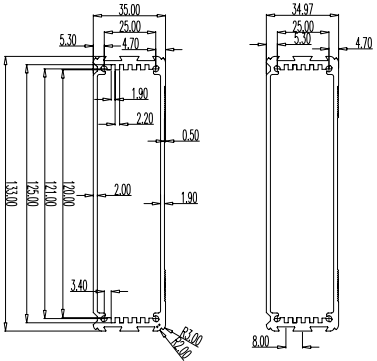

ENCLOSURES & ASSEMBLY SERVICES
WWW.BOXENCLOSURES.COM

BOX ENCLOSURES-USA
28915 N. Herky Dr #107
LAKE BLUFF, IL 60044
TEL: 847-932-4700
FAX: 847-932-4701
E-Mail - sales@boxenclosures.com

BOX ENCLOSURES-UK
1 Ash Grove
Kingsley England B020705
TEL: +44 (0) 1535 636 856
FAX: +44 (0) 1535 637 737

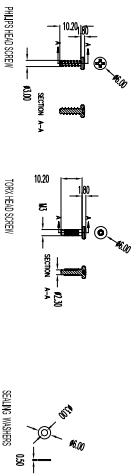
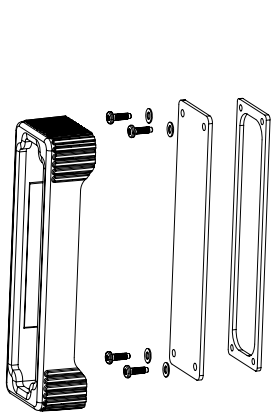
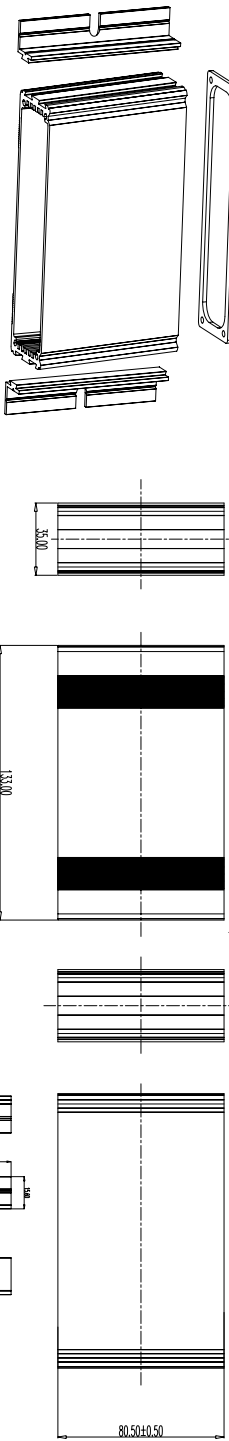
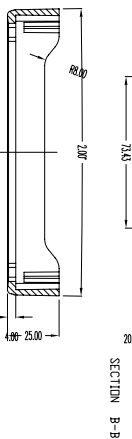
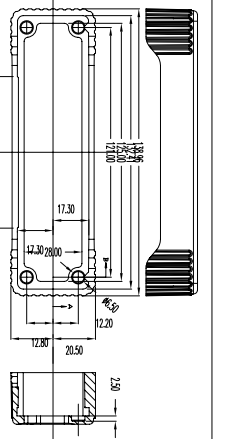
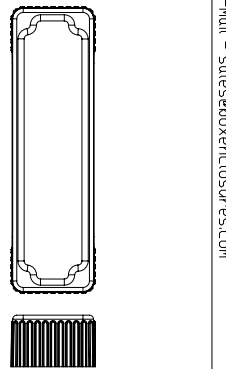
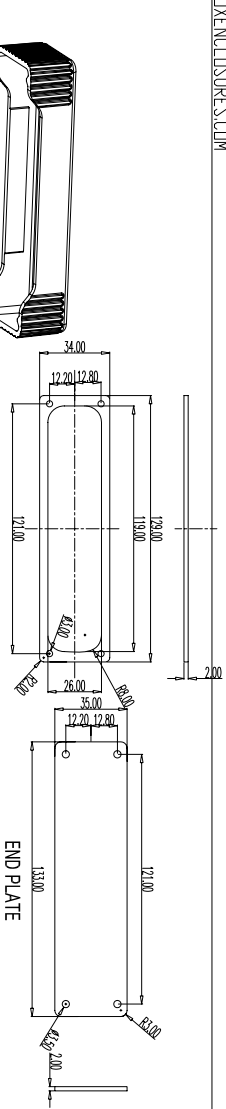

ENCLOSURE PROFILE

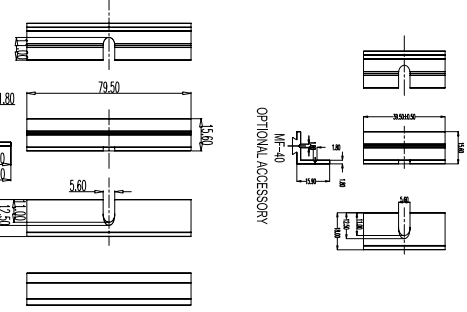

OPTIONAL ACCESSORY MF-90

Part #	Color	40 mm Mounting Flange Part #	Color
EC-5BK	Black	MF-40-BK	Black
EC-5BL	Blue	MF-40-BL	Blue
EC-5GR	Green	MF-40-GR	Green
EC-5RD	Red	MF-40-RD	Red
EC-5SV	Grey	MF-40-SI	Silver

Part #	Description	Color
B5-080 BK	Anodized Color	Black
B5-080 BL	Flange Part #	Blue
B5-080 GR	Flange Part #	Green
B5-080 RD	Flange Part #	Red
B5-080 SI	Flange Part #	Silver

ENCLOSURES & ASSEMBLY SERVICES

Bosch

TITLE BS-080 MASTER DRAWING

REVISION

Material:	TOLERANCE	Dwn	Date
Aluminum 6063-T6(H9)	all dimension in mm	PAW	2009-04-08
Finish:	unless otherwise specified	Chk:	Date
Anodized BS 1615	X ±0.40		
	X ±0.20		
	X ±0.10		
	ANGLE ±1°		

THIS DRAWING IS THE PROPERTY OF AND MAY CONTAIN PROPRIETARY INFORMATION OWNED BY Bosch Enclosures. IT IS PROVIDED UNDER A CONFIDENTIAL RELATIONSHIP FOR A SPECIFIC PURPOSE. THE RECIPIENT AGREES TO USE IT ONLY FOR SUCH PURPOSE AND RETURN IT TO Bosch Enclosures UPON REQUEST.