



PART NO.

MCL223SRD

REVISIONS

ECN #	REV	DESCRIPTION	DRAWN	DATE	CHECKD	DATE	APPRVD	DATE
-	A	RELEASED	Veena	25/9/08	Suresh	25/9/08	Farnell	9/10/08

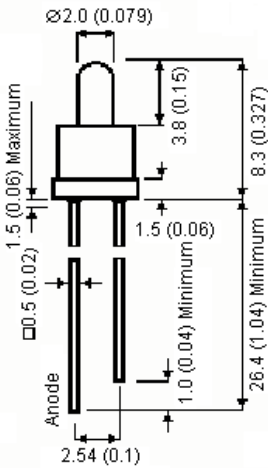
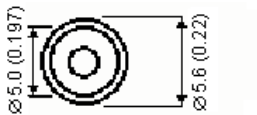

Dimensions : Millimetres (Inches)

Specifications:

Dice material : AlAGas.
 Emitted colour : Super red.
 Lens colour : Red diffused.
 Peak wavelength : 660nm.
 Viewing angle : 60 degrees.
 Luminous intensity (IV) : 25mcd.



Electrical/Optical Characteristics at T_a = 25°C

Parameter	Symbol	Minimum	Typical	Maximum	Unit	Test
Luminous Intensity	IV	13	25	40	mcd	IF = 20mA
Viewing Angle	2θ 1/2	-	60	-	degrees	
Peak Emission Wavelength	λ _p	-	660	-	nm	-
Dominant Wavelength	λ _D	-	643	-		-
Spectral Line Half-width	Δλ	-	20	-		-
Forward Voltage	V _F	1.5	1.85	2.5	V	IF = 20mA
Power Dissipation	P _d	-	-	85	mW	-
Peak Forward Current (Duty 1/10 at 1KHz)	IF (Peak)	-	-	100	mA	-
Recommended Operating Current	IF (Rec)	-	20	-		-

This data sheet and its contents (the "Information") belong to the Premier Farnell Group (the "Group") or are licensed to it. No licence is granted for the use of it other than for information purposes in connection with the products to which it relates. No licence of any intellectual property rights is granted. The Information is subject to change without notice and replaces all data sheets previously supplied. The Information supplied is believed to be accurate but the Group assumes no responsibility for its accuracy or completeness, any error in or omission from it or for any use made of it. Users of this data sheet should check for themselves the Information and the suitability of the products for their purpose and not make any assumptions based on information included or omitted. Liability for loss or damage resulting from any reliance on the Information or use of it (including liability resulting from negligence or where the Group was aware of the possibility of such loss or damage arising) is excluded. This will not operate to limit or restrict the Group's liability for death or personal injury resulting from its negligence. SPC MULTICOMP is the registered trademark of the Group. © Premier Farnell plc 2008.

TOLERANCES:
 UNLESS OTHERWISE SPECIFIED, DIMENSIONS ARE FOR REFERENCE PURPOSES ONLY.

DRAWN BY:	DATE:
Veena	25/09/08
CHECKED BY:	DATE:
Suresh	25/09/08
APPROVED BY:	DATE:
Farnell	09/10/08

DRAWING TITLE:			
2.0mm Tower LED Lamp - Super-Red			
SIZE	DWG NO.	ELECTRONIC FILE	REV
A	M10001751	L223SRD_DWG	A
SCALE: NTS	U.O.M.: mm (Inches)	SHEET: 1 OF 4	



PART NO.

MCL223SRD

REVISIONS

ECN #	REV	DESCRIPTION	DRAWN	DATE	CHECKED	DATE	APPRVD	DATE
-	A	RELEASED	Veena	25/9/08	Suresh	25/9/08	Farnell	9/10/08

Absolute Maximum Ratings (T_a = 25°C)

Reverse Voltage	5 Volt
Reverse Current	10μA (V _R = 5V)
Operating Temperature Range	-40°C to 85°C
Storage Temperature Range	-40°C to 100°C
Lead Soldering Temperature Range [1.6mm (1/16 inch) from body]	260°C for 5 Seconds

Super Red (GaAlAs) λP = 660nm

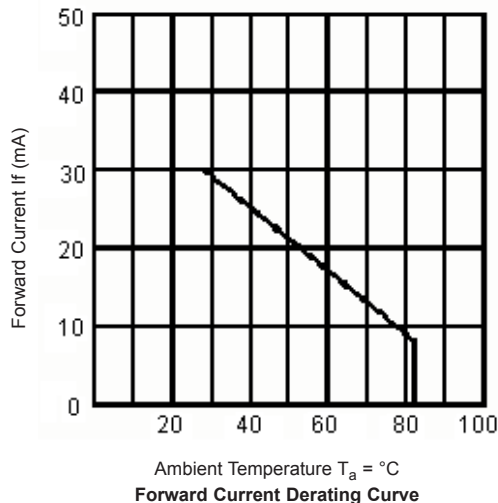
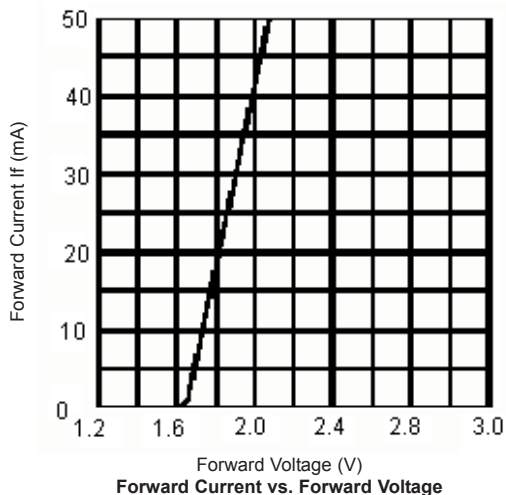

This data sheet and its contents (the "Information") belong to the Premier Farnell Group (the "Group") or are licensed to it. No licence is granted for the use of it other than for information purposes in connection with the products to which it relates. No licence of any intellectual property rights is granted. The Information is subject to change without notice and replaces all data sheets previously supplied. The Information supplied is believed to be accurate but the Group assumes no responsibility for its accuracy or completeness, any error in or omission from it or for any use made of it. Users of this data sheet should check for themselves the Information and the suitability of the products for their purpose and not make any assumptions based on information included or omitted. Liability for loss or damage resulting from any reliance on the Information or use of it (including liability resulting from negligence or where the Group was aware of the possibility of such loss or damage arising) is excluded. This will not operate to limit or restrict the Group's liability for death or personal injury resulting from its negligence. SPC MULTICOMP is the registered trademark of the Group. © Premier Farnell plc 2008.

TOLERANCES:
UNLESS OTHERWISE SPECIFIED, DIMENSIONS ARE FOR REFERENCE PURPOSES ONLY.

DRAWN BY:	DATE:
Veena	25/09/08
CHECKED BY:	DATE:
Suresh	25/09/08
APPROVED BY:	DATE:
Farnell	09/10/08

DRAWING TITLE:

2.0mm Tower LED Lamp - Super-Red

SIZE	DWG NO.	ELECTRONIC FILE	REV
A	M10001751	L223SRD_DWG	A
SCALE: NTS		U.O.M.: mm (Inches)	SHEET: 2 OF 4



PART NO.

MCL223SRD

REVISIONS

ECN #	REV	DESCRIPTION	DRAWN	DATE	CHECKD	DATE	APPRVD	DATE
-	A	RELEASED	Veena	25/9/08	Suresh	25/9/08	Farnell	9/10/08

Super Red (GaAlAs) $\lambda P = 660nm$

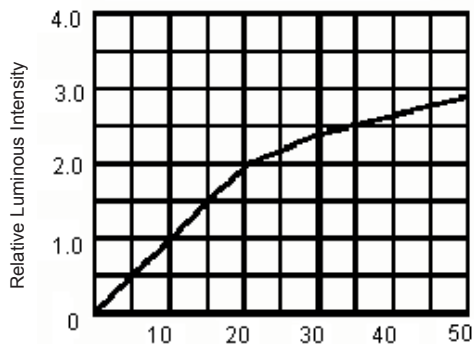

Forward Current (mA) $T_a = 25^\circ C$
Luminous Intensity vs. Forward Current

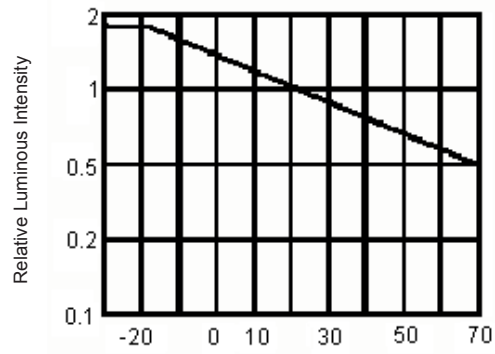

Ambient Temperature $T_a = ^\circ C$
Luminous Intensity vs. Ambient Temperature

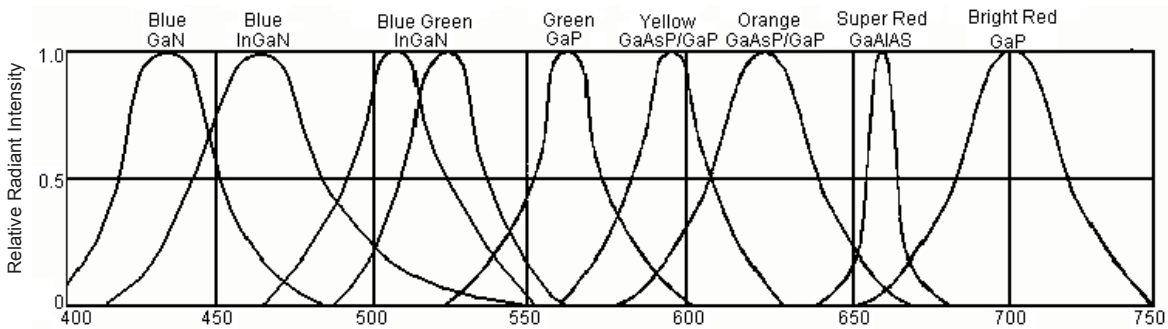

Wavelength λ (nm)
Relative Intensity vs. Wavelength

This data sheet and its contents (the "Information") belong to the Premier Farnell Group (the "Group") or are licensed to it. No licence is granted for the use of it other than for information purposes in connection with the products to which it relates. No licence of any intellectual property rights is granted. The Information is subject to change without notice and replaces all data sheets previously supplied. The Information supplied is believed to be accurate but the Group assumes no responsibility for its accuracy or completeness, any error in or omission from it or for any use made of it. Users of this data sheet should check for themselves the Information and the suitability of the products for their purpose and not make any assumptions based on information included or omitted. Liability for loss or damage resulting from any reliance on the Information or use of it (including liability resulting from negligence or where the Group was aware of the possibility of such loss or damage arising) is excluded. This will not operate to limit or restrict the Group's liability for death or personal injury resulting from its negligence. SPC MULTICOMP is the registered trademark of the Group. © Premier Farnell plc 2008.

TOLERANCES:
UNLESS OTHERWISE SPECIFIED, DIMENSIONS ARE FOR REFERENCE PURPOSES ONLY.

DRAWN BY:	DATE:
Veena	25/09/08
CHECKED BY:	DATE:
Suresh	25/09/08
APPROVED BY:	DATE:
Farnell	09/10/08

DRAWING TITLE:

2.0mm Tower LED Lamp - Super-Red

SIZE	DWG NO.	ELECTRONIC FILE	REV
A	M10001751	L223SRD_DWG	A
SCALE: NTS	U.O.M.: mm (Inches)	SHEET: 3 OF 4	



PART NO.

MCL223SRD

REVISIONS

ECN #	REV	DESCRIPTION	DRAWN	DATE	CHECKD	DATE	APPRVD	DATE
-	A	RELEASED	Veena	25/9/08	Suresh	25/9/08	Farnell	9/10/08

Part Number Table

Description	Part Number
LED, 2mm, 60°, Super-Red	MCL223SRD

<http://www.farnell.com>
<http://www.newark.com>
<http://www.cpc.co.uk>

This data sheet and its contents (the "Information") belong to the Premier Farnell Group (the "Group") or are licensed to it. No licence is granted for the use of it other than for information purposes in connection with the products to which it relates. No licence of any intellectual property rights is granted. The Information is subject to change without notice and replaces all data sheets previously supplied. The Information supplied is believed to be accurate but the Group assumes no responsibility for its accuracy or completeness, any error in or omission from it or for any use made of it. Users of this data sheet should check for themselves the Information and the suitability of the products for their purpose and not make any assumptions based on information included or omitted. Liability for loss or damage resulting from any reliance on the Information or use of it (including liability resulting from negligence or where the Group was aware of the possibility of such loss or damage arising) is excluded. This will not operate to limit or restrict the Group's liability for death or personal injury resulting from its negligence. SPC MULTICOMP is the registered trademark of the Group. © Premier Farnell plc 2008.

**TOLERANCES:
UNLESS OTHERWISE
SPECIFIED,
DIMENSIONS ARE
FOR REFERENCE
PURPOSES ONLY.**

DRAWN BY:	DATE:
Veena	25/09/08
CHECKED BY:	DATE:
Suresh	25/09/08
APPROVED BY:	DATE:
Farnell	09/10/08

DRAWING TITLE:			
2.0mm Tower LED Lamp - Super-Red			
SIZE	DWG NO.	ELECTRONIC FILE	REV
A	M10001751	L223SRD_DWG	A
SCALE: NTS		U.O.M.: mm (Inches)	SHEET: 4 OF 4