



SPC
TECHNOLOGY

ALL RIGHTS RESERVED. NO PORTION OF THIS PUBLICATION, WHETHER IN WHOLE OR IN PART CAN BE REPRODUCED WITHOUT THE EXPRESS WRITTEN CONSENT OF SPC TECHNOLOGY.

SPC-F005.DWG

REVISIONS		DCI. NO.	SPC-F005	*	Effective	7/8/02	*	DCI No	1398
DCP #	REV	DESCRIPTION	DATE	CHECKD	DATE	APPRVI	DATE		
XX	XX	XXXX	13-09-08	XXXX	13-09-08	XXXX	13-09-08		
XXXX	XXXX		13-09-08	XXXX	13-09-08	XXXX	13-09-08		

Package Outlines

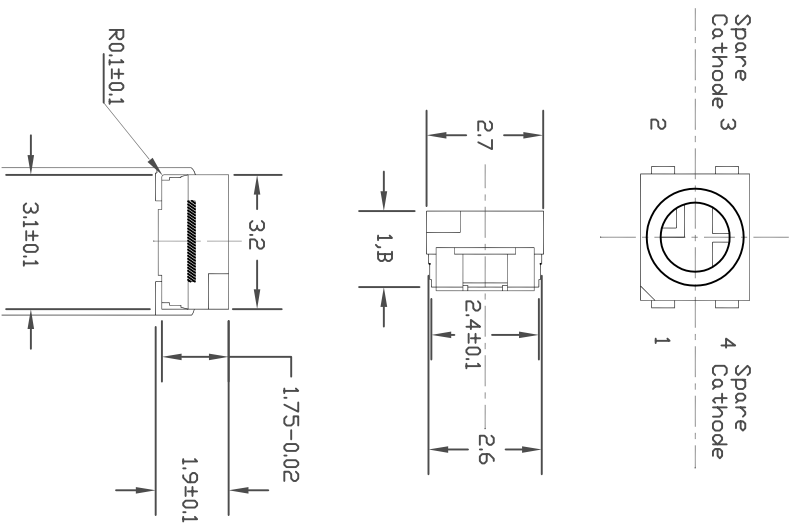

RECOMMEND PAD LAYOUT

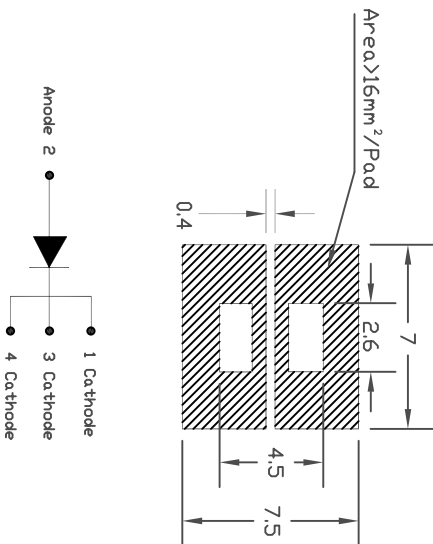

ITEM	MATERIALS
Resin (mold)	Epoxy
Bonding Wire	∅ 25 μm Au
Lens color	Water Clear
Printed circuit board	BT (White)
Dice	Blue InGaN/SiC

NOTES:

- All dimensions are in millimeters (inches);
- Tolerances are ±0.2mm (0.008inch) unless otherwise noted.



Multi Color LED

DISCLAIMER:
ALL STATEMENTS AND TECHNICAL INFORMATION CONTAINED HEREIN ARE BASED UPON INFORMATION AND/OR TESTS WE BELIEVE TO BE ACCURATE AND RELIABLE. SINCE CONDITIONS OF USE ARE BEYOND OUR CONTROL, THE USER SHALL DETERMINE THE SUITABILITY OF THE PRODUCT FOR THE INTENDED USE AND ASSUME ALL RISK AND LIABILITY WHATSOEVER IN CONNECTION THEREWITH.

TOLERANCES:
UNLESS OTHERWISE SPECIFIED, DIMENSIONS ARE FOR REFERENCE PURPOSES ONLY.

DRAWN BY:	DATE:
XXXX	13-09-08
CHECKED BY:	DATE:
XXXX	13-09-08
APPROVED BY:	DATE:
XXXX	13-09-08

DRAWING TITLE:		SCALE: NTS	
Multi Color LED		INCHES [mm]	
SIZE	DWG. NO.	ELECTRONIC FILE	REV
A	MC24180	02P5959	XX
U.D.M. INCHES [mm]		SHEET: 1 OF	



SPC
TECHNOLOGY

ALL RIGHTS RESERVED. NO PORTION OF THIS PUBLICATION, WHETHER IN WHOLE OR IN PART CAN BE REPRODUCED WITHOUT THE EXPRESS WRITTEN CONSENT OF SPC TECHNOLOGY.

SPC-F005JLVG

REVISONS		DRAWN		CHECKD		APPRVI	
DCP #	REV	DATE	DATE	DATE	DATE	DATE	DATE
XX	XX	XXXX	22-09-08	XXXX	22-09-08	XXXX	22-09-08
XXXX	XXXX	XXXX	22-09-08	XXXX	22-09-08	XXXX	22-09-08

DESCRIPTION
XXXX

Absolute Maximum Ratings

(TA=25°C)

Parameter	Symbol	Value	Unit
Power dissipation	Pd	96	mW
Forward current	If	30	mA
Reverse voltage	Vr	5	V
Operating temperature range	Top	-40~+100	°C
Storage temperature range	Tstg	-40~+100	°C
Peak pulsing current (1/8 duty f=1kHz)	Ifp	125	mA

Electro-optical Characteristics

(TA=25°C)

Parameter	Test Condition	Symbol	Value		Unit
			Min	Max	
Wavelength at peak emission	If=20mA	λ_{peak}	--	470	nm
Spectral half bandwidth	If=20mA	$\Delta\lambda$	--	20	nm
Dominant wavelength	If=20mA	λ_{dom}	--	465	nm
Forward voltage	If=20mA	Vf	--	3.4	V
Luminous intensity	*1 If=20mA	Iv	--	200	mcad
Viewing angle at 50% Iv	If=10mA	$2\theta_{1/2}$	--	120	Deg
Reverse current	Vr=5V	Ir	--	10	μ A

* 1 Note: Luminous intensity tolerances are $\pm 10\%$



TOLERANCES:

DRAWN BY:

DATE:

DRAWING TITLE:

Multi Color LED

ELECTRONIC FILE

REV

UNLESS OTHERWISE SPECIFIED, DIMENSIONS ARE FOR REFERENCE PURPOSES ONLY.

CHECKED BY:

DATE:

SIZE DWG. NO.

02P5959

XX

XXXX

22-09-08

A

MC24180

XX

XXXX

DATE:

SCALE: NTS

U.D.M.: INCHES [mm]

SHEET: 1 OF 1

DISCLAIMER: ALL STATEMENTS AND TECHNICAL INFORMATION CONTAINED HEREIN ARE BASED UPON INFORMATION AND/OR TESTS WE BELIEVE TO BE ACCURATE AND RELIABLE. SINCE CONDITIONS OF USE ARE BEYOND OUR CONTROL, THE USER SHALL DETERMINE THE SUITABILITY OF THE PRODUCT FOR THE INTENDED USE AND ASSUME ALL RISK AND LIABILITY WHATSOEVER IN CONNECTION THEREWITH.



SPC TECHNOLOGY

ALL RIGHTS RESERVED. NO PORTION OF THIS PUBLICATION, WHETHER IN WHOLE OR IN PART CAN BE REPRODUCED WITHOUT THE EXPRESS WRITTEN CONSENT OF SPC TECHNOLOGY.
SPC-F005.DWG

REVISIONS		DOC. NO. SPC-F005	* Effective: 7/8/02	* DCP No: 1398				
DCP #	REV	DESCRIPTION	DRAWN	DATE	CHECKD	DATE	APPRD	DATE
XX	XX	XXXX	XXXX	25-09-08	XXXX	25-09-08	XXXX	25-09-08
XXXX	XXXX		XXXX	25-09-08	XXXX	25-09-08	XXXX	25-09-08

OPTICAL CHARACTERISTIC CURVES

Spectral Radiance (Peak @ 470nm)

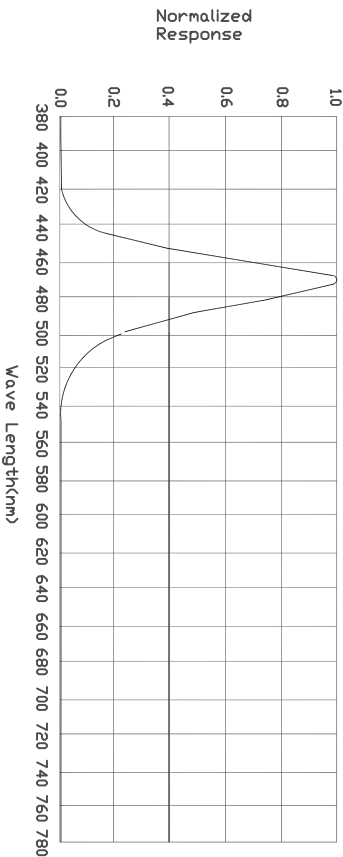

Forward Current vs Forward Voltage

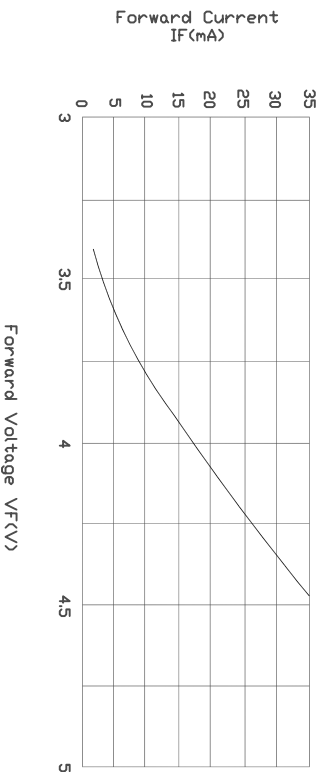

Directive Characteristics

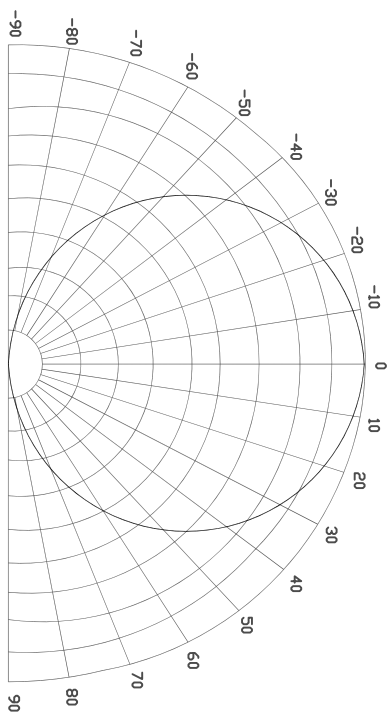

DISCLAIMER:
ALL STATEMENTS AND TECHNICAL INFORMATION CONTAINED HEREIN ARE BASED UPON INFORMATION AND/OR TESTS WE BELIEVE TO BE ACCURATE AND RELIABLE. SINCE CONDITIONS OF USE ARE BEYOND OUR CONTROL, THE USER SHALL DETERMINE THE SUITABILITY OF THE PRODUCT FOR THE INTENDED USE AND ASSUME ALL RISK AND LIABILITY WHATSOEVER IN CONNECTION THEREWITH.

TOLERANCES:

UNLESS OTHERWISE SPECIFIED, DIMENSIONS ARE FOR REFERENCE PURPOSES ONLY.

DRAWN BY:	XXXX	DATE:	25-09-08
CHECKED BY:	XXXX	DATE:	25-09-08
APPROVED BY:	XXXX	DATE:	25-09-08

DRAWING TITLE:

Multi Color LED

SIZE	DWG. NO.	ELECTRONIC FILE	REV
A	MC24180	02P5959	XX
SCALE:	NTS	U.O.M.: INCHES [mm]	SHEET: 1 OF 1



SPC TECHNOLOGY

ALL RIGHTS RESERVED. NO PORTION OF THIS PUBLICATION, WHETHER IN WHOLE OR IN PART CAN BE REPRODUCED WITHOUT THE EXPRESS WRITTEN CONSENT OF SPC TECHNOLOGY.
SPC-F005.DWG

REVISONS		DOC. NO.	SPC-F005	*	Effective	7/8/02	*	DCP No	1398
DCP #	REV	DESCRIPTION	DRAWN	DATE	CHECKD	DATE	APPRVI	DATE	
XX	XX	XXXX	XXXX	25-09-08	XXXX	25-09-08	XXXX	25-09-08	
XXXX	XXXX		XXXX	25-09-08	XXXX	25-09-08	XXXX	25-09-08	

• Reflow Temp/Time

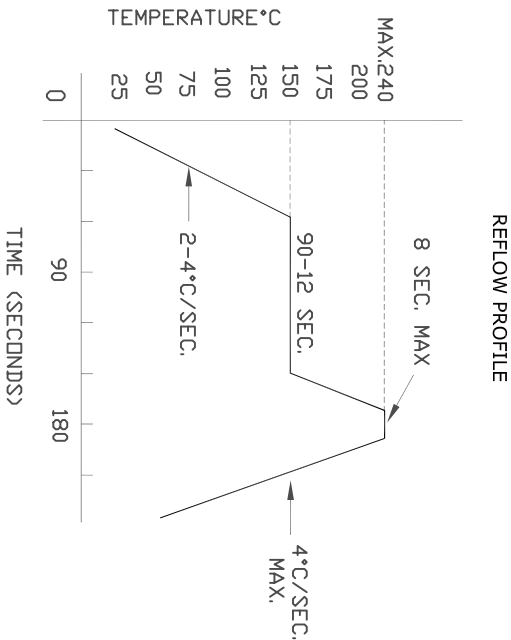

• Test Circuit

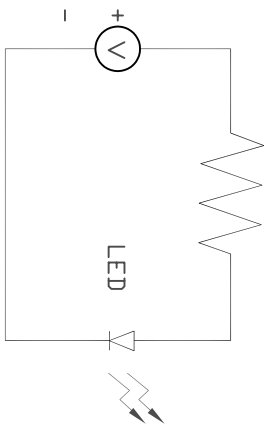

• Handling Precautions

- Over-current-proof
Customer must apply resistors for protection; otherwise slight voltage shift will cause big current change (Burn out will happen).
- Storage
2.1 It is recommended to store the products in the following conditions:
Humidity: 60% RH, Max. Temperature : 5°C~30°C (41°F~86°F)

• Soldering Iron

Basic spec is ≤ 5sec when 260°C. If temperature is higher, time should be shorter (+10°C → -1sec). Power dissipation of Iron should be smaller than 15W and temperatures should be controllable. Surface temperature of the device should be under 230°C.

3. Baking

It is recommended to baking before soldering when the pack is unsealed after 72hrs. The Conditions are as follows:
 3.1 60±3°C x (12~24hrs) and <5%RH, taped reel type
 3.2 100±3°C x (45min~1hr), bulk type
 3.3 130±3°C x (15~30min), bulk type

When you discover that the desiccant in the package has a pink color (normal=blue), you should treat them in the same conditions as (3.1~3.3)



DISCLAIMER:

ALL STATEMENTS AND TECHNICAL INFORMATION CONTAINED HEREIN ARE BASED UPON INFORMATION AND/OR TESTS WE BELIEVE TO BE ACCURATE AND RELIABLE. SINCE CONDITIONS OF USE ARE BEYOND OUR CONTROL, THE USER SHALL DETERMINE THE SUITABILITY OF THE PRODUCT FOR THE INTENDED USE AND ASSUME ALL RISK AND LIABILITY WHATSOEVER IN CONNECTION THEREWITH.

TOLERANCES:

UNLESS OTHERWISE SPECIFIED, DIMENSIONS ARE FOR REFERENCE PURPOSES ONLY.

DRAWN BY:	DATE:
XXXX	25-09-08
CHECKED BY:	DATE:
XXXX	25-09-08
APPROVED BY:	DATE:
XXXX	25-09-08

DRAWING TITLE:

Multi Color LED

SIZE	DWG. NO.	ELECTRONIC FILE	REV
A	MC24180	02P5959	XX
SCALE:	NTS	U.D.M.: INCHES [mm]	SHEET: 1 OF 1



SPC
TECHNOLOGY

ALL RIGHTS RESERVED. NO PORTION OF THIS PUBLICATION, WHETHER IN WHOLE OR IN PART CAN BE REPRODUCED WITHOUT THE EXPRESS WRITTEN CONSENT OF SPC TECHNOLOGY.

SPC-F005.DWG

REVISONS		DOC. NO.	SPC-F005	*	Effective	7/8/02	*	Doc No	1398
DCP #	REV	DESCRIPTION	DRAWN	DATE	CHECKD	DATE	APPRVI	DATE	
XX	XX	XXXX	XXXX	22-09-08	XXXX	22-09-08	XXXX	22-09-08	
XXXX	XXXX		XXXX	22-09-08	XXXX	22-09-08	XXXX	22-09-08	

SMD Chip LED Lamps Packaging Specifications

• Feeding Direction

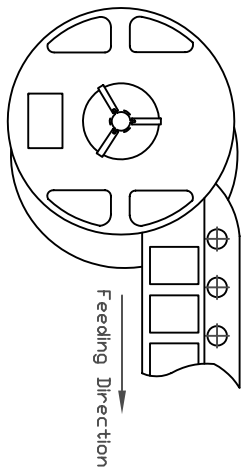

• Dimensions of Reel (Unit: mm)

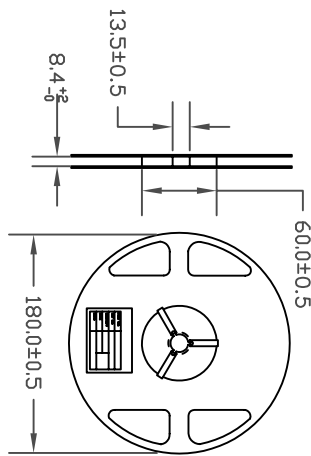

• Arrangement of Tape

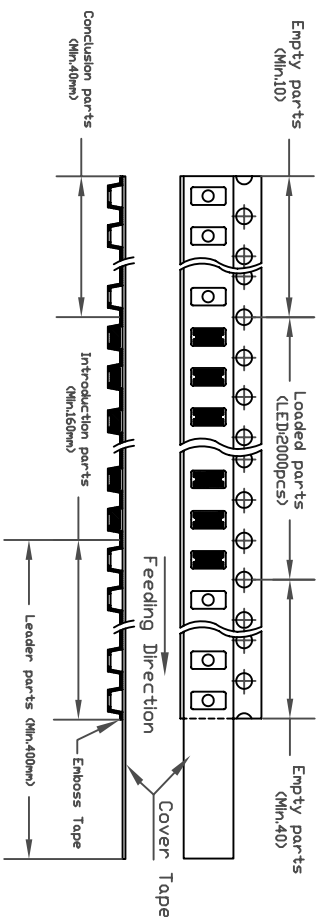

• Dimensions of Tape (Unit: mm)

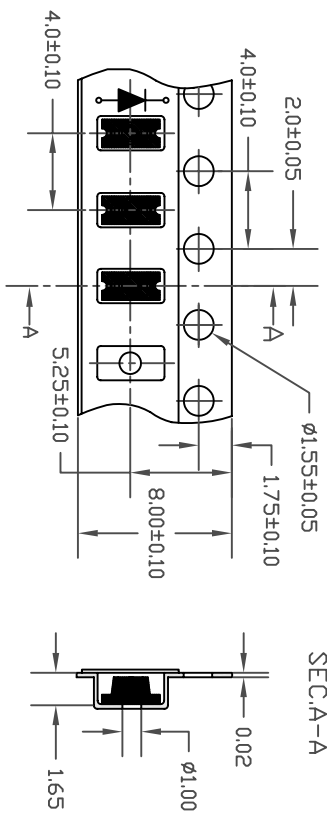

- NOTES
1. Empty component pockets are sealed with top cover tape
 2. The maximum number of missing lamps is two
 3. The cathode is oriented towards the tape sprocket hole in accordance with ANSI/EIA RS-481 specifications
 4. 2,000 pcs/Reel



DISCLAIMER:
ALL STATEMENTS AND TECHNICAL INFORMATION CONTAINED HEREIN ARE BASED UPON INFORMATION AND/OR TESTS WE BELIEVE TO BE ACCURATE AND RELIABLE. SINCE CONDITIONS OF USE ARE BEYOND OUR CONTROL, THE USER SHALL DETERMINE THE SUITABILITY OF THE PRODUCT FOR THE INTENDED USE AND ASSUME ALL RISK AND LIABILITY WHATSOEVER IN CONNECTION THEREWITH.

TOLERANCES:
UNLESS OTHERWISE SPECIFIED, DIMENSIONS ARE FOR REFERENCE PURPOSES ONLY.

DRAWN BY:	DATE:
XXXX	22-09-08
CHECKED BY:	DATE:
XXXX	22-09-08
APPROVED BY:	DATE:
XXXX	22-09-08

DRAWING TITLE:		Multi Color LED	
SIZE	DWG. NO.	ELECTRONIC FILE	REV
A	MC24180	02P5959	XX
SCALE:	NTS	U.D.M:	INCHES [mm]
		SHEET:	1 OF 1