



SPC
TECHNOLOGY

ALL RIGHTS RESERVED. NO PORTION OF THIS PUBLICATION, WHETHER IN WHOLE OR IN PART CAN BE REPRODUCED WITHOUT THE EXPRESS WRITTEN CONSENT OF SPC TECHNOLOGY.

SPC-F005.DWG

REVISONS		DOC. NO.	SPC-F005	*	Effective	7/8/02	*	Doc No	1398
DOP #	REV	DESCRIPTION	DRAWN	DATE	CHECKD	DATE	APPRVI	DATE	
XX	XX	XXXX	XXXX	24-09-08	XXXX	24-09-08	XXXX	24-09-08	
XXXX	XXXX		XXXX	24-09-08	XXXX	24-09-08	XXXX	24-09-08	

Package Outlines

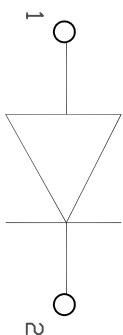
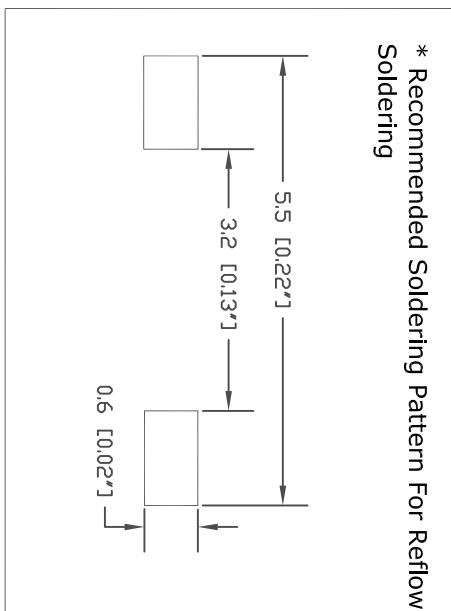
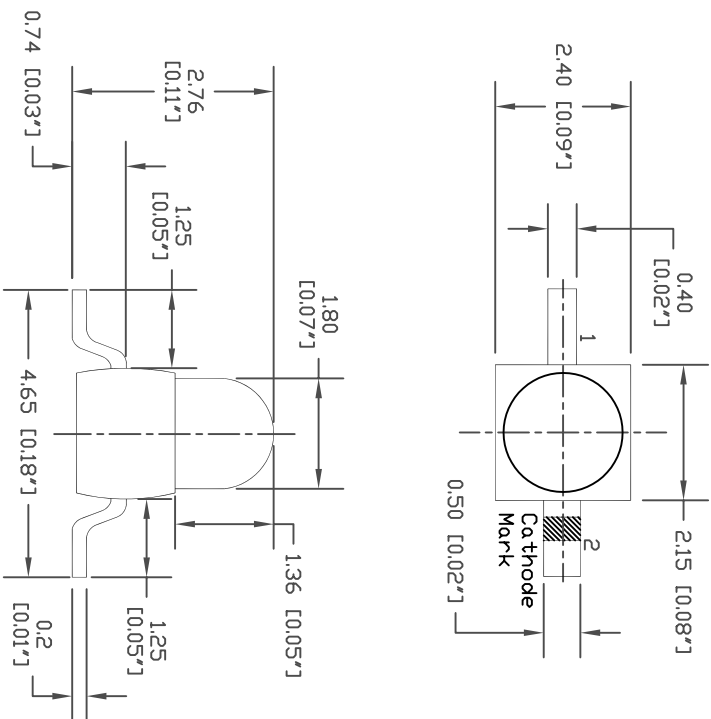

- NOTES:**
1. All dimensions are in millimeters (inches)
 2. Tolerances are ±0.1mm (0.004inch) unless otherwise noted.

ITEM	MATERIALS
Resin (mold)	Epoxy
Bonding Wire	φ25µmAu
Lens color	Water Clear
Dice	AllinGap
Emitted color	Yellow



DISCLAIMER:
ALL STATEMENTS AND TECHNICAL INFORMATION CONTAINED HEREIN ARE BASED UPON INFORMATION AND/OR TESTS WE BELIEVE TO BE ACCURATE AND RELIABLE. SINCE CONDITIONS OF USE ARE BEYOND OUR CONTROL, THE USER SHALL DETERMINE THE SUITABILITY OF THE PRODUCT FOR THE INTENDED USE AND ASSUME ALL RISK AND LIABILITY WHATSOEVER IN CONNECTION THEREWITH.

TOLERANCES:
UNLESS OTHERWISE SPECIFIED, DIMENSIONS ARE FOR REFERENCE PURPOSES ONLY.

DRAWN BY:	DATE:
XXXX	24-09-08
CHECKED BY:	DATE:
XXXX	24-09-08
APPROVED BY:	DATE:
XXXX	24-09-08

DRAWING TITLE:		SCALE:	U.D.M.:	SHEET:	OF
Multi Color LED		NTS	INCHES [mm]	1	1
SIZE	DWG. NO.	ELECTRONIC FILE	REV		
A	MC24129	02P5932	XX		



SPC
TECHNOLOGY

ALL RIGHTS RESERVED. NO PORTION OF THIS PUBLICATION, WHETHER IN WHOLE OR IN PART CAN BE REPRODUCED WITHOUT THE EXPRESS WRITTEN CONSENT OF SPC TECHNOLOGY.

SPC-F005.DWG

REVISONS		DESCRIPTION		DOC. NO.	SPC-F005	*	Effective: 7/8/02	*	Doc No: 1398
DCP #	REV			DRAWN	DATE	CHECKD	DATE	APPRVI	DATE
XX	XX	XXXX		XXXX	24-09-08	XXXX	24-09-08	XXXX	24-09-08
XXXX	XXXX			XXXX	24-09-08	XXXX	24-09-08	XXXX	24-09-08

Absolute Maximum Ratings

(TA=25°C)

Parameter	Symbol	Value	Unit
Power dissipation	Pd	75	mW
Forward current	If	30	mA
Reverse voltage	Vr	5	V
Operating temperature range	Top	-20~+80	°C
Storage temperature range	Tstg	-20~+80	°C
Peak pulsing current (1/8 duty f=1KHz)	Ifp	125	mA
Lead Soldering Temperature	Tsol	260°C For 5 SEC (3mm[0.20"] from body)	

Electro-optical Characteristics

(TA=25°C)

Parameter	Test Condition	Symbol	Value		Unit	
			Min	Typ		Max
Wavelength at peak emission	If=20mA	λ_{peak}	590	595	600	nm
Spectral half bandwidth	If=20mA	$\Delta\lambda$	--	20	--	nm
Dominant wavelength	If=20mA	λ_{dom}	--	595	--	nm
Forward voltage	If=20mA	Vf	--	2.0	2.5	V
Luminous intensity	*If=20mA	Iv	650	900	--	mcd
Viewing angle at 50% Iv	If=10mA	$2\theta_{1/2}$	--	20	--	deg
Reverse current	Vr=5V	Ir	--	--	10	μA

* 1 Note: Luminous intensity tolerances are $\pm 10\%$



RoHS
Compliant

DISCLAIMER:
ALL STATEMENTS AND TECHNICAL INFORMATION CONTAINED HEREIN ARE BASED UPON INFORMATION AND/OR TESTS WE BELIEVE TO BE ACCURATE AND RELIABLE. SINCE CONDITIONS OF USE ARE BEYOND OUR CONTROL, THE USER SHALL DETERMINE THE SUITABILITY OF THE PRODUCT FOR THE INTENDED USE AND ASSUME ALL RISK AND LIABILITY WHATSOEVER IN CONNECTION THEREWITH.

TOLERANCES:

UNLESS OTHERWISE SPECIFIED, DIMENSIONS ARE FOR REFERENCE PURPOSES ONLY.

DRAWN BY:	DATE:
XXXX	24-09-08
CHECKED BY:	DATE:
XXXX	24-09-08
APPROVED BY:	DATE:
XXXX	24-09-08

DRAWING TITLE:

Multi Color LED

SIZE	DWG. NO.	ELECTRONIC FILE	REV
A	MC24129	02P5932	XX
SCALE:	NTS	U.D.M:	INCHES [mm]
		SHEET:	1 OF 1



SPC
TECHNOLOGY

ALL RIGHTS RESERVED. NO PORTION OF THIS PUBLICATION,
WHETHER IN WHOLE OR IN PART CAN BE REPRODUCED
WITHOUT THE EXPRESS WRITTEN CONSENT OF SPC
TECHNOLOGY.

SPC-F005.DWG

REVISIONS		DOC. NO. SPC-F005	* Effective: 7/8/02	* DCP No: 1398				
DCP #	REV	DESCRIPTION	DRAWN	DATE	CHECKD	DATE	APPRD	DATE
XX	XX	XXXX	XXXX	25-09-08	XXXX	25-09-08	XXXX	25-09-08
XXXX	XXXX		XXXX	25-09-08	XXXX	25-09-08	XXXX	25-09-08

OPTICAL CHARACTERISTIC CURVES

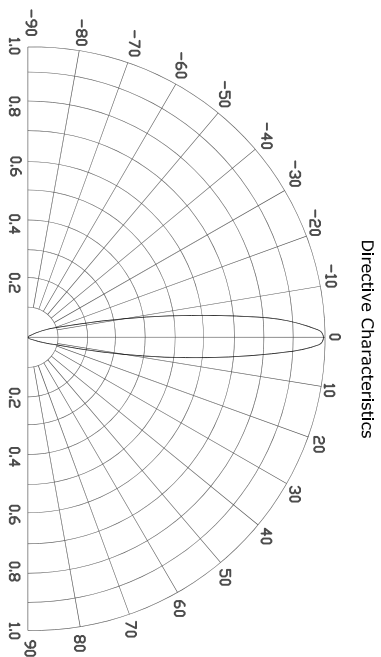
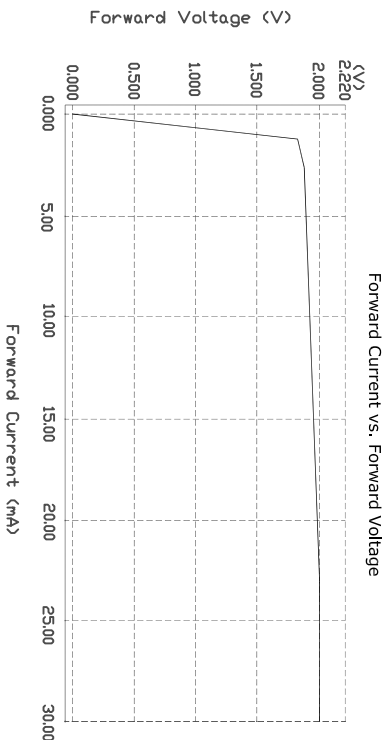
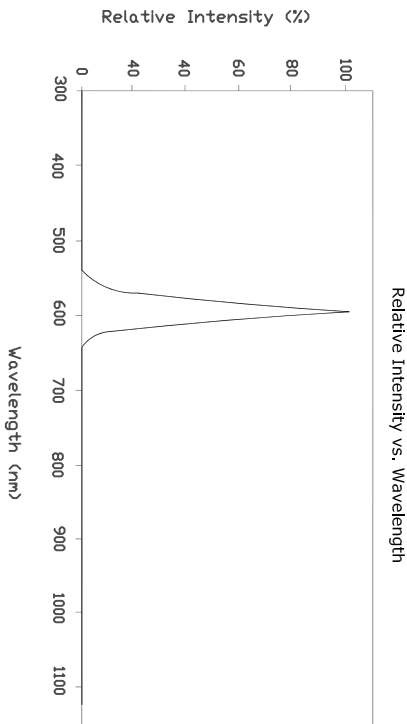

DISCLAIMER:
ALL STATEMENTS AND TECHNICAL INFORMATION CONTAINED
HEREIN ARE BASED UPON INFORMATION AND/OR TESTS WE
BELIEVE TO BE ACCURATE AND RELIABLE. SINCE
CONDITIONS OF USE ARE BEYOND OUR CONTROL, THE
USER SHALL DETERMINE THE SUITABILITY OF THE PRODUCT
FOR THE INTENDED USE AND ASSUME ALL RISK AND
LIABILITY WHATSOEVER IN CONNECTION THEREWITH.

TOLERANCES:
UNLESS OTHERWISE
SPECIFIED,
DIMENSIONS ARE
FOR REFERENCE
PURPOSES ONLY.

DRAWN BY:	XXXX	DATE:	25-09-08
CHECKED BY:	XXXX	DATE:	25-09-08
APPROVED BY:	XXXX	DATE:	25-09-08

DRAWING TITLE:		Multi Color LED	
SIZE	DWG. NO.	ELECTRONIC FILE	REV
A	MC24129	02P5932	XX
SCALE:	NTS	U.O.M.: INCHES [mm]	SHEET: 1 OF 1



SPC
TECHNOLOGY

ALL RIGHTS RESERVED. NO PORTION OF THIS PUBLICATION, WHETHER IN WHOLE OR IN PART CAN BE REPRODUCED WITHOUT THE EXPRESS WRITTEN CONSENT OF SPC TECHNOLOGY.

SPC-F005.DWG

REVOLUTIONS		DOC. NO. SPC-F005	* Effective: 7/6/02		* DCP No.: 1398	
DCP #	REV	DESCRIPTION	DRAWN	DATE	CHECKD	DATE
XX	XX	XXXX	XXXX	24-09-08	XXXX	24-09-08
XXXX	XXXX		XXXX	24-09-08	XXXX	24-09-08

■ Test Circuit

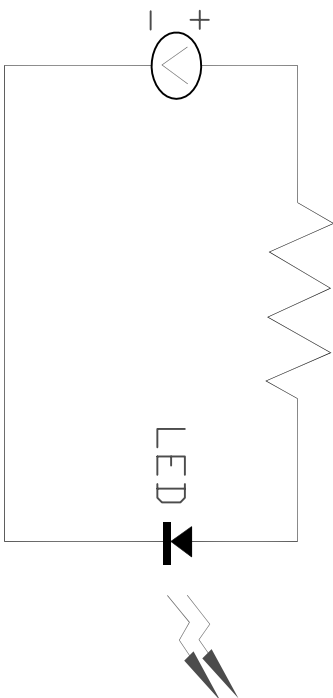

■ Handling Precautions

1. Over-current-proof

Customer must apply resistor for protection; otherwise slight voltage shift will cause big current change (Burn out will happen).

2. Storage

2.1 It is recommended to store the products in the following conditions:

Humidity: 60% RH, Max.

Temperature: 5°C-30°C (41°F-86°F)

2.2 Shelf life in sealed bag: 12 month at <5°C-30°C and <30% RH, after the package is opened, the products should be used within a week or they should be keeping to stored at ≤ 20 RH, with zip-lock sealed.

3. Baking

It is recommended to baking before soldering when the pack is unsealed after 72hrs.

The Conditions are as followings:

3.1 60±3°C x(12-24hrs) and <5%RH, taped reel type

3.2 100±3°C x(45min-1hr), bulk type

3.3 130±3°C x(15-30min), bulk type

When you discover that the desiccant in the package has a pink color (normal=blue), you should treat them in the same conditions as (3.1-3.3)



DISCLAIMER:

ALL STATEMENTS AND TECHNICAL INFORMATION CONTAINED HEREIN ARE BASED UPON INFORMATION AND/OR TESTS WE BELIEVE TO BE ACCURATE AND RELIABLE. SINCE CONDITIONS OF USE ARE BEYOND OUR CONTROL, THE USER SHALL DETERMINE THE SUITABILITY OF THE PRODUCT FOR THE INTENDED USE AND ASSUME ALL RISK AND LIABILITY WHATSOEVER IN CONNECTION THEREWITH.

TOLERANCES:

UNLESS OTHERWISE SPECIFIED, DIMENSIONS ARE FOR REFERENCE PURPOSES ONLY.

DRAWING TITLE:		DRAWING TITLE:	
DRAWN BY:	DATE:	SIZE	DWG. NO.
XXXX	24-09-08	A	MC24129
CHECKED BY:	DATE:	SCALE:	U.O.M.: INCHES [mm]
XXXX	24-09-08	NTS	
APPROVED BY:	DATE:	ELECTRONIC FILE	SHEET: 1 OF 1
XXXX	24-09-08	02P5932	
		REV	
		XX	

Multi Color LED

ELECTRONIC FILE

02P5932

XX



SPC
TECHNOLOGY

ALL RIGHTS RESERVED. NO PORTION OF THIS PUBLICATION, WHETHER IN WHOLE OR IN PART CAN BE REPRODUCED WITHOUT THE EXPRESS WRITTEN CONSENT OF SPC TECHNOLOGY.

SPC-F005.DWG

REVISONS		DCI. NO.	SPC-F005	*	Effective	7/8/02	*	DCP No	1398
DCP #	REV	DESCRIPTION	DRAWN	DATE	CHECKD	DATE	APPRV	DATE	
XX	XX	XXXX	XXXX	25-09-08	XXXX	25-09-08	XXXX	25-09-08	
XXXX	XXXX		XXXX	25-09-08	XXXX	25-09-08	XXXX	25-09-08	

Packing Specifications

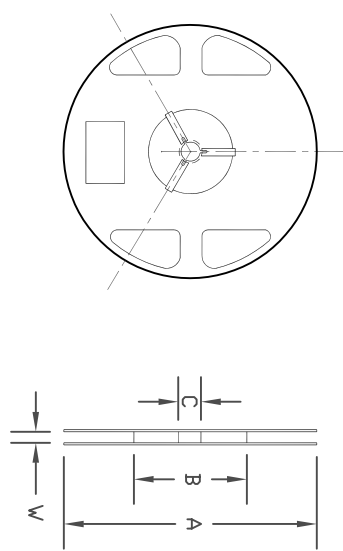
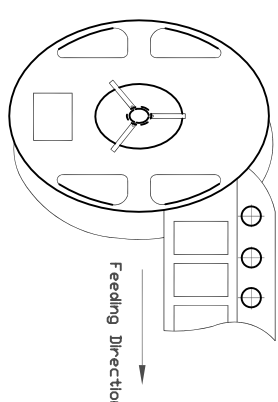
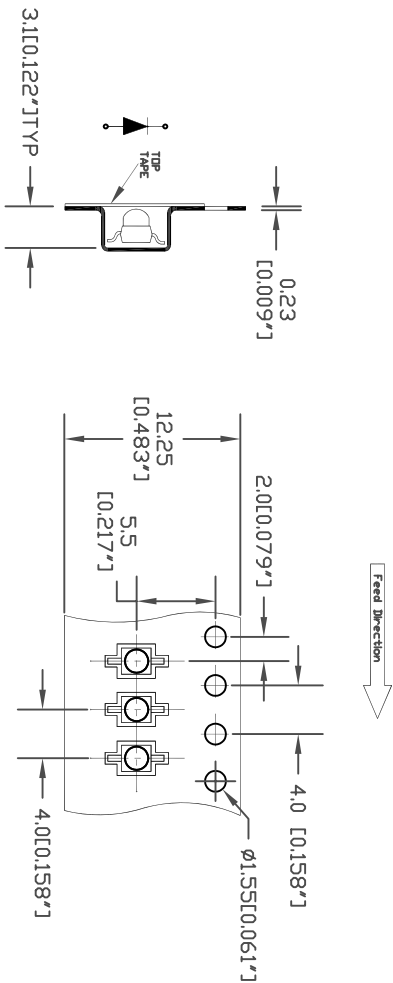

Dimensions per ANSI/EIA Standard RS-481 All dimensions are in millimeters (Inches).	
A	180(7.091)
B	60(2.361)
C	13.5(0.531)
W	12.5(0.501)
Thickness of top cover tape 0.1(0.004") MAX	

NOTES:

1. Empty component pockets are sealed with top cover tape!
2. Minimum leader length at both ends of the tape is 450mm!
3. The sprocket hole is oriented towards the tape sprocket hole.
4. The Cothole is oriented towards the tape sprocket hole.
5. In accordance with ANSI/EIA RS-481 specifications.



DISCLAIMER:
ALL STATEMENTS AND TECHNICAL INFORMATION CONTAINED HEREIN ARE BASED UPON INFORMATION AND/OR TESTS WE BELIEVE TO BE ACCURATE AND RELIABLE. SINCE CONDITIONS OF USE ARE BEYOND OUR CONTROL, THE USER SHALL DETERMINE THE SUITABILITY OF THE PRODUCT FOR THE INTENDED USE AND ASSUME ALL RISK AND LIABILITY WHATSOEVER IN CONNECTION THEREWITH.

TOLERANCES:
UNLESS OTHERWISE SPECIFIED, DIMENSIONS ARE FOR REFERENCE PURPOSES ONLY.

DRAWN BY:	DATE:
XXXX	25-09-08
CHECKED BY:	DATE:
XXXX	25-09-08
APPROVED BY:	DATE:
XXXX	25-09-08

DRAWING TITLE:		SCALE:	U.D.M.:	SHEET:	DF:
Multi Color LED		NTS	INCHES [mm]	1	1
SIZE	DWG. NO.	ELECTRONIC FILE	REV		
A	MC24129	02P5932	XX		