

474-307, 474-319, 474-356

HF - Series (IP 65)

Standard models

Flexible arm 250 mm



Without joint ● 50W
○ 75W

○ 50W
● 75W

With joint ● 50W
○ 75W

○ 50W
● 75W

Flexible arm 500 mm



Without joint ● 50W
○ 75W

○ 50W
● 75W

With joint ● 50W
○ 75W

○ 50W
● 75W

Flexible arm 700 mm



Without joint ● 50W
○ 75W

○ 50W
● 75W

With joint ● 50W
○ 75W

○ 50W
● 75W

Jointed arm 250+400 mm

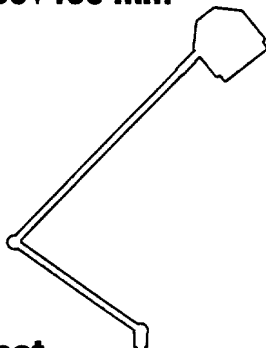

● 50W
○ 75W

12470 12670
12570 12770

○ 50W
● 75W

12471 12671
12571 12771

Spot



Single joint ● 50W
○ 75W

○ 50W
● 75W

12460 12660
12560 12760

○ 50W
● 75W

12461 12661
12561 12761



Double joint ● 50W
○ 75W

○ 50W
● 75W

12462 12662
12562 12762

12463 12663
12563 12763

Base without transformer



12V 24V

Accessories

Panel bracket 250 mm ● 15540
Fitted to ○ 15541
flexible arm 500 mm ● 15550
○ 15551
700 mm ● 15560
○ 15561

Trolley base ● 14024
○ 14025

Magnetic base ● 12010

Wall bracket ● 14030
○ 14031

Screw-clamp bracket ● 14020
○ 14021

Dimmer Fitted in base
AC/DC, 12/24V, 20-35W 14081

Switch Fitted to lamp head 12095

Handle Fitted to lamp head 12096

Protective transformer
IP-23 230V/12V- 80VA 12030
IP-23 230V/24V- 80VA 12035

Distributor insert x 3 For 12030/12035 12040

Plug-in-transformer
IP-20 230V/11,5V- 50VA 12045
IP-20 230V/24V- 50VA 12050

For lenses, bulbs, reflectors and moisture/dust seal, see spare-part list pp. 10 - 12

474-307

474-319

● = Standard colour black
○ = Standard colour white

HF - Series

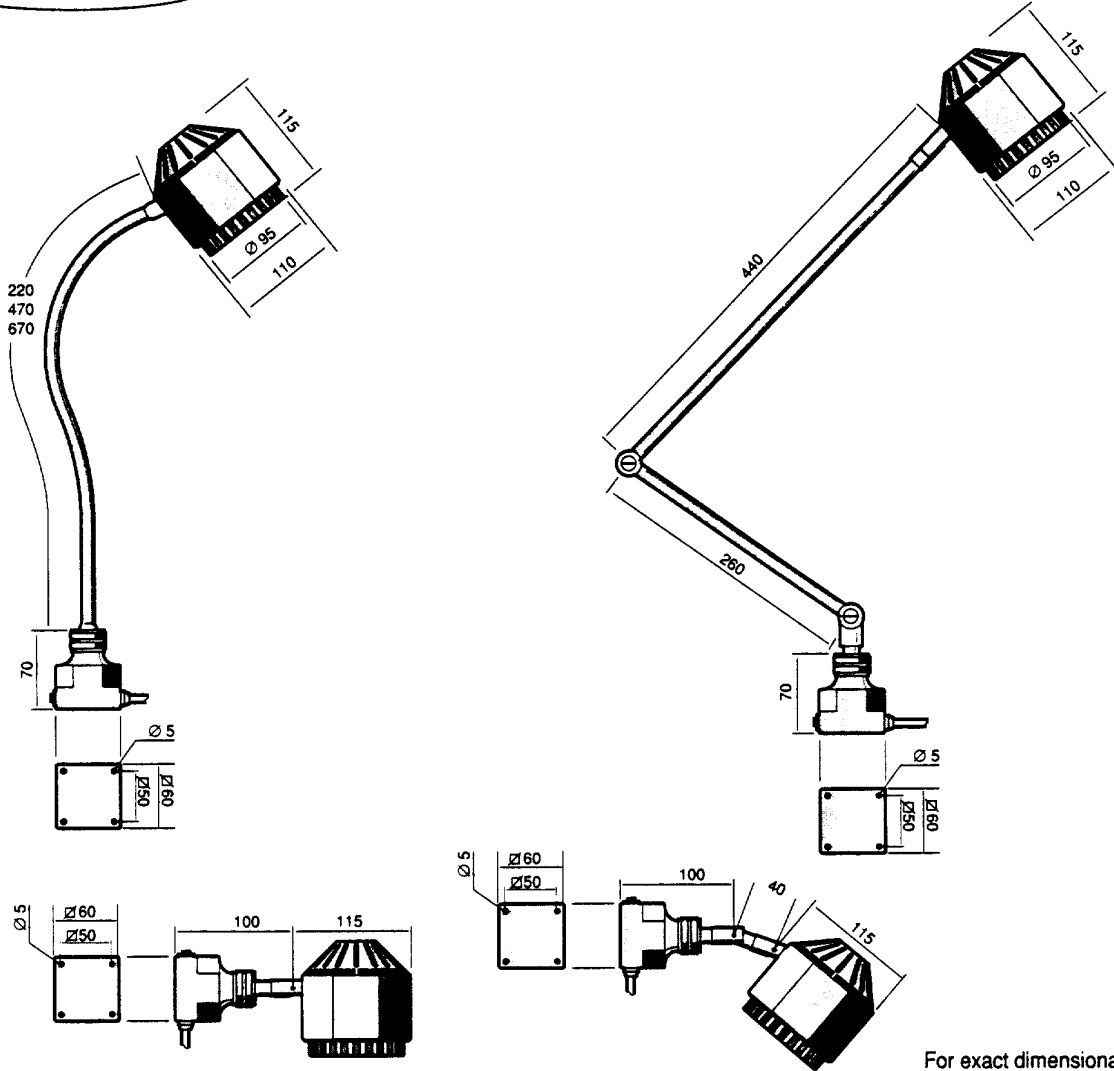
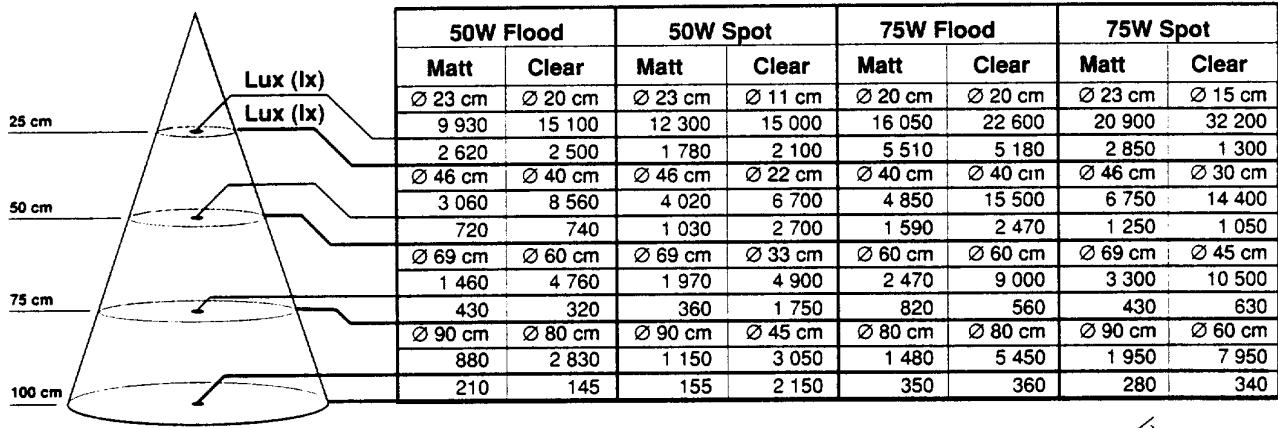

For exact dimensional data contact Sunnex.

Trolley base

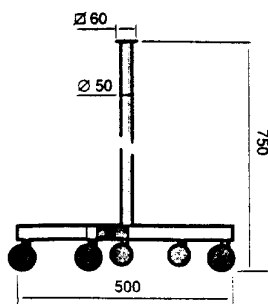

Magnetic base

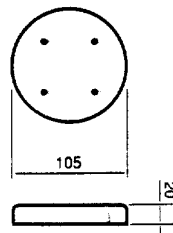

Screw-clamp bracket



Wall bracket

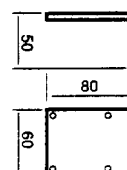

Panel mounting

