

ALL RIGHTS RESERVED. NO PORTION OF THIS PUBLICATION, WHETHER IN WHOLE OR IN PART CAN BE REPRODUCED WITHOUT THE EXPRESS WRITTEN CONSENT OF SPC TECHNOLOGY.

REVISIONS		DOC. NO. SPC-F005	Effective: 12/21/98	DCP No: 880				
DCP #	REV	DESCRIPTION	DRAWN	DATE	CHECKD	DATE	APPRVD	DATE
95	A	Released	JWM	10/7/99	JC	2/11/00	DJC	4/5/00

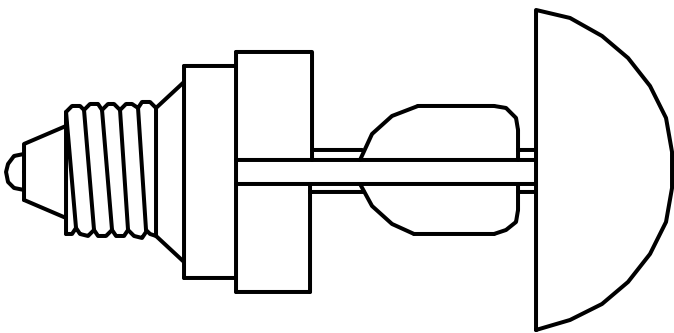
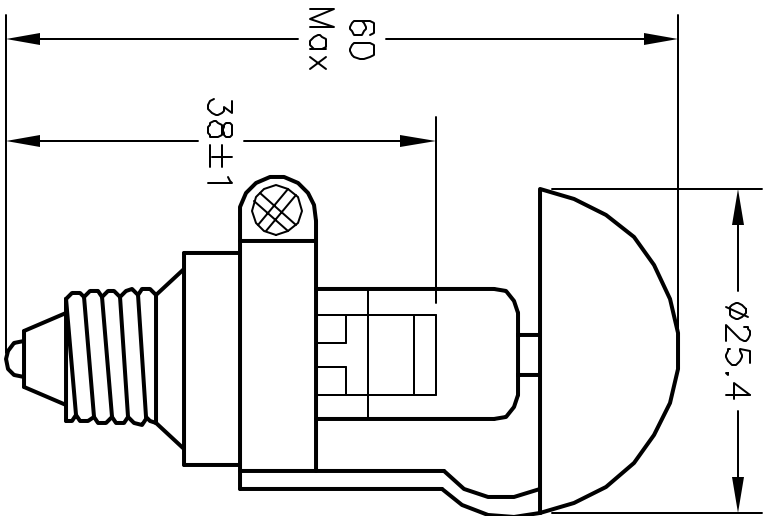

Volts	Watts	L m	°K	Hr	Base
24	40	720	2900	600	E 11

DISCLAIMER:
ALL STATEMENTS AND TECHNICAL INFORMATION CONTAINED HEREIN ARE BASED UPON INFORMATION AND/OR TESTS WE BELIEVE TO BE ACCURATE AND RELIABLE. SINCE CONDITIONS OF USE ARE BEYOND OUR CONTROL, THE USER SHALL DETERMINE THE SUITABILITY OF THE PRODUCT FOR THE INTENDED USE AND ASSUME ALL RISK AND LIABILITY WHATSOEVER IN CONNECTION THEREWITH.



SPC TECHNOLOGY

UNLESS OTHERWISE SPECIFIED,

DRAWN BY: Jeff McVicker

DATE: 10/7/99

DIMENSIONS ARE FOR REFERENCE PURPOSES ONLY.

CHECKED BY: John Cole

DATE: 2/11/00

APPROVED BY: Daniel Carey

DATE: 4/5/00

DRAWING TITLE:

Miniature Lamp

SIZE DWG. NO.

A A1-010-28

ELECTRONIC FILE

92N5565.dwg

REV

A