

| Type | Size | Description | Part No. |
|--------------|-----------|--------------------------|-------------|
| Incandescent | T4 (T-1¼) | SubMiniature Bi-Pin Lamp | (see table) |

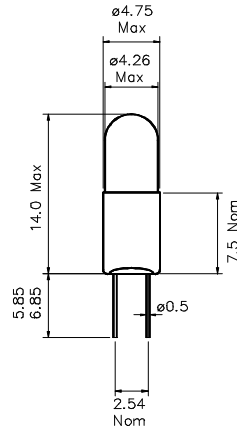

Drawing not to scale
All dimensions in mm

PHOTOMETRY DATA

| Farnell Part No. | SLI P/N | Lamp Rating | Test Volts | Current (mA) | | | Light Output (Lm) | | | Fil Shape | Life (Hrs) |
|------------------|---------|-------------|------------|--------------|-----|-----|-------------------|-----|-----|-----------|------------|
| | | | | Min | Nom | Max | Min | Nom | Max | | |
| 329174 | 7309 | 6V 0.36W | 6 | 54 | 60 | 66 | 1.3 | 1.6 | 2.0 | C-2R | 3000 |
| 329186 | 747BP | 12V 0.36W | 12 | 27 | 30 | 33 | 0.5 | 0.7 | 0.9 | C-2V | 3000 |
| 3167914 | 7646 | 14V 1.12W | 14 | 72 | 80 | 88 | 4.7 | 6.3 | 7.9 | C-2F | 1000 |
| 329198 | 1091BP | 24V 0.84W | 24 | 31 | 35 | 39 | 1.4 | 1.9 | 2.4 | C-2F | 7500 |
| 653550 | 7632 | 28V 1.12W | 28 | 36 | 40 | 44 | 3.0 | 4.0 | 5.0 | C-2F | 1000 |

NOTES:

- 1) T1¼ Bi-Pin base, GY2.5 in accordance with IEC 61-1, (BS EN 60061-1), sheet 7004-3-x.
Colour: White, Material Nylon.
- 2) Nylon base to be durably marked with trademark and Part No.