

ALL RIGHTS RESERVED. NO PORTION OF THIS PUBLICATION, WHETHER IN WHOLE OR IN PART CAN BE REPRODUCED WITHOUT THE EXPRESS WRITTEN CONSENT OF SPC TECHNOLOGY.

REVISIONS			DOC. NO. SPC-F005	Effective: 12/21/98	DCP No: 860			
DCP #	REV	DESCRIPTION	DRAWN	DATE	CHECKD	DATE	APPRVD	DATE
	B	REVISED & REDRAWN	J.C.	2/3/93			J.L.	
948	C	CHG. TO TABULAR SPEC. WAS IN 73**	HYO	7/11/00	J.C.	11/22/00	J.C.	11/22/00

SPC TYPE NO.	VOLTS	AMPS	WATTS	MSCP	FILAMENT	LCL	LIFE (HOURS)
3149	5	0.06	0.3	0.15	C-2R	0.51	5000
7327	28	0.04	1.12	0.34	C-2F	0.5	4000
7328	6	0.2	1.2	0.6	C-2R	N/A	1000
7330	14	0.08	1.12	0.5	C-2F	N/A	1500
7349	6.3	0.2	1.26	0.55	C-2R	0.5	5000
7361	5	0.06	0.3	0.05	C-2R	0.5	25000
7362	5	0.115	0.575	0.15	C-2R	0.5	40000
7367	10	0.04	0.4	0.08	C-2F	0.5	5000
7371	12	0.04	0.48	0.12	C-2F	0.5	10000
7373	14	0.1	1.4	0.5	C-2F	0.5	10000
7374	28	0.04	1.12	0.15	C-2F	0.5	10000
7377	6.3	0.075	0.473	0.23	C-2R	0.5	1000
7380	6.3	0.04	0.252	0.02	C-2V	0.5	20000
7381	6.3	0.2	1.26	0.4	C-2F	0.5	20000
7382	14	0.08	1.12	0.3	C-2F	0.5	15000
7387	28	0.04	1.12	0.3	C-2F	0.5	7000
7876	28	0.06	1.68	0.34	C-2F	0.5	25000

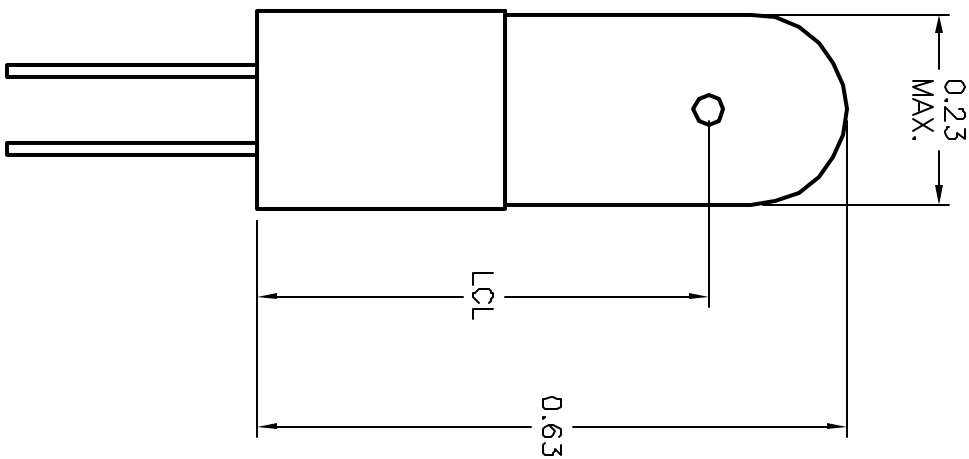

DISCLAIMER
 ALL STATEMENTS AND TECHNICAL INFORMATION CONTAINED HEREIN ARE BASED UPON INFORMATION AND/OR TESTS WE BELIEVE TO BE ACCURATE AND RELIABLE. SINCE CONDITIONS OF USE ARE BEYOND OUR CONTROL, THE USER SHALL DETERMINE THE SUITABILITY OF THE PRODUCT FOR THE INTENDED USE AND ASSUME ALL RISK AND LIABILITY WHATSOEVER IN CONNECTION THEREWITH.

UNLESS OTHERWISE SPECIFIED, DIMENSIONS ARE FOR REFERENCE PURPOSES ONLY.

DRAWN BY:	DATE:
J.C.	1/27/92
CHECKED BY:	DATE:
J.P.	2/8/93
APPROVED BY:	DATE:
J.L.	2/9/93

DRAWING TITLE:

T 1-3/4 BI-PIN BASE LAMP



SPC TECHNOLOGY

SIZE	DWG. NO.	ELECTRONIC FILE	REV
A	TA-271	TA-271.DWG	C
SCALE:	NTS	U.O.M.: INCHES	SHEET: 1 OF 1