

forge EUROPA 0.8" (20 mm) RH decimal point Single Digit Blue 7 Segment Display

Features:

- Grey face colour, White segment colour.
- Two performance options, HE Blue and Blue.
- Choice of two wavelength, HE Blue 465 nm and Blue 428 nm.
- Distinctive blue colour ideal for a host of applications including audio, instrumentation and corporate signage.
- Very economical.
- Wide viewing angle.

Font design

Product not shown
actual size



Electro / Optical Characteristics - $I_F = 20 \text{ mA}$ (* HE Blue - $I_F = 10 \text{ mA}$) $T_a = 25^\circ \text{ C}$

Part Number - Common Cathode		Part Number - Common Anode		Emitting Colour	Wavelength Peak λ_p	Forward Voltage V_F		Luminous Intensity I_v	
Farnell	Forge Europa	Farnell	Forge Europa			typical	max	min	typical
366-4764	FN1-0801B050SGW	366-4776	FN1-0802B050SGW	* HE Blue	465	3.30	3.70	-	18
366-4788	FN1-0801B010SGW	366-4790	FN1-0802B010SGW	Blue	428	3.80	4.50	-	12
Units					nm	V		mcd per segment	

Maximum Ratings $T_a = 25^\circ \text{ C}$ - Derate above 25° C

Characteristic	Condition	Symbol	Rating	Units
Pulse Forward Current	0.1 duty cycle @ 1KHz (HE Blue)	I_{FP}	100 (35)	mA
DC Forward Current	(HE Blue)	I_F	25 (15)	mA
Reverse Voltage	$I_R = 100 \mu\text{A}$	V_R	5	V
Power Dissipation		P_D	85	mW
Operating Temperature		T_{opr}	- 25 to + 80	$^\circ \text{ C}$
Storage Temperature		T_{stg}	- 30 to + 85	$^\circ \text{ C}$
Lead soldering temperature	1.6 mm from body - max 3 seconds		260	$^\circ \text{ C}$

Note

Industry standard procedures regarding static must be observed when handling product produced with blue die material.

Farnell

Internet www.farnell.com Sales Tel 0870 120 0200 Sales Fax 0870 120 0201

Data Sheet F_FN1-080XX0SGW
Issue 1 - Sept 2001 Sheet 1 of 2

forge EUROPA 0.8" (20 mm) RH decimal point Single Digit Blue 7 Segment Display

Package Outline

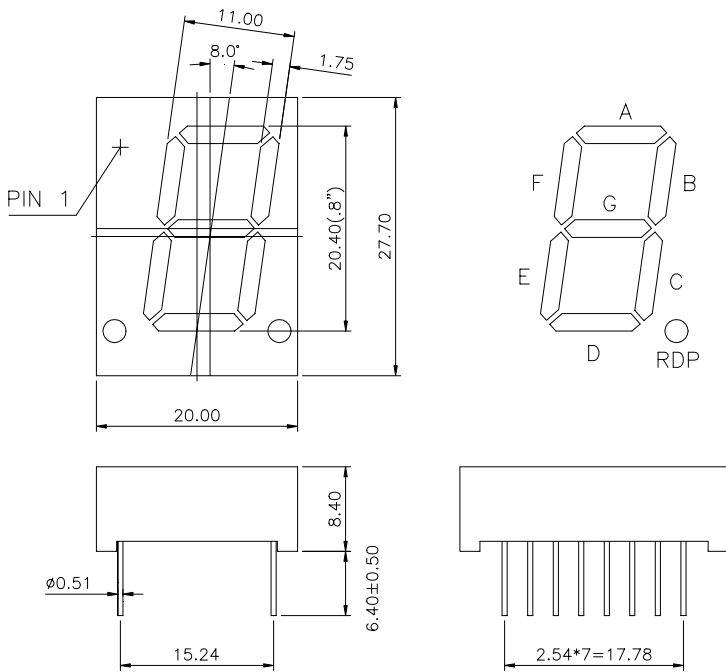

Common Cathode

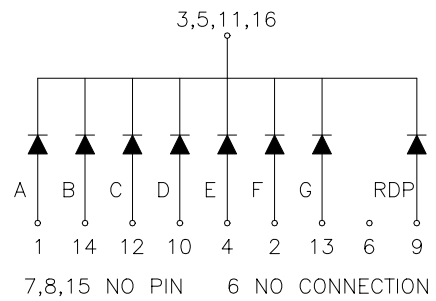

Common Anode

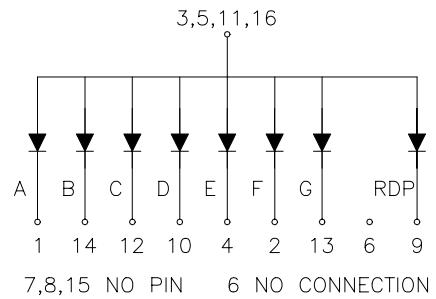

Tolerance ± 0.25 mm unless stated



Internet www.farnell.com Sales Tel 0870 120 0200 Sales Fax 0870 120 0201

Data Sheet F_FN1-080XX0SGW
Issue 1 - Sept 2001 Sheet 2 of 2