

ALL RIGHTS RESERVED. NO PORTION OF THIS PUBLICATION, WHETHER IN WHOLE OR IN PART CAN BE REPRODUCED WITHOUT THE EXPRESS WRITTEN CONSENT OF SPC TECHNOLOGY.

REVISIONS		DOC. NO.	DATE	CHECKED	DATE	APPROVED	DATE
DQP #	REV	DESCRIPTION	DRAWN	DATE	CHECKED	DATE	APPROVED
1948	A	RELEASED	JIN	09/29/08	JWM	09/29/08	JWM

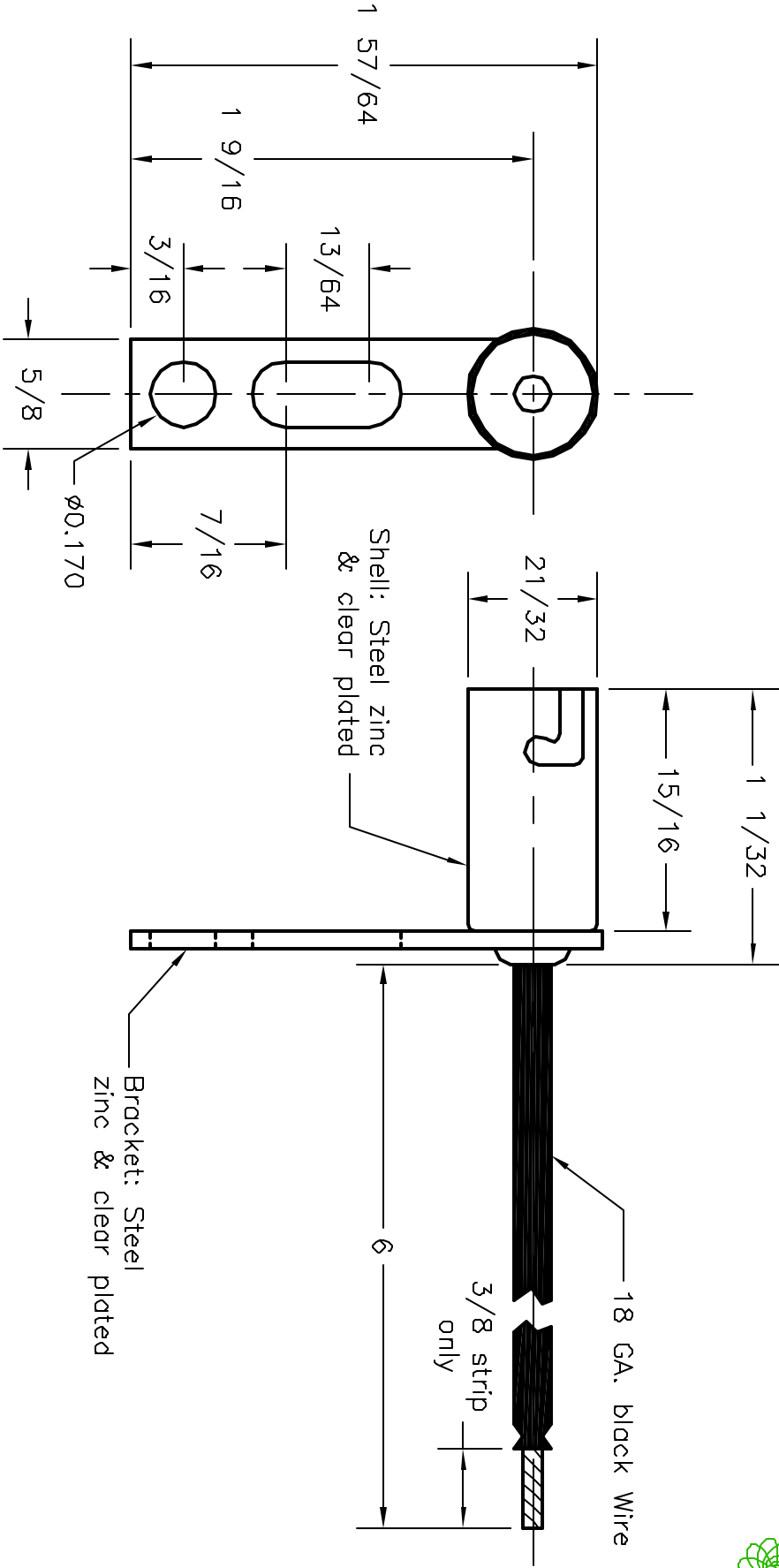

DISCLAIMER:
 ALL STATEMENTS AND TECHNICAL INFORMATION CONTAINED HEREIN ARE BASED UPON INFORMATION AND/OR TESTS WE BELIEVE TO BE ACCURATE AND RELIABLE. SINCE CONDITIONS OF USE ARE BEYOND OUR CONTROL, THE USER SHALL DETERMINE THE SUITABILITY OF THE PRODUCT FOR THE INTENDED USE AND ASSUME ALL RISK AND LIABILITY WHATSOEVER IN CONNECTION THEREWITH.

Tolerances Unless Otherwise Specified	Decimal	.XXX .005
DRAWN BY:	DATE:	Jason Nash
CHECKED BY:	DATE:	JWM
APPROVED BY:	DATE:	JWM

SPC TECHNOLOGY

DRAWING TITLE:
 Single Contact Candelabra Bayonet Lampholder

SIZE	DWG. NO.	ELECTRONIC FILE	REV
A	SPC21738	16M1229.DWG	A
SCALE:	NTS	U.O.M.: INCHES	SHEET: 1 OF 1