

TIP31, TIP32

High Power Bipolar Transistor

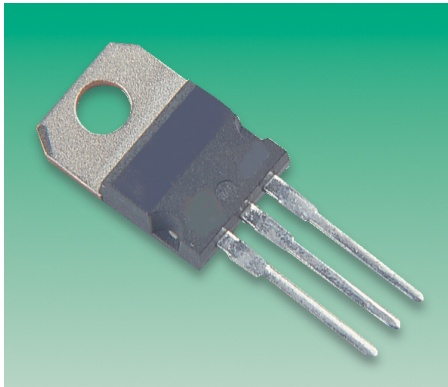

Features:

- Collector-Emitter sustaining voltage -
 $V_{CE(sus)} = 60V$ (Minimum) - TIP31A, TIP32A
 $= 100V$ (Minimum) - TIP31C, TIP32C.
- Collector-Emitter saturation voltage -
 $V_{CE(sat)} = 1.2V$ (Maximum) at $I_C = 3.0A$.
- Current gain-bandwidth product $f_T = 3.0MHz$ (Minimum) at $I_C = 500mA$.

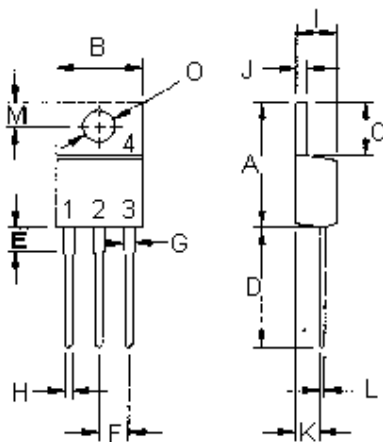

- Pin 1. Base
 2. Collector
 3. Emitter
 4. Collector(Case).

| Dimensions | Minimum | Maximum |
|------------|---------|---------|
| A | 14.68 | 15.31 |
| B | 9.78 | 10.42 |
| C | 5.01 | 6.52 |
| D | 13.06 | 14.62 |
| E | 3.57 | 4.07 |
| F | 2.42 | 3.66 |
| G | 1.12 | 1.36 |
| H | 0.72 | 0.96 |
| I | 4.22 | 4.98 |
| J | 1.14 | 1.38 |
| K | 2.20 | 2.97 |
| L | 0.33 | 0.55 |
| M | 2.48 | 2.98 |
| O | 3.70 | 3.90 |

Dimensions : Millimetres

NPN
 TIP31A
 TIP32C

PNP
 TIP32A
 TIP32C

3 Ampere
 Complementary Silicon
 Power Transistors
 60 - 100 Volts
 40 Watts

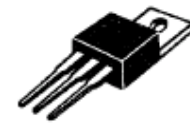

TO-220



TIP31, TIP32

High Power Bipolar Transistor



Maximum Ratings

| Characteristic | Symbol | TIP31A TIP32A | TIP31C TIP32C | Unit |
|--|----------------|------------------|------------------|--------------------------|
| Collector-Emitter Voltage | V_{CEO} | 60 | 100 | V |
| Collector-Base Voltage | V_{CBO} | | | |
| Emitter-Base Voltage | V_{EBO} | 5.0 | | |
| Collector Current-Continuous -Peak | I_C | 3.0 5.0 | | A |
| Base Current | I_B | 1.0 | | |
| Total Power Dissipation at $T_C = 25^\circ\text{C}$ Derate above 25°C | P_D | 40 0.32 | | W W/ $^\circ\text{C}$ |
| Operation and Storage Junction Temperature Range | T_J, T_{STG} | -65 to +150 | | $^\circ\text{C}$ |

Thermal Characteristics

| Characteristic | Symbol | Maximum | Unit |
|-------------------------------------|-----------------|---------|--------------------|
| Thermal Resistance Junction to case | $R_{\theta jc}$ | 3.125 | $^\circ\text{C/W}$ |

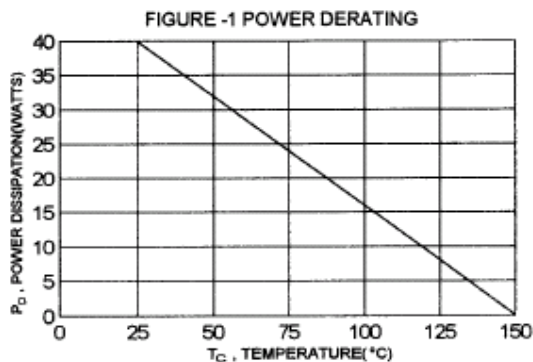

TIP31, TIP32

High Power Bipolar Transistor



Electrical Characteristics ($T_c = 25^\circ\text{C}$ unless otherwise noted)

| Characteristic | Symbol | Minimum | Maximum | Unit |
|--|----------------|-----------|---------|------|
| OFF Characteristics | | | | |
| Collector-Emitter Sustaining Voltage (1) ($I_C = 30\text{mA}$, $I_B = 0$) TIP31A, TIP32A TIP31C, TIP32C | $V_{CEO(sus)}$ | 60 100 | - | V |
| Collector Cut off Current ($V_{CE} = 30\text{V}$, $I_B = 0$) ($V_{CE} = 60\text{V}$, $I_B = 0$) TIP31A, TIP32A TIP31C, TIP32C | I_{CEO} | - | 0.3 | mA |
| Collector Cut off Current ($V_{CE} = 60\text{V}$, $V_{EB} = 0$) ($V_{CE} = 100\text{V}$, $V_{EB} = 0$) TIP31A, TIP32A TIP31C, TIP32C | I_{CES} | - | 0.2 | |
| Emitter Cut off Current ($V_{EB} = 5.0\text{V}$, $I_C = 0$) | I_{EBO} | - | 1.0 | |
| ON Characteristics (1) | | | | |
| DC Current Gain ($I_C = 1.0\text{A}$, $V_{CE} = 4.0\text{V}$) ($I_C = 3.0\text{A}$, $V_{CE} = 4.0\text{V}$) | h_{FE} | 25 10 | - 50 | - |
| Collector-Emitter Saturation Voltage ($I_C = 3.0\text{A}$, $I_B = 375\text{mA}$) | $V_{CE(sat)}$ | - | 1.2 | V |
| Base-Emitter On Voltage ($I_C = 3.0\text{A}$, $V_{CE} = 4.0\text{V}$) | $V_{BE(on)}$ | - | 1.8 | |
| Dynamic Characteristics | | | | |
| Current Gain-Bandwidth Product (2) ($I_C = 500\text{mA}$, $V_{CE} = 10\text{V}$, $f_{TEST} = 1\text{MHz}$) | f_T | 3.0 | - | MHz |
| Small Signal Current Gain ($I_C = 500\text{mA}$, $V_{CE} = 10\text{V}$, $f = 1\text{kHz}$) | h_{FE} | 20 | - | - |

(1) Pulse Test: Pulse width $\leq 300\mu\text{s}$, Duty Cycle $\leq 2.0\%$

(2) $f_T = |h_{FE}| \cdot f_{TEST}$



TIP31, TIP32

High Power Bipolar Transistor



Figure - 2 Switching Time Equivalent Circuit

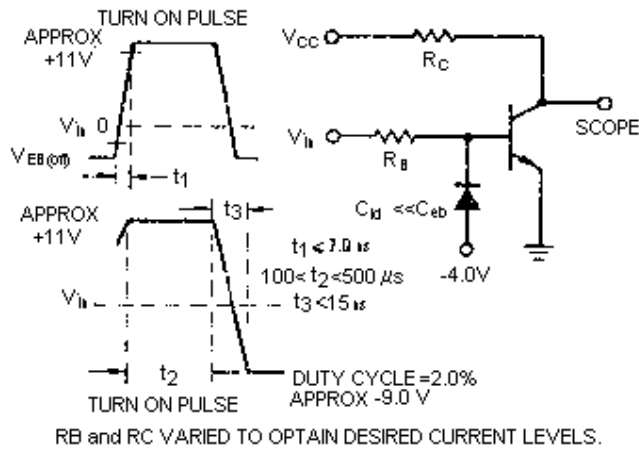

Figure - 3 Turn-On Time

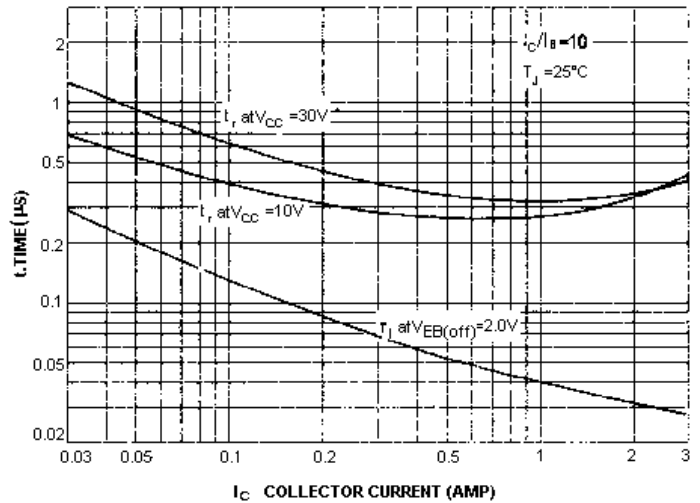

Figure - 4 DC Current Gain

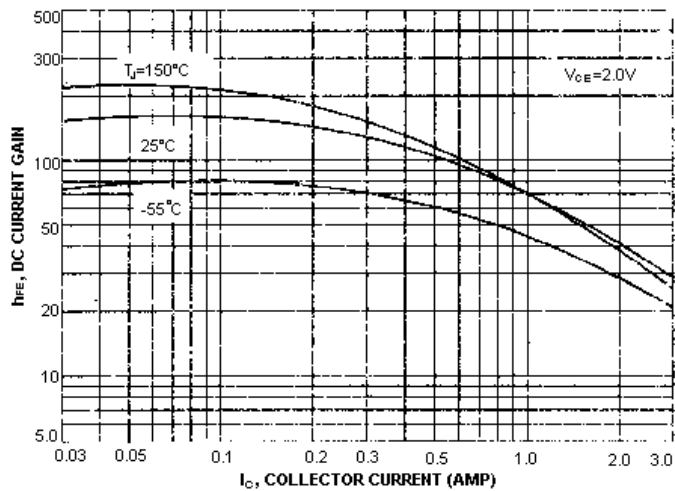
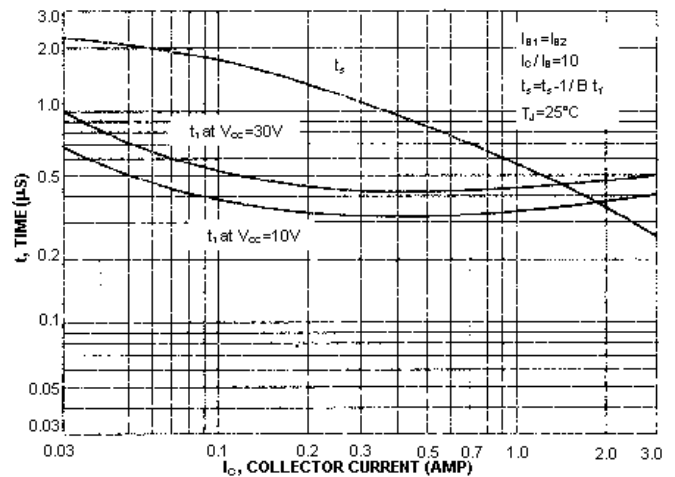

Figure - 5 Turn-Off Time



TIP31, TIP32

High Power Bipolar Transistor



Figure - 6 Active Region Safe Operating Area

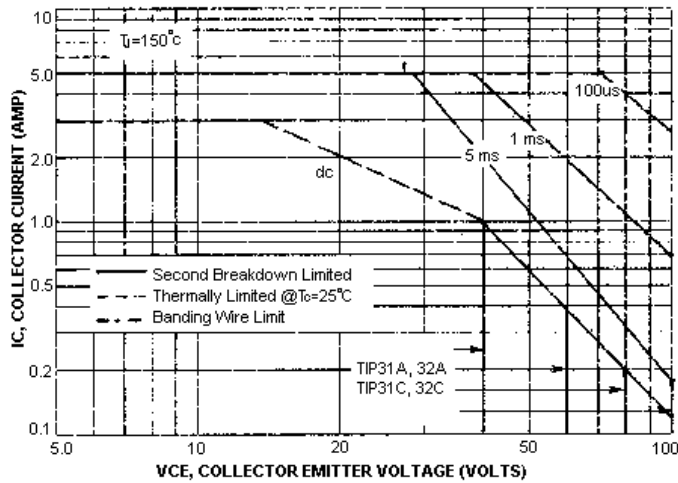

There are two limitations on the power handling ability of a transistor: average junction temperature and second breakdown safe operating area curves indicate I_C - V_{CE} limits of the transistor that must be observed for reliable operation i.e., the transistor must not be subjected to greater dissipation than the curves indicate.

The data of Figure - 6 curve is based on $T_{J(PK)} = 150^\circ\text{C}$; T_C is variable depending on power level. Second breakdown pulse limits are valid for duty cycles to 10% provided $T_{J(PK)} \leq 150^\circ\text{C}$. At high case temperatures, thermal limitation will reduce the power that can be handled to values less than the limitations imposed by second breakdown.

Figure - 7 Collector Saturation Region

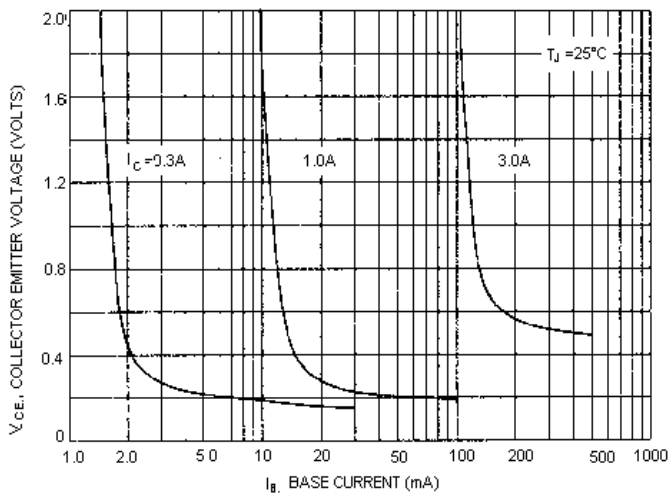
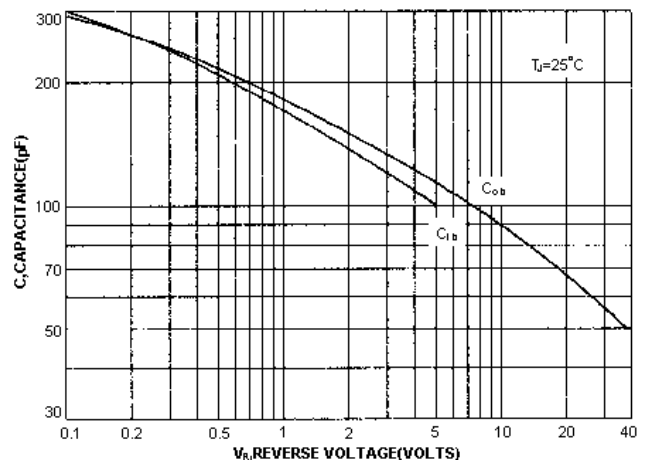

Figure - 8 Capacitances



TIP31, TIP32

High Power Bipolar Transistor



Figure - 9 "ON" Voltage

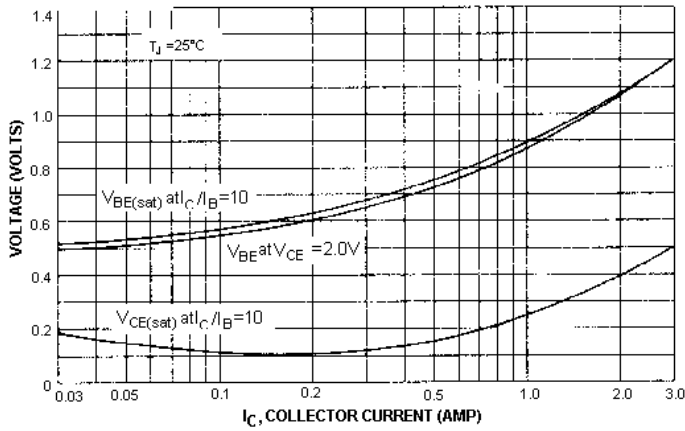
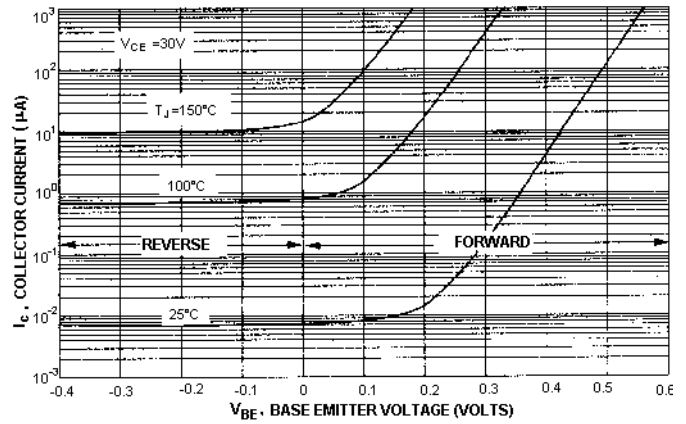

Figure - 10 Collector Cut-off Region



Specifications

| TYPE | Part Number |
|------|-------------|
| NPN | TIP31A |
| | TIP31C |
| PNP | TIP32A |
| | TIP32C |



TIP31, TIP32

High Power Bipolar Transistor



Notes:

International Sales Offices:

| | | | |
|--|--|---|--|
|  AUSTRALIA – Farnell InOne Tel No: ++ 61 2 9645 8888 Fax No: ++ 61 2 9644 7898 |  FINLAND – Farnell InOne Tel No: ++ 358 9 560 7780 Fax No: ++ 358 9 345 5411 |  NETHERLANDS – Farnell InOne Tel No: ++ 31 30 241 7373 Fax No: ++ 31 30 241 7333 |  SWITZERLAND – Farnell InOne Tel No: ++ 41 1 204 64 64 Fax No: ++ 41 1 204 64 54 |
|  AUSTRIA – Farnell InOne Tel No: ++ 43 662 2180 680 Fax No: ++ 43 662 2180 670 |  FRANCE – Farnell InOne Tel No: ++ 49 89 61 39 39 39 Fax No: ++ 33 474 68 99 90 |  NEW ZEALAND – Farnell InOne Tel No: ++ 64 9 357 0646 Fax No: ++ 64 9 357 0656 |  UK – Farnell InOne Tel No: ++ 44 8701 200 200 Fax No: ++ 44 8701 200 201 |
|  BELGIUM – Farnell InOne Tel No: ++ 32 3 475 2810 Fax No: ++ 32 3 227 3648 |  GERMANY – Farnell InOne Tel No: ++ 49 89 61 39 39 39 Fax No: ++ 49 89 613 59 01 |  NORWAY – Farnell InOne Tel No: ++ 45 44 53 66 66 Fax No: ++ 45 44 53 66 02 |  UK – BuckHickman InOne ++ 44 8450 510 150 ++ 44 8450 510 130 |
|  BRAZIL – Farnell-Newark InOne Tel No: ++ 55 11 4066 9400 Fax No: ++ 55 11 4066 9410 |  HONG KONG – Farnell-Newark InOne Tel No: ++ 852 2268 9888 Fax No: ++ 852 2268 9899 |  PORTUGAL – Farnell InOne Tel No: ++ 34 93 475 8804 Fax No: ++ 34 93 474 5288 |  UK – CPC ++ 44 8701 202 530 ++ 44 8701 202 531 |
|  CHINA – Farnell-Newark InOne Tel No: ++86 10 6238 5152 Fax No: ++86 10 6238 5022 |  IRELAND – Farnell InOne Tel No: ++ 353 1 830 9277 Fax No: ++ 353 1 830 9016 |  SINGAPORE – Farnell-Newark InOne Tel No: ++ 65 6788 0200 Fax No: ++ 65 6788 0300 |  EXPORT – Farnell InOne Tel No: ++ 44 8701 200 208 Fax No: ++ 44 8701 200 209 |
|  DENMARK – Farnell InOne Tel No: ++ 45 44 53 66 44 Fax No: ++ 45 44 53 66 06 |  ITALY – Farnell InOne Tel No: ++ 39 02 93 995 200 Fax No: ++ 39 02 93 995 300 |  SPAIN – Farnell InOne Tel No: ++ 34 93 475 8805 Fax No: ++ 34 93 474 5107 | |
|  ESTONIA – Farnell InOne Tel No: ++ 358 9 560 7780 Fax No: ++ 358 9 345 5411 |  MALAYSIA – Farnell-Newark InOne Tel No: ++ 60 3 7873 8000 Fax No: ++ 60 3 7873 7000 |  SWEDEN – Farnell InOne Tel No: ++ 46 8 730 50 00 Fax No: ++ 46 8 83 52 62 | |

For enquiries from all other markets

<http://www.farnellinone.com>

<http://www.buckhickmaninone.com>

<http://www.cpc.co.uk>

Disclaimer This data sheet and its contents (the "Information") belong to the Premier Farnell Group (the "Group") or are licensed to it. No licence is granted for the use of it other than for information purposes in connection with the products to which it relates. No licence of any intellectual property rights is granted. The Information is subject to change without notice and replaces all data sheets previously supplied. The Information supplied is believed to be accurate but the Group assumes no responsibility for its accuracy or completeness, any error in or omission from it or for any use made of it. Users of this data sheet should check for themselves the Information and the suitability of the products for their purpose and not make any assumptions based on information included or omitted. Liability for loss or damage resulting from any reliance on the Information or use of it (including liability resulting from negligence or where the Group was aware of the possibility of such loss or damage arising) is excluded. This will not operate to limit or restrict the Group's liability for death or personal injury resulting from its negligence. Multicomp is the registered trademark of the Group. © Premier Farnell plc 2004.

