

Specification Status: RELEASED

Max Electrical Rating at 20°C

Operating Voltage: 250V_{DC}
Interrupt Current: 3A_{RMS}

Fault Voltage: 600V_{RMS}

Lead Material: 22 AWG Sn plated copper
(0.65 mm [0.026"] nominal diameter)

External Coating Material: Cured, flame retardant epoxy polymer, meeting UL94 V-0 requirements.

Marking:

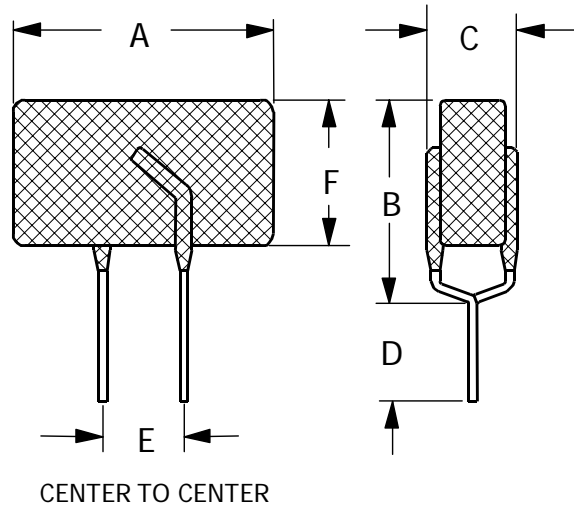
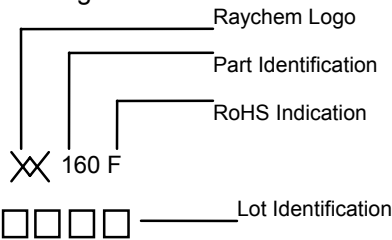

TABLE I. DIMENSIONS:

	A		B		C		D		E	F
	MIN	MAX	MIN	MAX	MIN	MAX	MIN	MAX	NOM	MAX
mm:	--	16.0	--	12.6	--	6.0	4.7	--	5.0	10.0
in:	--	(0.630)	--	(0.496)	--	(0.236)	(0.185)	--	(0.197)	(0.394)

TABLE II. PERFORMANCE RATINGS @ 20°C (unless otherwise noted):

I HOLD (A)	I TRIP (A)	RESISTANCE (Ω)			TIME TO TRIP (s) @ 1A		OPERATING TEMPERATURE (°C)	
		R MIN	R MAX	R _{1MAX} *	TYP	MAX	MIN	MAX
0.160	0.320	4.0	10.0	18.0	7.5	18.0	-40	85

*Maximum device resistance at 20°C measured 1 hour post trip.

Designed to assist equipment meet UL60950

Agency Recognition: UL, CSA
Reference Documents: PS300
Precedence: This specification takes precedence over documents referenced herein.
Effectivity: Reference documents shall be the issue in effect on the date of invitation for bid.
CAUTION: Operation beyond the rated voltage or current may result in rupture, electrical arcing or flame.

Materials Information

ROHS Compliant

Directive 2002/95/EC
Compliant

ELV Compliant

Directive 2000/53/EC
Compliant

Pb-Free

