

**Specification Status: RELEASED**

**Max Electrical Rating at 20°C**

**Operating Voltage: 250V<sub>DC</sub>**  
**Interrupt Current: 3A<sub>RMS</sub>**

**Fault Voltage: 600V<sub>RMS</sub>**

**Lead Material: 22 AWG Sn plated copper**  
(0.65 mm [0.026"] nominal diameter)

**Marking:**

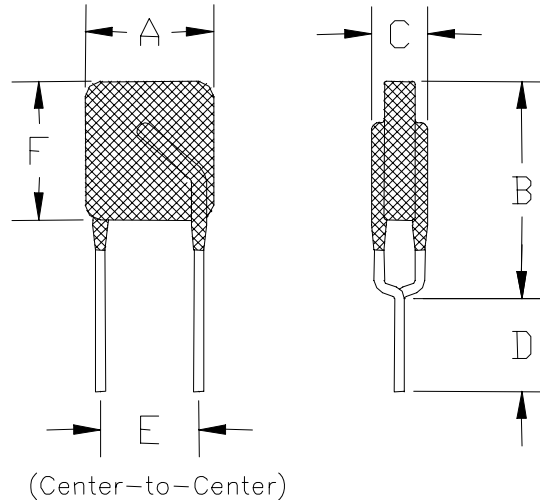
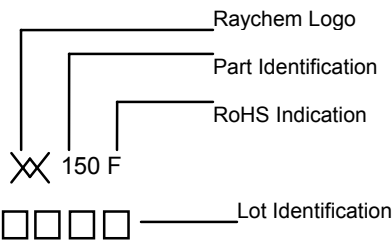

**TABLE I. DIMENSIONS**

|     | A   |         | B   |         | C   |         | D       |     | E       | F   |         |
|-----|-----|---------|-----|---------|-----|---------|---------|-----|---------|-----|---------|
|     | Min | Max     | Min | Max     | Min | Max     | Min     | Max | Nom     | Min | Max     |
| mm: | --  | 9.0     | --  | 12.5    | --  | 4.6     | 4.7     | --  | 5.0     | --  | 9.0     |
| in: | --  | (0.354) | --  | (0.492) | --  | (0.180) | (0.185) | --  | (0.197) | --  | (0.354) |

**TABLE II. PERFORMANCE RATINGS @ 20°C (unless otherwise noted):**

| I <sub>HOLD</sub> (A)** | I <sub>TRIP</sub> (A) | RESISTANCE (Ω) |       |                     | TIME TO TRIP (s)<br>@ 1A |     | OPERATING TEMPERATURE (°C) |     |
|-------------------------|-----------------------|----------------|-------|---------------------|--------------------------|-----|----------------------------|-----|
|                         |                       | R MIN          | R MAX | R <sub>1MAX</sub> * | TYP                      | MAX | MIN                        | MAX |
| 0.130                   | 0.300                 | 9.0            | 12.0  | 22.0                | 1.0                      | 3.0 | -40                        | 85  |

\* Maximum device resistance at 20°C measured 1 hour post trip.

\*\*Dependant on heat sinking.

Designed to assist equipment meet UL60950

Agency Recognitions: UL, CSA, TUV  
Reference Documents: PS300  
Precedence: This specification takes precedence over documents referenced herein.  
Effectivity: Reference documents shall be the issue in effect on the date of invitation for bid.  
CAUTION: Operation beyond the rated voltage or current may result in rupture, electrical arcing or flame.

**ROHS Compliant**

**ELV Compliant**

**Pb-Free**

Directive 2002/95/EC  
Compliant

Directive 2000/53/EC  
Compliant

