

**Specification Status: Released**

**Maximum Electrical Rating**

**Voltage: 9.0V<sub>DC</sub>**  
**Short Circuit Current: 40A**

**Notes:**

1. All terminations are Tin plated.
2. Drawing not to scale

**Marking: E**

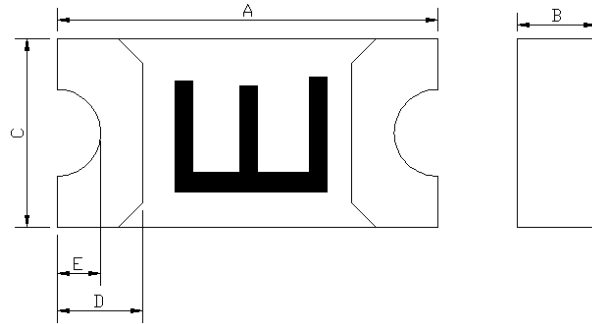

**TABLE I. DIMENSIONS:**

	A		B		C		D		E
	MIN	MAX	MIN	MAX	MIN	MAX	MIN	MAX	MIN
mm:	1.40	1.80	0.35	0.75	0.60	1.00	0.10	0.50	0.075
in:	(0.055)	(0.071)	(0.013)	(0.030)	(0.023)	(0.039)	(0.004)	(0.020)	(0.003)

**TABLE II. PERFORMANCE RATINGS:**

CURRENT RATINGS**								TIME TO TRIP**	RESISTANCE VALUES	TRIPPED-STATE POWER DISSIPATION**	
AMPERES AT 0°C		AMPERES AT 25°C		AMPERES AT 60°C		AMPERES AT 85°C		SECONDS AT 25°C, 1.0A MAX	OHMS AT 25°C	WATTS AT 25°C, 9.0V MAX	
HOLD	TRIP	HOLD	TRIP	HOLD	TRIP	HOLD	TRIP		MIN	MAX*	
0.18	0.45	0.16	0.40	0.11	0.28	0.07	0.17	0.1	1.00	4.20	0.5

\* Maximum resistance is measured 1 hour after reflow.

\*\* Values specified were determined using PCB's with 0.030"x1.0 ounce copper traces.

Agency Recognitions: UL, CSA  
Reference Documents: PS300  
Precedence: This specification takes precedence over documents referenced herein.  
Effectivity: Reference documents shall be the issue in effect on the date of invitation for bid.  
Caution: Operation beyond the rated voltage or current may result in rupture, electrical arcing or flame.

**Materials Information**

**ROHS Compliant**

**ELV Compliant**

**Pb-Free**

**Halogen Free\***

Directive 2002/95/EC  
Compliant

Directive 2000/53/EC  
Compliant



\* Halogen Free refers to: Br≤900ppm, Cl≤900ppm, Br+Cl≤1500ppm.