

UMT 250



IEC 60127-4 · 250/125 VAC/DC · Time-Lag T

**Description**

- Directly solderable on printed circuit boards

Standards

- IEC 60127-4
- UL 248-14
- CSA C22.2 no. 248.14

Approvals

- VDE License Number: 40013121
- UL File Number: E41599

References

- [General Product Information](#)
- Time-Current Curves see last page
- [Packaging Details](#)

Weblinks

- Approvals: <http://www.schurter.com/approvals>
- RoHS: <http://www.schurter.com/rohs>

Technical Data

Rated Voltage	250 VAC / 125 VDC
Rated Current	0.315 - 4 A
Breaking Capacity	200 A
Characteristic	Time-Lag T
Mounting	PCB,SMT
Admissible Ambient Air Temp.	-55 °C to 125 °C
Climatic Category	55/125/21 acc. to IEC 60068-1
Material: Housing	Ceramic
Material: Terminals	Tin-Plated Copper Alloy
Unit Weight	0.23 g
Stock Conditions	0 °C to 60 °C, max. 70% r.h.
Product Marking	, Current Rating, Voltage Rating, Characteristic, Breaking Capacity

Soldering Methods	Reflow, Wave
Solderability	245 °C / 3 sec acc. to IEC 60068-2-58, Test Td
Resistance to Soldering Heat	260 °C / 10 sec acc. to IEC 60068-2-58, Test Td
Flammability	min. UL 94V-1 (acc. to EIA/IS-722, Test 4.12)

Dimensions

Length 10.1 mm

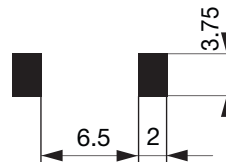
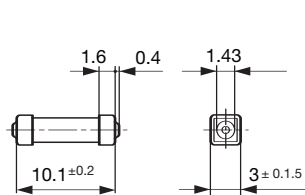

Solder pads reflow soldering

UMT 250

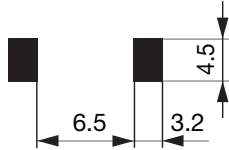







Solder pads wave soldering

Pre-Arcing Time

Rated Current I_n	1.25 x I_n min.	2.0 x I_n max.	10.0 x I_n min.	10.0 x I_n max.
0.315 A - 4 A	60 min	120 s	10 ms	100 ms

Variants

Order Number	Rated Current [A]	Rated Voltage [V]	Rated Voltage [VDC]	Breaking Capacity	Voltage Drop 1.0 I_n max [mV]	Voltage Drop 1.0 I_n typ [mV]	Power Dissipation 1.25 I_n typ [mW]	Melting I ² t 10.0 I_n typ [A ² s]	     
3403.0161.xx	0.315	250	125	1)	750	343	500	0.27	● ● ● ● ● ●
3403.0162.xx	0.4	250	125	1)	700	290	500	0.4	● ● ● ● ● ●
3403.0163.xx	0.5	250	125	1)	600	257	500	0.54	● ● ● ● ● ●
3403.0164.xx	0.63	250	125	1)	500	216	500	1.1	● ● ● ● ● ●
3403.0165.xx	0.8	250	125	1)	400	190	500	1.4	● ● ● ● ● ●
3403.0166.xx	1	250	125	1)	300	164	500	2.8	● ● ● ● ● ●
3403.0167.xx	1.25	250	125	1)	300	138	1000	4.5	● ● ● ● ● ●
3403.0168.xx	1.6	250	125	1)	300	124	1000	6.9	● ● ● ● ● ●
3403.0169.xx	2	250	125	1)	300	106	1000	7.3	● ● ● ● ● ●
3403.0170.xx	2.5	250	125	1)	300	124	1200	7.5	● ● ● ● ● ●
3403.0171.xx	3.15	250	125	1)	300	99	1500	14	● ● ● ● ● ●
3403.0172.xx	4	250	125	1)	300	78	2000	26	● ● ● ● ● ●

1) IEC/UL: 200 A @ 250 VAC, p.f. \geq 0.95 / 100 A @ 125 VDC

1) UR: 200 A @ 277 VAC, p.f. \geq 0.95 / 100 A @ 125 VDC / 35 A @ 250 VDC

1) PSE: 100 A @ 250 VAC / 100 A @ 125 VDC

Packaging Unit

.xx = .11 Plastic Bag (100 pcs.)

.xx = .24 Blister Tape 33 cm Reel (2000 pcs.)

UMT 250

