

Central Page  
2/10/2019

# List Numbers and Dimensions

## TF 125-200A rating Extended Motor Range 200M250 & 200M315†

178-452  
+  
178-453

Rating	List Numbers
Amp	For ordering purposes
125	TF125
160	TF160
200	TF200
200M250	TF200M250†
200M315	TF200M315†

### Dimensions in millimetres & inches

	A	B	D	E	F	G	H	J	M
						Fixing Centres			
mm	70 00	34 90	136 50	19 10	3 20	111 00	8 70	11 90	79 40
inches	2¾	1⅜	5⅝	¾	⅛	4⅜	1½	1½	3⅛
† mm	77 00	41 30	136 50	19 10	3 20	111 00	8 70	11 90	79 40
† inches	3½	1⅝	5⅝	¾	⅛	4⅜	1½	1½	3⅛

BS88 1975 Dimensional Ref B2

## TKF 250 & 315A rating Extended Motor Range 315M355†

Rating	List Numbers
Amp	For ordering purposes
250	TKF250
315	TKF315
315M355	TKF315M355†

### Dimensions in millimetres & inches

	A	B	D	E	F	G	H	J	M
						Fixing Centres			
mm	77 00	54 00	136 50	25 40	3 20	111 00	8 70	11 90	82 00
inches	3½	2⅛	5⅝	1	⅛	4⅜	1½	1½	3¼

BS88 1975 Dimensional Ref B3

## TKM 250 & 315A rating

Rating	List Numbers
Amp	For ordering purposes
250	TKM250
315	TKM315

### Dimensions in millimetres & inches

	A	B	D	E	F	G	H	J	M
						Fixing Centres			
mm	77 00	54 00	160 20	25 40	3 20	133 40	10 30	13 50	82 00
inches	3½	2⅛	6⅝	1	⅛	5¼	1¾	1¾	3¼

## TMF 355 & 400A rating Extended Motor Range 400M450†

Rating	List Numbers
Amp	For ordering purposes
355	TMF355
400	TMF400
400M450	TMF400M450†

### Dimensions in millimetres & inches

	A	B	D	E	F	G	H	J	M
						Fixing Centres			
mm	83.00	61 10	136 50	25 40	6 30	111 00	8 70	11 90	85 80
inches	3⅝	2¼	5⅝	1	¼	4⅜	1½	1½	3⅝

BS88 1975 Dimensional Ref B4

† Fuse links from the Extended Range for Motor Circuits – See Page 13

# List Numbers and Dimensions

## Central fuses Time-lagging

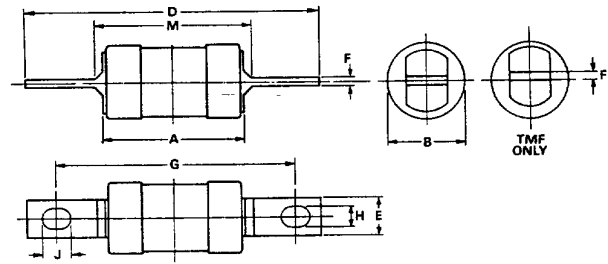
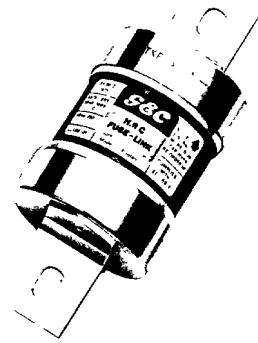

### TB 2-63A rating

Rating Amp	List Numbers For ordering purposes
2	TB2
4	TB4
6	TB6
10	TB10
16	TB16
20	TB20
25	TB25
32	TB32
35	TB35
40	TB40
50	TB50
63	TB63

Dimensions in millimetres & inches

	A	B	D	E	F	G Fixing Centres	H	J	M
mm	58 00	26 20	111 90	12 70	1 60	96 90	7.10	10 30	61 90
inches	2 <sup>3</sup> / <sub>32</sub>	1 <sup>1</sup> / <sub>32</sub>	4 <sup>13</sup> / <sub>32</sub>	1/2	1/16	3 <sup>13</sup> / <sub>16</sub>	9/32	1 <sup>3</sup> / <sub>32</sub>	2 <sup>7</sup> / <sub>16</sub>

### TBC 2-63A rating

Rating Amp	List Numbers For ordering purposes
2	TBC2
4	TBC4
6	TBC6
10	TBC10
16	TBC16
20	TBC20
25	TBC25
32	TBC32
35	TBC35
40	TBC40
50	TBC50
63	TBC63

Dimensions in millimetres & inches

	A	B	D	E	F	G Fixing Centres	H	J	M
mm	58 00	26 20	128 70	14 30	1 60	111 00	8 70	11 90	61 90
inches	2 <sup>3</sup> / <sub>32</sub>	1 <sup>1</sup> / <sub>32</sub>	5 <sup>1</sup> / <sub>16</sub>	9/16	1/16	4 <sup>3</sup> / <sub>8</sub>	1 <sup>1</sup> / <sub>32</sub>	1 <sup>5</sup> / <sub>32</sub>	2 <sup>7</sup> / <sub>16</sub>

### TC 80 & 100A rating

Extended Motor Range  
100M125 & 100M200†

Rating Amp	List Numbers For ordering purposes
80	TC80
100	TC100
100M125	TC100M125†
100M160	TC100M160†
100M200	TC100M200†

Dimensions in millimetres & inches

	A	B	D	E	F	G Fixing Centres	H	J	M
mm	70 00	34 90	136 50	19 10	3 20	111 00	8 70	11 90	79 40
inches	2 <sup>3</sup> / <sub>4</sub>	1 <sup>3</sup> / <sub>8</sub>	5 <sup>3</sup> / <sub>8</sub>	3/4	1/8	4 <sup>3</sup> / <sub>8</sub>	1 <sup>1</sup> / <sub>32</sub>	1 <sup>5</sup> / <sub>32</sub>	3 <sup>1</sup> / <sub>8</sub>

BS88 1975 Dimensional Ref B1

† Fuse links from the Extended Range for Motor Circuits – See Page 13

Type	Ratings Amps	BS88-2 Dimension reference	Maximum voltage rating	
			A.C.	D.C.
NIT	2-20	A1	550	250
NIT†	20M25, 20M32	A1	415	—
TIA	2-32	A2	660	460
TIA†	32M35-32M63	A2	660	460
TIS	35-63	A3	660	460
TIS†	63M80, 63M100	A3	660	—
TCP	80,100	A4	660	460
TCP†	100M125-100M200	A4	660	—
TFP	125-200	—	660	460
TB	2-63	—	660	460
TBC	2-63	—	660	460
TC	80, 100	B1	660	460
TC†	100M125-100M200	B1	660	—
TF‡	125-200	B2	660	350
TF†	200M250	B2	660	460
TF†	200M315	B2	550	—
TKF	250, 315	B3	660	460
TKF†	315M355	B3	660	460
TKM	250, 315	—	660	460
TMF	355, 400	B4	660	460
TMF†	400M 450	B4	660	460
TM	355, 400	C1	660	460
TM†	400M450	C1	660	460
TMT	355, 400	—	660	460
TTM	450-630	C2	660	450
TTM†	630M670	C2	660	450
TT	450-630	—	660	450
TLM‡	670-800	C3	660	350
TLT	670-800	—	660	350
TLU	560-800	—	660	350
TXU	1000, 1250	D1	660	300

† 'Motor Circuit' fuse links. See page 13.

‡ Type TZF and TZLM fuselinks proved at 460V d.c. are available for users who need superior d.c performance in these dimensional references.

**Notes:** 1) Non-standard tag arrangements available – Details on request.

2) A 1600 Amp Type TUV1600 fuse link is also available.

This is outside the scope of the specification. Details on request.