

Description

The Model 40 is a low cost, non-reset totalizer, available with 6-7 figures (white on black background). A wide choice of operating voltages and mountings make this product adaptable for most applications. The Model 40 is an ideal solution for applications that require low cost and product reliability.

Features

- Low cost
- Small size
- DC and AC

Options

- 6 or 7 figure
- Multiple mounting choices
- Voltages

Specifications

**Figures:** 6 or 7 figures, white on black, 0.12" (3 mm) high  
**Reset:** Non-reset  
**Speed:** 600 counts/minute (min. 50ms - on, 50ms - off)  
**Voltage:** 115 VAC, 5, 12 or 24 VDC (+ 10/-15% tolerance)  
**Power:** 1.4 watts AC, 1.0 watts DC (nominal)  
**Mounting:** Rear, behind the panel, snap-in, base or PCB mount

**Terminations:** (2)#22 AWG 221°F [105°C] wire leads, 10.5" [266.7mm] long or (2) 0.03" [0.8mm] Dia. pins for PCB mounting  
**Operating Life:** Beyond 3 million counts  
**Temp. Range:** +23°F to +104°F [-5°C to +40°C]  
**Weight:** Less than 1 oz. [28g]

Models	Description	Models	Description
2-4016	115VAC, 6 figure, rear mount, wire leads	2-4017	115VAC, 7 figure, rear mount, wire leads
R2-4016	115VAC, 6 figure, behind the panel mount, wire leads	R2-4017	115VAC, 7 figure, behind the panel mount, wire leads
R9-4016	12VDC, 6 figure, behind the panel mount, wire leads	R9-4017	12VDC, 7 figure, behind the panel mount, wire leads
SR2-4016	115VAC, 6 figure, snap-in panel mount, wire leads	SR2-4017	115VAC, 7 figure, snap-in panel mount, wire leads
T2-4016	115VAC, 6 figure, PCB mount, pins	T2-4017	115VAC, 7 figure, PCB mount, pins
V8-4016	24VDC, 6 figure, V-base mount, wire leads	V8-4017	24VDC, 7 figure, V-base mount, wire leads



Dimensions

Rear Mount

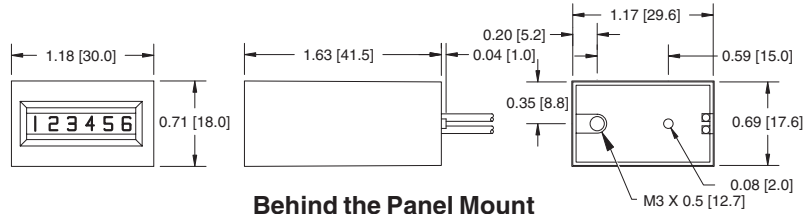

Behind the Panel Mount

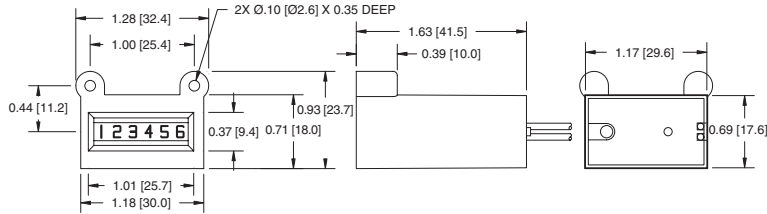

Snap-In Panel Mount

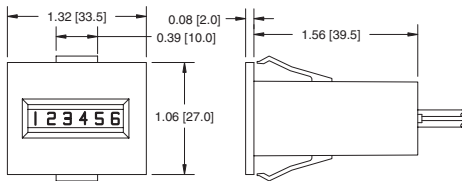

PANEL CUTOUT: 1.20 [30.5] X 0.96 [24.4]  
RECOMMENDED PANEL THICKNESS: 0.04 [1.0] to 0.08 [2.0]

V-Base Mount

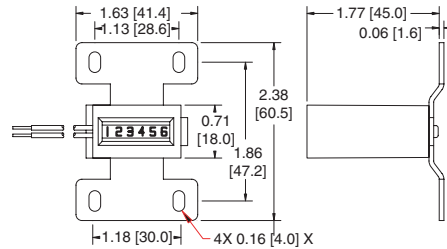

D-Base Mount

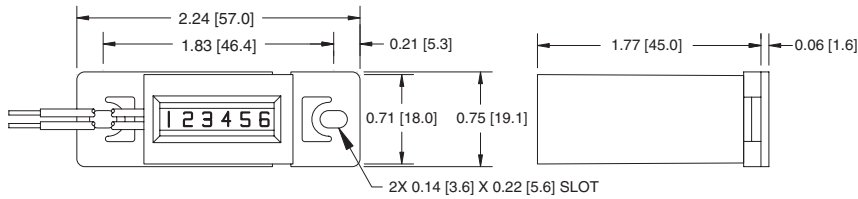

PCB Mount

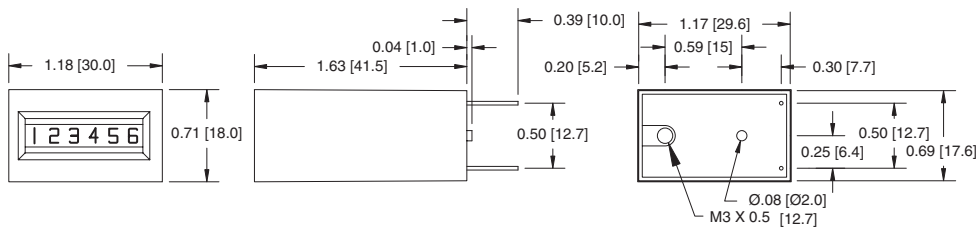

Applications

Vending/Gaming machines



Photocopiers



Items dispenser



Office equipment

