

## Crystalview Moving Coil Meters

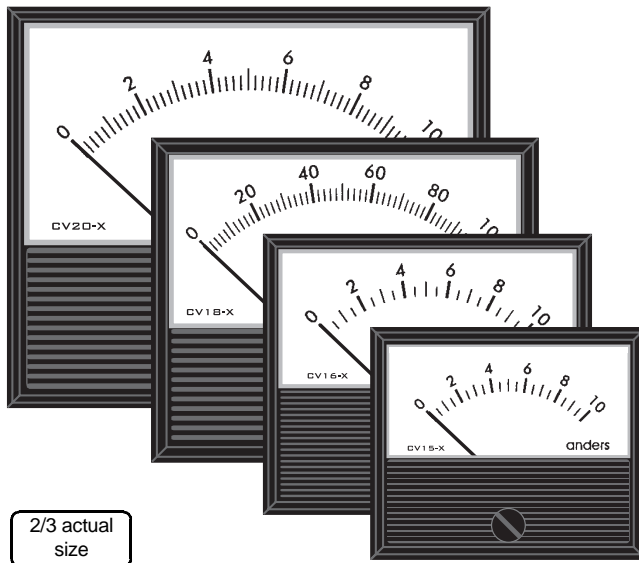

- Attractive and modern design
- Choice of printed scales
- 4 popular sizes
- "Easy-fit" scales
- Class 2.0

A modern and attractive range of quality dc moving coil meters available at very competitive prices.

There are 4 popular sizes which can be either surface or flush mounted behind the panel through a rectangular cutout. The meters utilise a well proven and robust, 90 degree deflection, pivot and jewel moving coil movement.

Meters are supplied in sensitivities of 100 microamps, 100-0-100 microamps (centre zero), 1 milliamps or as 4-20 milliamps (supressed zero) for signal process indication.

Pre-printed scales are available seperately graduated and numbered 0-10, 0-30, 0-100 and 100-0-100.

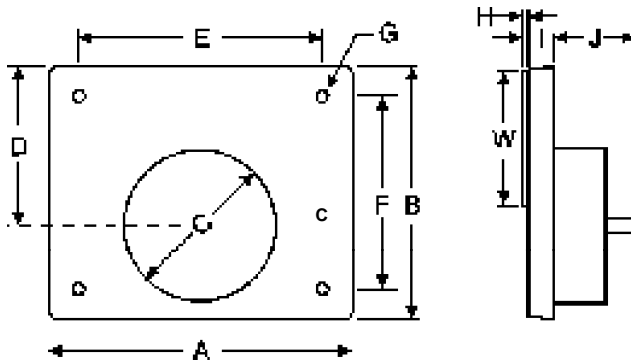

Fixing studs on all meters (Dimension G) are M3 x 12mm

Dimensions in mm

| Model  | A   | B  | C  | D    | E  | F  | H   | I    | J    | W         | Scale Length |
|--------|-----|----|----|------|----|----|-----|------|------|-----------|--------------|
| CV-15X | 57  | 48 | 43 | 24   | 40 | 35 | 1.5 | 14.5 | 28.5 | 50 x 23.5 | 40           |
| CV-16X | 68  | 58 | 45 | 31.5 | 48 | 48 | 1.5 | 14.5 | 28.5 | 61.5 x 28 | 50           |
| CV-18X | 80  | 67 | 50 | 38.5 | 64 | 48 | 1.5 | 14.5 | 28.5 | 72 x 35   | 63           |
| CV-20X | 100 | 83 | 50 | 51.5 | 80 | 64 | 1.5 | 14.5 | 28.5 | 92 x 45   | 78.5         |

| Order Code          | Size   | Range       | Rec. Price £: |    |     |     |     |
|---------------------|--------|-------------|---------------|----|-----|-----|-----|
|                     |        |             | 1+            | 5+ | 10+ | 25+ | 50+ |
| <b>METERS</b>       |        |             |               |    |     |     |     |
| CV15X1MA            | CV-15X | 0-1mA       |               |    |     |     |     |
| CV15X100UA          | CV-15X | 0-100µA     |               |    |     |     |     |
| CV15XCZ100UA        | CV-15X | 100-0-100µA |               |    |     |     |     |
| CV15XSZ20MA         | CV-15X | 100-0-100µA |               |    |     |     |     |
| CV16X1MA            | CV-16X | 0-1mA       |               |    |     |     |     |
| CV16X100UA          | CV-16X | 0-100µA     |               |    |     |     |     |
| CV16XCZ100UA        | CV-16X | 100-0-100µA |               |    |     |     |     |
| CV16XSZ20MA         | CV-16X | 4-20mA      |               |    |     |     |     |
| CV18X1MA            | CV-18X | 0-1mA       |               |    |     |     |     |
| CV18X100UA          | CV-18X | 0-100µA     |               |    |     |     |     |
| CV18XCZ100UA        | CV-18X | 100-0-100µA |               |    |     |     |     |
| CV18XSZ20MA         | CV-18X | 4-20mA      |               |    |     |     |     |
| CV20X1MA            | CV-20X | 0-1mA       |               |    |     |     |     |
| CV20X100UA          | CV-20X | 0-100µA     |               |    |     |     |     |
| CV20XCZ100UA        | CV-20X | 100-0-100µA |               |    |     |     |     |
| CV20XSZ20MA         | CV-20X | 4-20mA      |               |    |     |     |     |
| <b>METER SCALES</b> |        |             |               |    |     |     |     |
| S/CV15XB            | CV-15X | Blank       |               |    |     |     |     |
| S/CV15X10           | CV-15X | 0-10        |               |    |     |     |     |
| S/CV15X30           | CV-15X | 0-30        |               |    |     |     |     |
| S/CV15X100          | CV-15X | 0-100       |               |    |     |     |     |
| S/CV15XCZ100        | CV-15X | 100-0-100   |               |    |     |     |     |
| S/CV16XB            | CV-16X |             |               |    |     |     |     |
| S/CV16X10           | CV-16X | Blank       |               |    |     |     |     |
| S/CV16X30           | CV-16X | 0-30        |               |    |     |     |     |
| S/CV16X100          | CV-16X | 0-100       |               |    |     |     |     |
| S/CV16XCZ100        | CV-16X | 100-0-100   |               |    |     |     |     |
| S/CV18XB            | CV-18X | Blank       |               |    |     |     |     |
| S/CV18X10           | CV-18X | 0-10        |               |    |     |     |     |
| S/CV18X30           | CV-18X | 0-30        |               |    |     |     |     |
| S/CV18X100          | CV-18X | 0-100       |               |    |     |     |     |
| S/CV18XCZ100        | CV-18X | 100-0-100   |               |    |     |     |     |
| S/CV20XB            | CV-20X | Blank       |               |    |     |     |     |
| S/CV20X10           | CV-20X | 0-10        |               |    |     |     |     |
| S/CV20X30           | CV-20X | 0-30        |               |    |     |     |     |
| S/CV20X100          | CV-20X | 0-100       |               |    |     |     |     |
| S/CV20XCZ100        | CV-20X | 100-0-100   |               |    |     |     |     |