

## Rectangular Vu Indicators

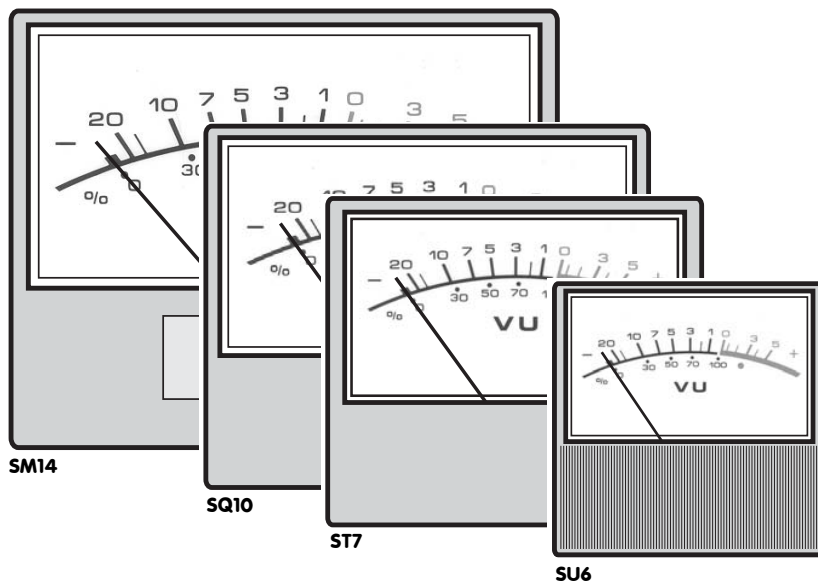

- Flush mounting
- Professional appearance
- Low cost solution
- Easy to back light
- Minimum depth
- Robust
- Ex-stock availability

The meters are robust, low-cost, back-of-panel rectangular Vu moving coil indicators with red and black scaling on a buff background. They can be illuminated by placing a bulb behind the translucent scale.

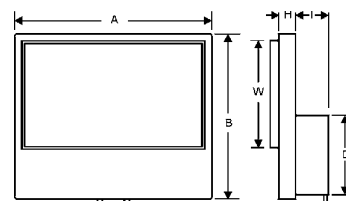

Order Code	Sensitivity ±20%	Resistance ±15%	0 Vu	Internal illumination	Rec. Price £:					
					1+	5+	10+	25+	50+	100+
SU6	0-200 $\mu$ A	650 $\Omega$	130 $\mu$ A	no						
ST7	0-200 $\mu$ A	650 $\Omega$	130 $\mu$ A	no						
SQ10	0-500 $\mu$ A	600 $\Omega$	270 $\mu$ A	8V 50mA						
SM14	0-500 $\mu$ A	600 $\Omega$	270 $\mu$ A	8V 50mA						

Dimensions mm	A	B	W	D	H	I
SU6	40.00	40.00	21.5 x 36.5 x 3.0	20.00	8.00	12.50
ST7	55.00	47.50	50.0 x 28.0 x 3.0	18.50	7.00	14.00
SQ10	64.50	53.50	60.0 x 35.0 x 3.0	18.00	12.00	13.00
SM14	79.20	63.00	73.7 x 37.6 x 3.0	26.50	12.00	13.00

## Circular Vu Indicators

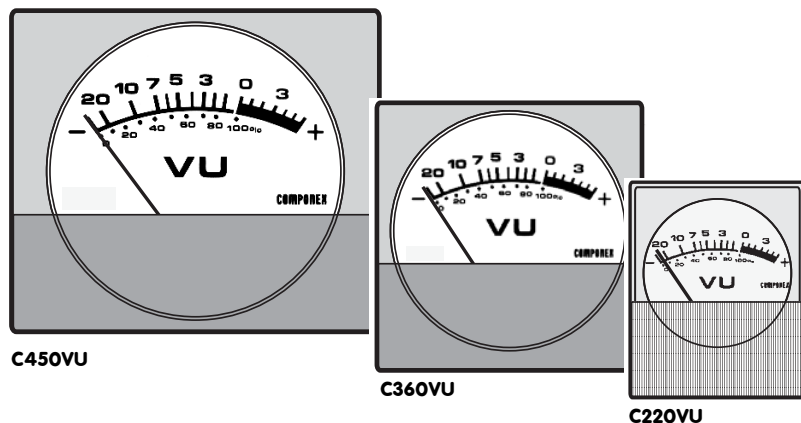

- Circular window
- Professional appearance
- Low cost solution
- Easy to back light
- Minimum depth
- Retro-fit look
- Ex-stock availability

These "retro-style" meters are robust, low-cost, back-of-panel circular Vu moving coil indicators. They can be illuminated by placing a bulb behind the translucent scale. The meters are mounted through a single circular hole.

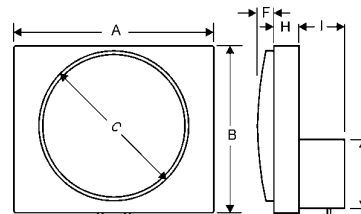

Order Code	Sensitivity ±20%	Resistance ±15%	0 Vu	Internal illumination	Rec. Price £:					
					1+	5+	10+	25+	50+	100+
C220VU	0-200 $\mu$ A	650 $\Omega$	130 $\mu$ A	no						
C360VU	0-200 $\mu$ A	650 $\Omega$	130 $\mu$ A	no						
C450VU	0-200 $\mu$ A	650 $\Omega$	130 $\mu$ A	no						

Dimensions mm	A	B	C	D	F	H	I
C220VU	26.00	32.00	22.00	18.00	1.50	8.00	14.00
C360VU	40.00	40.00	35.80	20.00	5.00	8.00	12.50
C450VU	55.00	47.50	44.80	18.50	5.00	8.00	14.00

AVAILABLE FROM: NATIONAL DISTRIBUTORS OR DIRECT FROM ANDERS IN MULTIPLES OF 10 PCS AND SUBJECT TO A MOQ OF 50 PCS.

CMMP5B/Revision 5 03/06/04

PAGE 5