

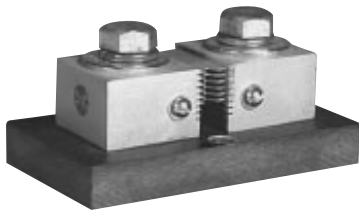

## DC Ammeter Shunts

STD Accuracy  $\pm 0.25\%$

### TYPE LC: 800 through 1200 Amperes



#### TYPE LC: 50 mV

Catalog Number	AMP	A
LC-800-50	800	2.16
LC-1000-50	1000	2.16
LC-1200-50	1200	2.16

#### TYPE LC: 100 mV

Catalog Number	AMP	A
LC-800-100	800	2.68
LC-1000-100	1000	2.68
LC-1200-100	1200	2.68

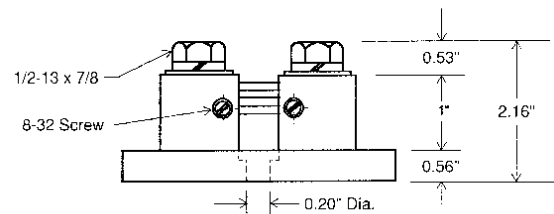
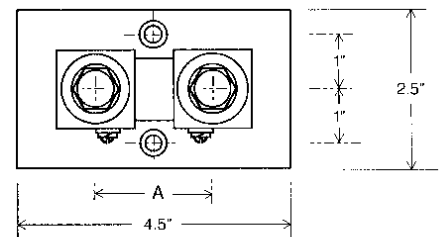

Tolerances  $\pm .015$  for the hole diameters. Other tolerances  $\pm .030$  unless specified.  
Dimensions subject to change without notice.