

Front view and mounting

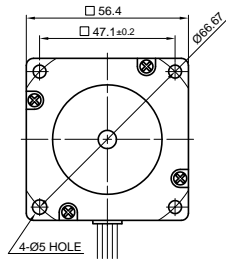

Side view

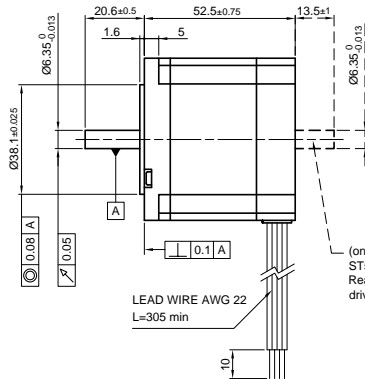

Rear view

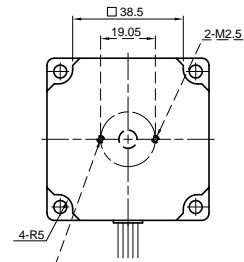

SPECIFICATION	CONNECTION	BIPOLAR	
		UNIPOLAR OR BIPOLAR-1 WINDING	PARALLEL
VOLTAGE (VDC)	6.0		
AMPS/PHASE	1.2	0.85	1.7
RESISTANCE/PHASE (Ohms)@25°C	5.0±15%	10±15%	2.5±15%
INDUCTANCE/PHASE (mH) @1KHz	11.6±20%	46.4±20%	11.6±20%
HOLDING TORQUE (Nm) [lb-in]	0.75 [6.637]	1.06 [9.381]	1.06 [9.381]
DETENT TORQUE (Nm) [lb-in]	0.0225 [0.199]		
STEP ANGLE (°)	0.9		
STEP ACCURACY (NON-ACCUM)	±5%		
ROTOR INERTIA (Kg-m²) [lb-in²]	2.75x10 <sup>-5</sup> [0.094]		
WEIGHT (Kg) [lb]	0.65 [1.433]		
TEMPERATURE RISE: MAX.80°C (MOTOR STANDSTILL; FOR 2 PHASE ENERGIZED)			
AMBIENT TEMPERATURE -10°~ 50°C [14°F ~ 122°F]			
INSULATION RESISTANCE 100 MOhm (UNDER NORMAL TEMPERATURE AND HUMIDITY)			
INSULATION CLASS B 130° [266°F]			
DIELECTRIC STRENGTH 500VAC FOR 1 MIN. (BETWEEN THE MOTOR COILS AND THE MOTOR CASE)			
AMBIENT HUMIDITY MAX. 85% (NO CONDENSATION)			

PERMISSIBLE RADIAL+AXIAL FORCE

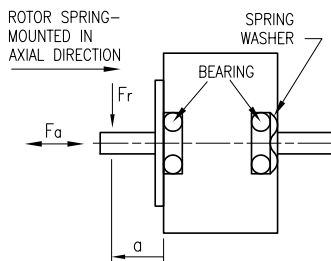

	AXIAL-FORCE Fa (N)	
	Fa=10	
DISTANCE a (mm)	5	10 15 20
RADIAL-FORCE Fr (N)	130	90 70 52
	AXIAL	RADIAL
SHAFT PLAY (mm)	0.075	0.025
AT LOAD MAX: (N)	10	5.0

UNIPOLAR	TYPE OF CONNECTION (EXTERN)			MOTOR	
	1WINDING	BIPOLAR SERIAL	PARALLEL	LEADS	WINDING
A	A	A	A	RED	A
COM				RED/WHT	
A\		A\	A\	BLK/WHT	A\
B	B	B	B	BLK	B
COM				GRN	
B\		B\	B\	GRN/WHT	B\
				YEL/WHT	
				YEL	

FULL STEP 2 PHASE-Ex., WHEN FACING MOUNTING END (X)

STEP	A	B	A\	B\	
1	+	+	-	-	CCW
2	-	+	+	-	
3	-	-	+	+	
4	+	-	-	+	CW

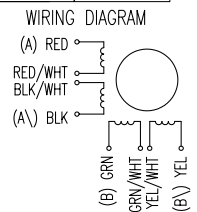

REV	DESCRIPTION	DATE	APVD	NANOTEC:	SCALE	FREE	APVD	S.H.a.	15.01.07	STEPPING MOTOR
				ST5709S1208	X	±0.5	CHKD	J.W.	05.07.06	DWG.NO
					1PL	±0.2	DRN			ST5709S1208
					2PL	±0.1	SIGNATURE			
					ANGLE	±30'				