

D.C. direct drive motors Ø 63 mm

- For low-speed drive applications
- Maximum usable power: 33 W
- Ø 63 mm : With 2 ball bearings
Supply connection by 2 leads

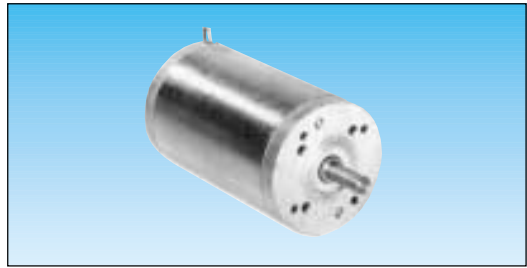

Applications

- Automatic swimming-pool cleaners
- Filtering systems
- Water circulators for whirlpool baths
- Paper drives for photocopiers
- Opening/closing of automatic doors
- Machines for making spectacle lenses

Made to order products, available on request

- other supply voltages
- shaft lengths at front and/or rear
- integrated interference suppression (82 830)
- shaft encoders
- other front and rear fixing plates
- short version possible (L = 90 mm)

Type

82 830 0

Nominal voltage

12 V

Part number

82 830 009

Standard Characteristics

Speed	rpm	2100
Absorbed power	W	4.8
Absorbed current	A	0.4

Characteristics - nominal

Speed	rpm	1500
Torque	mN.m	172
Output power	W	27
Absorbed power	W	43
Absorbed current	A	3.6
Gearbox case temperature rise	°C	50
Efficiency	%	62

General characteristics

Insulation class (conforming to IEC 85)		F (155 °C)
Degree of protection (IEC 529)		IP20
Maximum usable power	W	33
Start torque	mN.m	600
Start current	A	12
Resistance	Ω	1
Resistance : inductive	mH	1.4
Torque constant	Nm/A	0.0517
Electrical time constant	ms	1.4
Mechanical time constant	ms	19
Thermal time constant	min	37
Inertia	g.cm ²	514
Weight	g	840
No of segments		12
Life	h	5000
Ball bearings		yes
Lead length	mm	200

- A - Torque/Speed curves
- B - Torque/Current curves

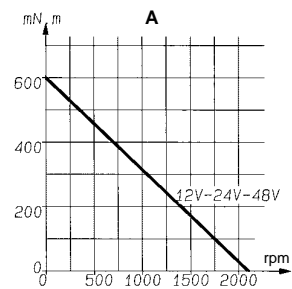

Other information

Basic principles see page 1/5.

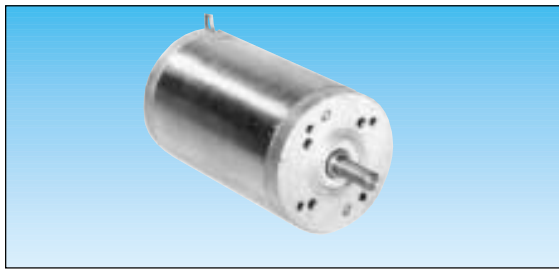

82 830 0	82 830 0
24 V	48 V
82 830 010	●
2100	2100
4.8	4.8
0.2	0.1
1500	1500
172	172
27	27
45	43
1.9	0.9
50	50
60	62

F (155 °C)	F (155 °C)
IP20	IP20
33	33
600	600
6.2	3
3.9	16
6.4	26.3
0.1	0.2069
1.64	1.64
19	30
37	37
492	496
840	840
12	12
5000	5000
yes	yes
200	200

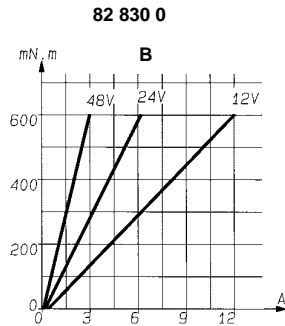

- 1
- 2
- 3

Dimensions

82 830 0

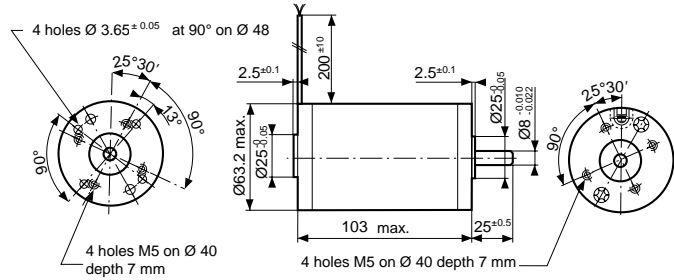

To order, specify :

<p>Standard products</p> <p>● Standard products, non stocked</p>	<p>3 Part number Example : D.C. direct drive motor - 82 830 009</p> <p>1 Type Example : D.C. direct drive motor - 82 830 0 - 48 V</p> <p>2 Nominal voltage Example : D.C. direct drive motor - 82 830 0 - 48 V</p>
--	---